



BAMBU LAB P2S DRAWER

BAMBU LAB P2S DRAWER

DO YOU OWN A BAMBU LAB P2S AND WANT TO TURN IT FROM "JUST A PRINTER" INTO A COMPLETE WORKSTATION?

SAY HELLO TO THE BAMBU LAB P2S DRAWER, DESIGNED TO BRING ORDER, FUNCTIONALITY, AND PERSONALITY TO YOUR SETUP.

WHAT'S INCLUDED:

- **POOP DRAWER**

THE PERFECT PLACE TO COLLECT ALL THAT FILAMENT "POOP." NO MORE DEBRIS SCATTERED UNDER YOUR PRINTER.

- **POOP CHUTE**

WHEN THE DRAWER IS FULL, EMPTY IT IN SECONDS. CLEAN, SIMPLE, FAST.

- **TOOL DRAWER**

AVAILABLE IN TWO CONFIGURATIONS:

- CUSTOM STORAGE BINS
- GRIDFINITY 42MM COMPATIBLE FOR YOUR EXISTING ORGANIZERS

- **DEDICATED HOTEND BOX**

A SPECIFIC COMPARTMENT DESIGNED TO STORE YOUR HOTENDS SAFELY AND NEATLY.

- **INTEGRATED BUILD PLATE HOLDERS**

THE HOLDERS ARE BUILT INTO THE STRUCTURE: SOLID, FUNCTIONAL, AND WITH NO EXTRA ACCESSORIES REQUIRED.

- **INTEGRATED DRAWER GUIDES**

A CLEAN AND ROBUST SYSTEM WITH NO ADDITIONAL COMPONENTS TO INSTALL. OPTIMIZED DESIGN TO MINIMIZE SCREWS AND EXTRA PARTS. FASTER AND MORE INTUITIVE ASSEMBLY.

- **TWO-TONE STRUCTURE WITH CUSTOMIZABLE SIDE INSERTS**

CONFIGURE THE LOOK TO MATCH YOUR STYLE.

- **TWO DIFFERENT DRAWER FRONT OPTIONS:**

- SMOOTH, MINIMAL VERSION
- BAMBOO-STYLE VERSION FOR A MATCHING FACTORY LOOK

- **LED STRIP INTEGRATION**

OPTION TO LIGHT UP THE DRAWERS OR DISPLAY PRINTER STATUS ON THE FRONT.

HULA FEET COMPATIBLE

IF YOU CHOOSE TO USE THEM, YOU CAN DO SO FREELY; HULA FEET ARE NOT INCLUDED IN THE PROJECT.

KEY CARATERISTICS

BAMBU LAB P2S DRAWER

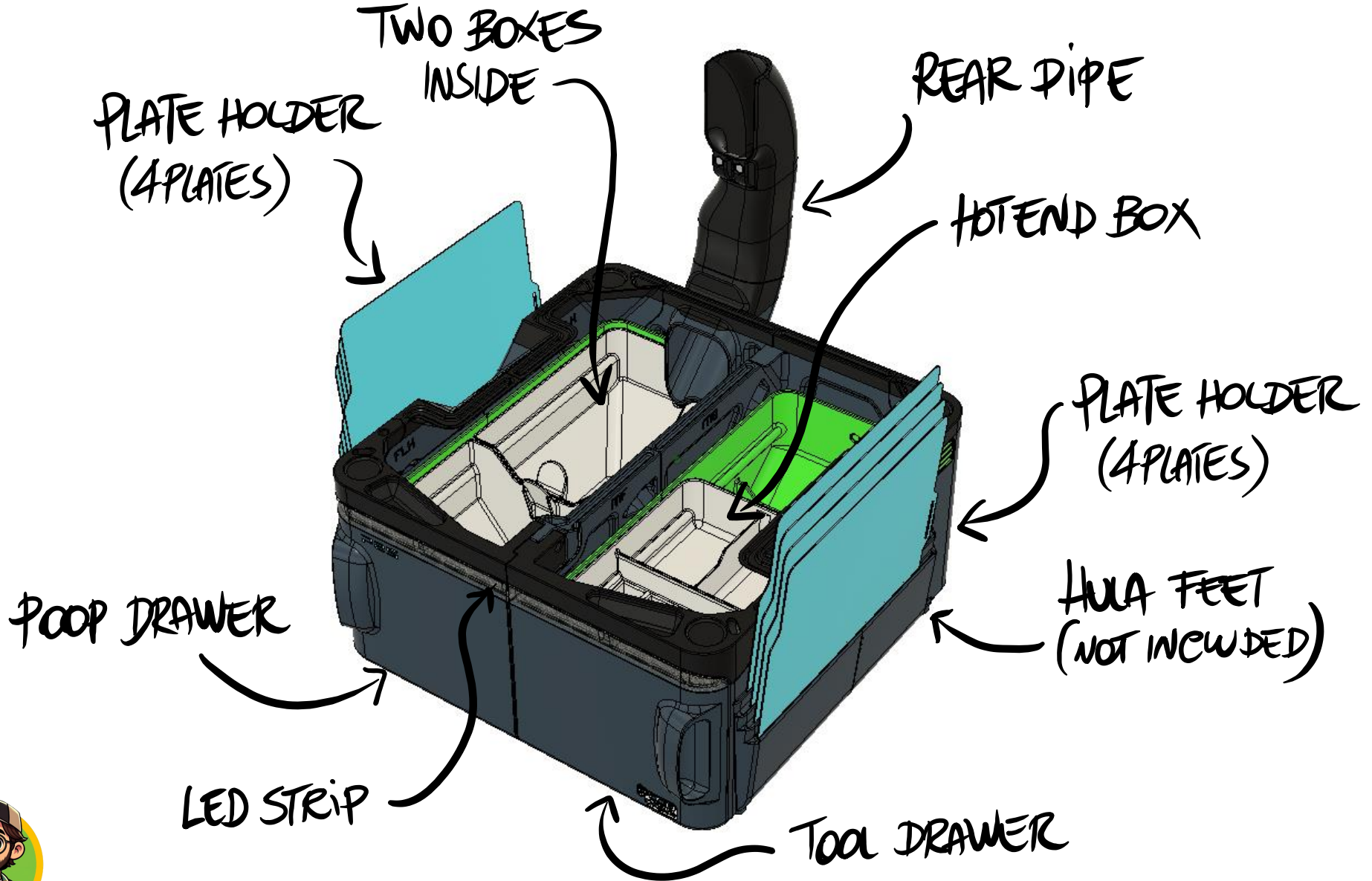

ALL MATERIAL PRODUCED AND PROVIDED HAS BEEN CONCEIVED, AUTHORED AND PRODUCED BY ENRICO MAZZAROLI - ALL RIGHTS RESERVED.



TWO DIFFERENT FRONT

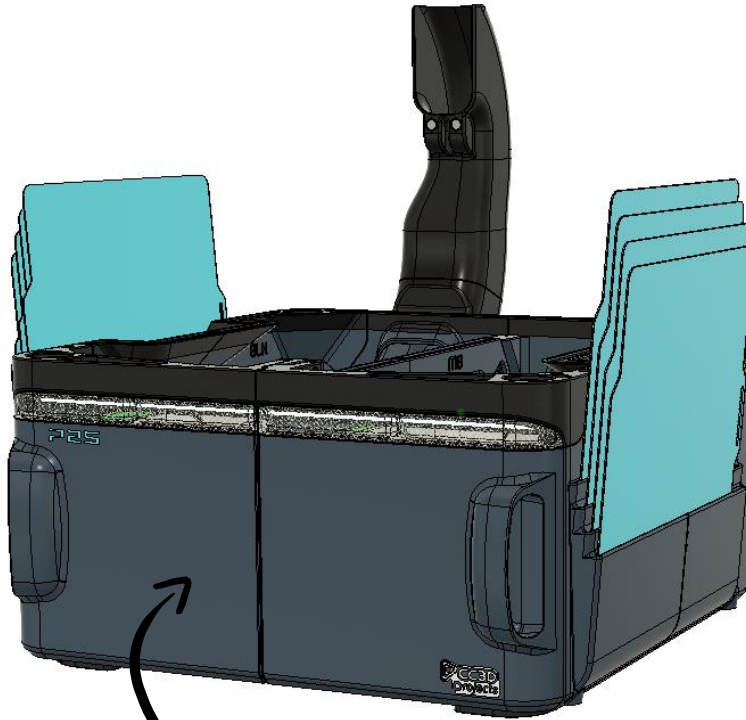

SMOOTH FRONT
PANEL



BAMBOO-STYLE FRONT
PANEL



KEY CHARACTERISTICS

BAMBU LAB P2S DRAWER

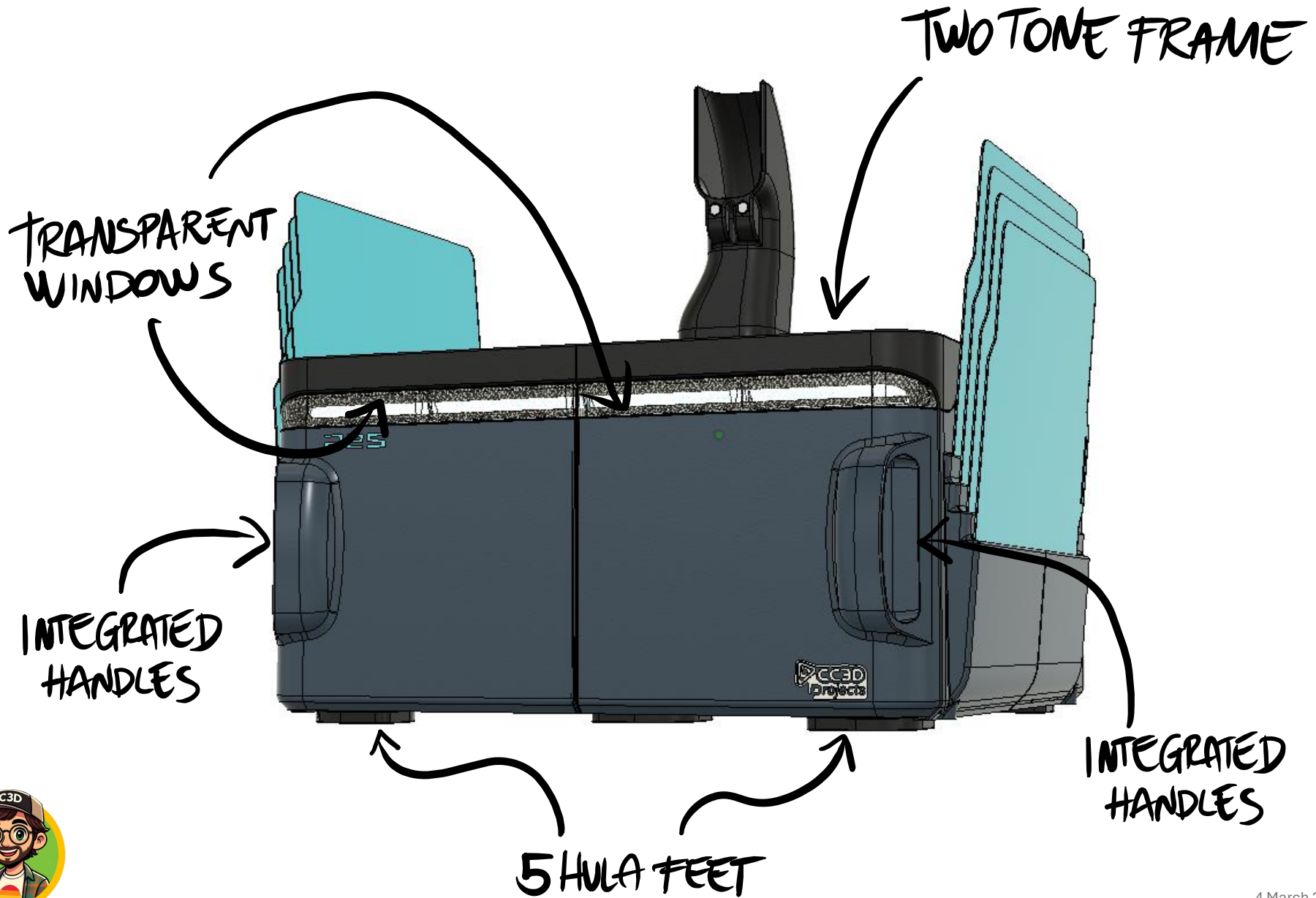

TWO DIFFERENT TOOL DRAWERS

HOT END BOX

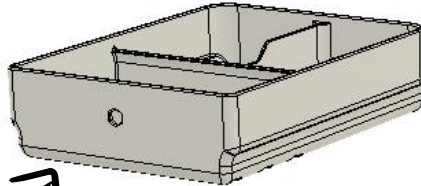

HOT END BOX

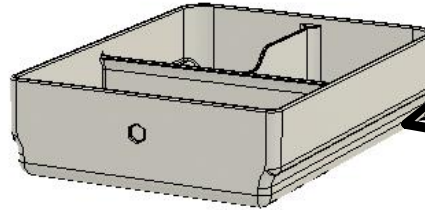
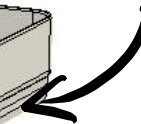

STANDARD OPTION DRAWER

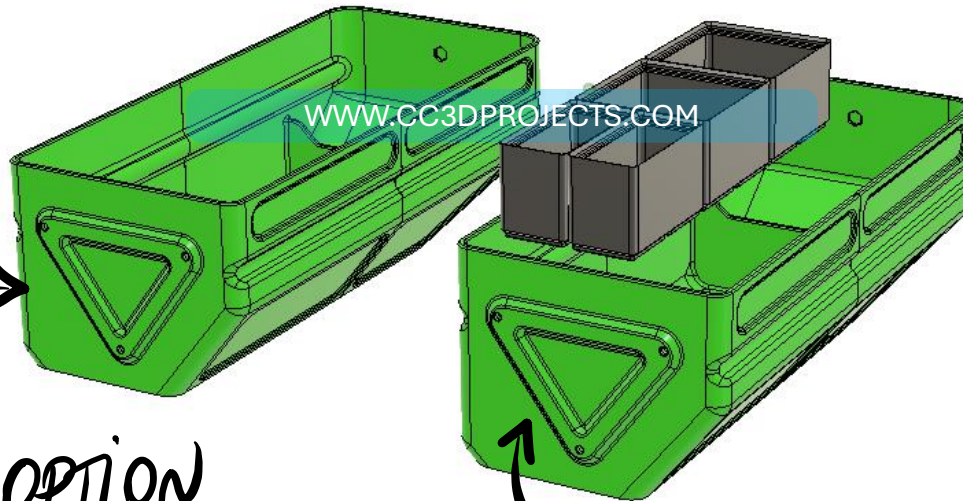
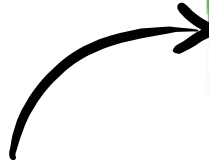

GRIDFINITY SYSTEM 42mm
(GRIDFINITY DRAWER IT'S A FREE OPTION)

IF YOU PREFER GRIDFINITY (FREE OPTION), YOU CAN USE THE INCLUDED BOXES OR YOU CAN DESIGN YOUR OWN DOWNLOADING FROM FREE PLATFORMS OR USING THE GRIDFINITY ONLINE CONFIGURATOR

HERE THE LINK ↴

<https://gridfinitygenerator.com/en/baseplate>



THE DRAWER FRONTS HAVE
A CLEAR TOP SECTION
AS YOU SEE INSIDE THERE IS
A SPACE TO ADD AN LED STRIP
WHICH LIGHTS UP BOTH
DRAWERS AND THE FRONTS

CLEAR SECTION

LED STRIP

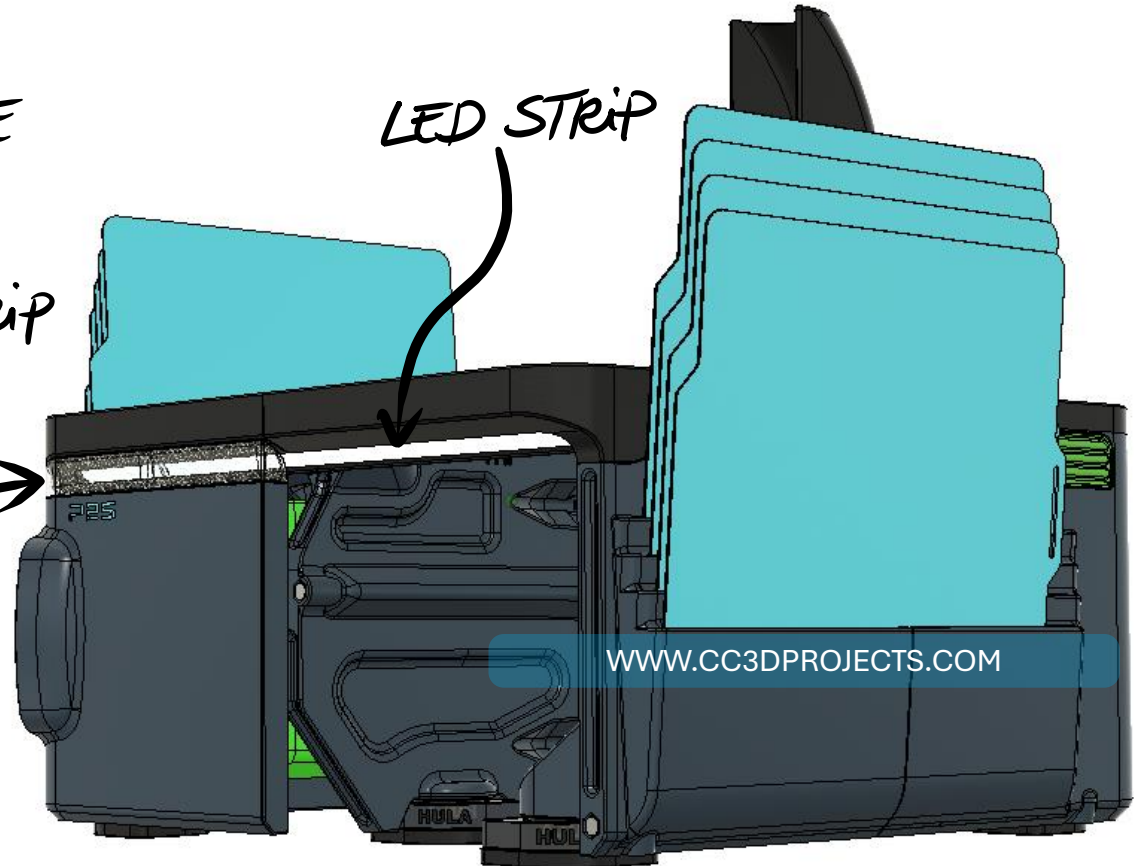

WWW.CC3DPROJECTS.COM



FILAMENT NEEDED :

FRAME

PETG PETG PETG PETG PETG

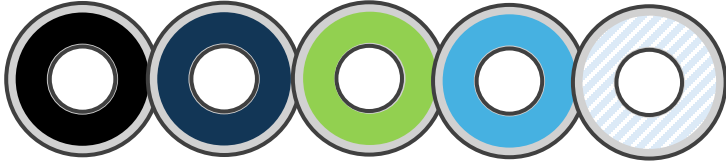

348G 1,96Kg 32G 43G 18G

PRINT TIME
2D 12H 42M

POOP DRAWER - STANDARD TOOL DRAWER

PETG PETG

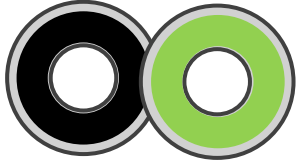

549G 770G

PRINT TIME
18H 49M

POOP DRAWER - GRID FINITY TOOL DRAWER

PETG PETG

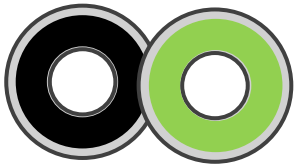

681G 766G

PRINT TIME
21H 20M

B.O.M.

REQUIRED HARDWARE:



SCREW M4 x 14mm 25 units



MAGNET 8x2mm 14 units

LED STRIP 1 unit

HULA FEET 5 units
(BAMBU LAB X1C-SPEE.)

- OR -

SILICONE FEET 9 units



DRAWER CHASSIS & DRAWER FRONTS

FILAMENT	32. ⁰⁰ €
SCREWS	1. ⁹⁰ €
MAGNETS	1. ⁶⁰ €

POOP DRAWER & TOOL STD DRAWER

FILAMENT	17. ⁰⁰ €
SCREWS	0. ⁶⁰ €
MAGNETS	0. ⁸⁰ €

POOP DRAWER & TOOL GRIDFINITY DRAWER

FILAMENT	18. ⁰⁰ €
SCREWS	0. ⁶⁰ €
MAGNETS	0. ⁸⁰ €

OR



THE FILAMENT COST USED FOR THESE CALCULATION IS 15 € PER KG.

ALL PRICES FOR FILAMENT AND HARDWARE ARE ON THE EUROPEAN MARKET.



FOLLOW THESE SIMPLE TIPS AND YOU'RE GOLDEN:

1. STICK WITH REGULAR PETG

USE STANDARD PETG, AND SKIP THE HIGH FLOW (HF) STUFF. HF MIGHT SOUND COOL, BUT IT CAN'T HANDLE HEAT AS WELL, AND THAT CAN MESS WITH YOUR PRINT'S DURABILITY. YEAH, REGULAR PETG IS SHINIER — I GET IT — BUT HERE'S A TRICK: SPRAY IT WITH A MATTE CLEAR COAT LIKE I DID. BOOM! PROBLEM SOLVED.

2. DON'T USE PLA FOR SUPPORTS

IF YOU ARE USING A SINGLE NOZZLE PRINTER WITH A COLOR CHANGE SYSTEM, VOID USING PLA AS SUPPORT MATERIAL. SERIOUSLY. EVEN IF YOU SWITCH FILAMENTS, LEFTOVER PLA IN THE NOZZLE CAN MESS WITH LAYER ADHESION, AND THAT'S NO FUN. AND DON'T STRESS — THE SUPPORTS COME OFF EASY, I PROMISE. **YOU GOT THIS.**

3. KEEP IT SLOW AND STEADY

RESIST THE URGE TO CRANK UP THE PRINT SPEED. GOING TOO FAST CAN LEAD TO WEIRD-LOOKING CORNERS AND WARPED PARTS. STICK TO STANDARD SPEED — YOUR PRINT WILL THANK YOU.

WWW.CC3DPROJECTS.COM

4. USE A GRIPPY PRINT BED

THESE PARTS ARE ON THE BIGGER SIDE, SO BED ADHESION IS EVERYTHING. MAKE SURE YOUR BUILD PLATE'S GOT A GOOD GRIP TO AVOID WARPING OR LIFTING. TRUST ME, A SOLID FIRST LAYER MAKES ALL THE DIFFERENCE.

SLICER PRINT SETTINGS:

WALL LOOPS = 2
TOP SHELL = 2
BOTTOM SHELL = 2

SPARSE INFILL = 9 %
INFILL PATTERN = GYROID

SUPPORT TYPE = TREE OR NORMAL/MIXED

DIFFERENT PARTS = DIFFERENT STRENGTH

(PERIMETERS, INFILL AND SUPPORTS MIGHT VARY, HOWEVER, ALL THE PROPER CONFIGURATIONS SHOULD BE INCLUDED IN THE PRINT FILE!)



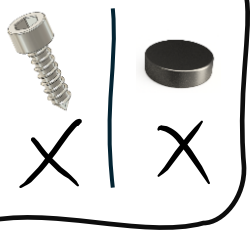

FRAME ASSEMBLY

BAMBU LAB P2S DRAWER

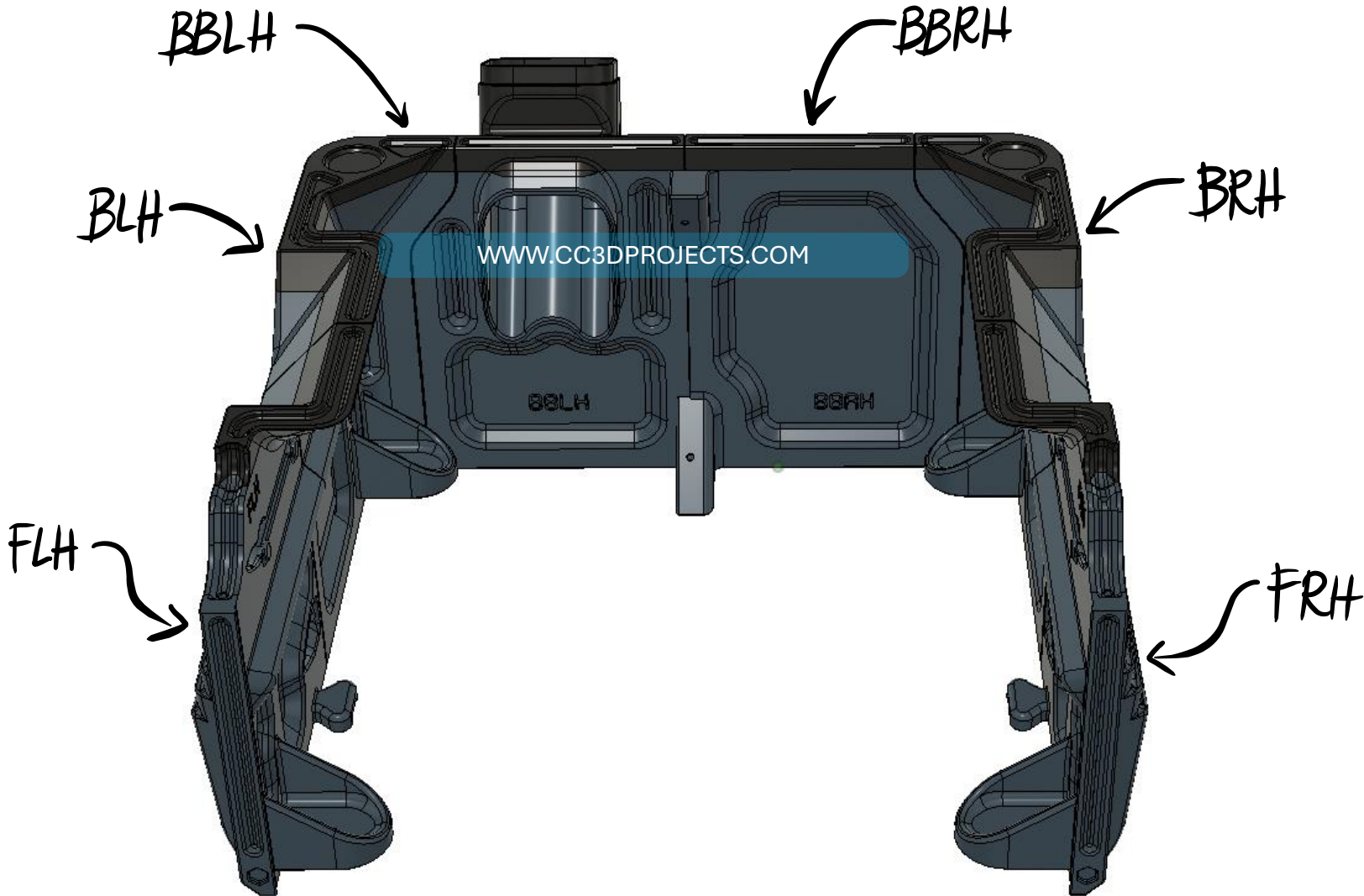

ALL MATERIAL PRODUCED AND PROVIDED HAS BEEN CONCEIVED, AUTHORED AND PRODUCED BY ENRICO MAZZAROL - ALL RIGHTS RESERVED.

FRAME ASSEMBLY

BAMBU LAB P2S DRAWER

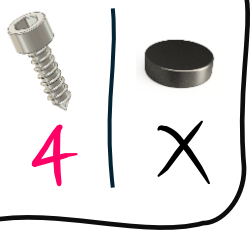

INSERT THE SCREWS INTO THE HIGHLIGHTED HOLES AND TIGHTEN THEM TO SECURE EVERYTHING IN PLACE.

INTERNAL LEFT SIDE

INTERNAL RIGHT SIDE

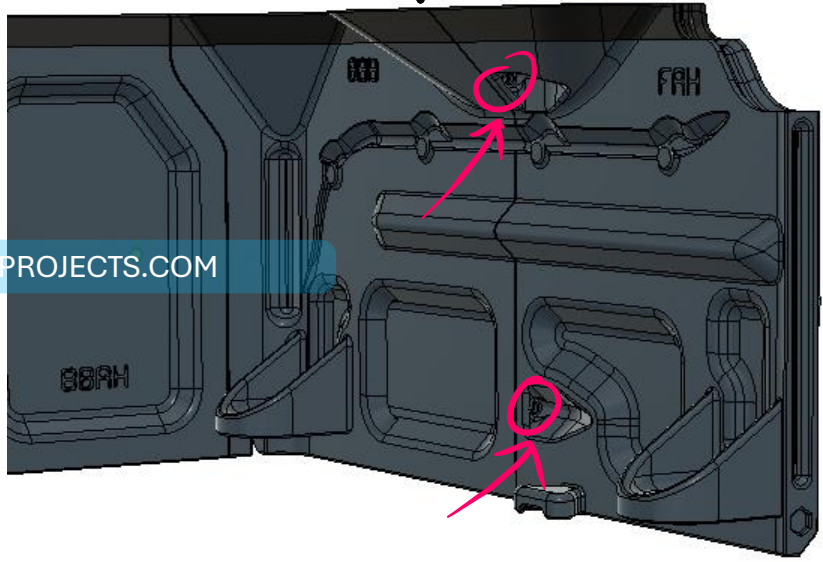
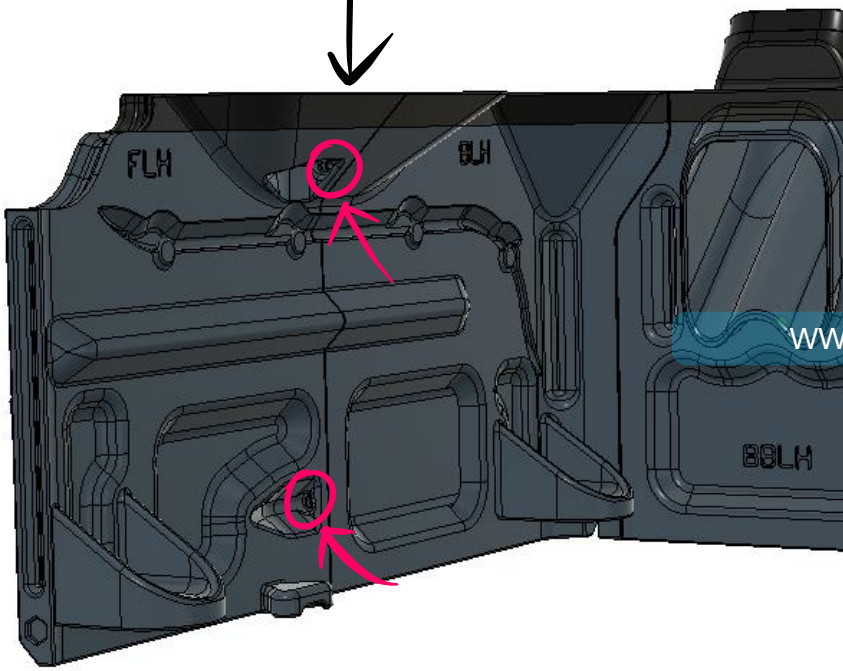

WWW.CC3DPROJECTS.COM



FRAME ASSEMBLY

BAMBU LAB P2S DRAWER

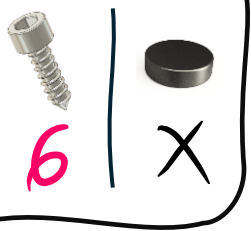

INSERT THE SCREWS INTO THE HIGHLIGHTED HOLES AND TIGHTEN THEM TO SECURE EVERYTHING IN PLACE.

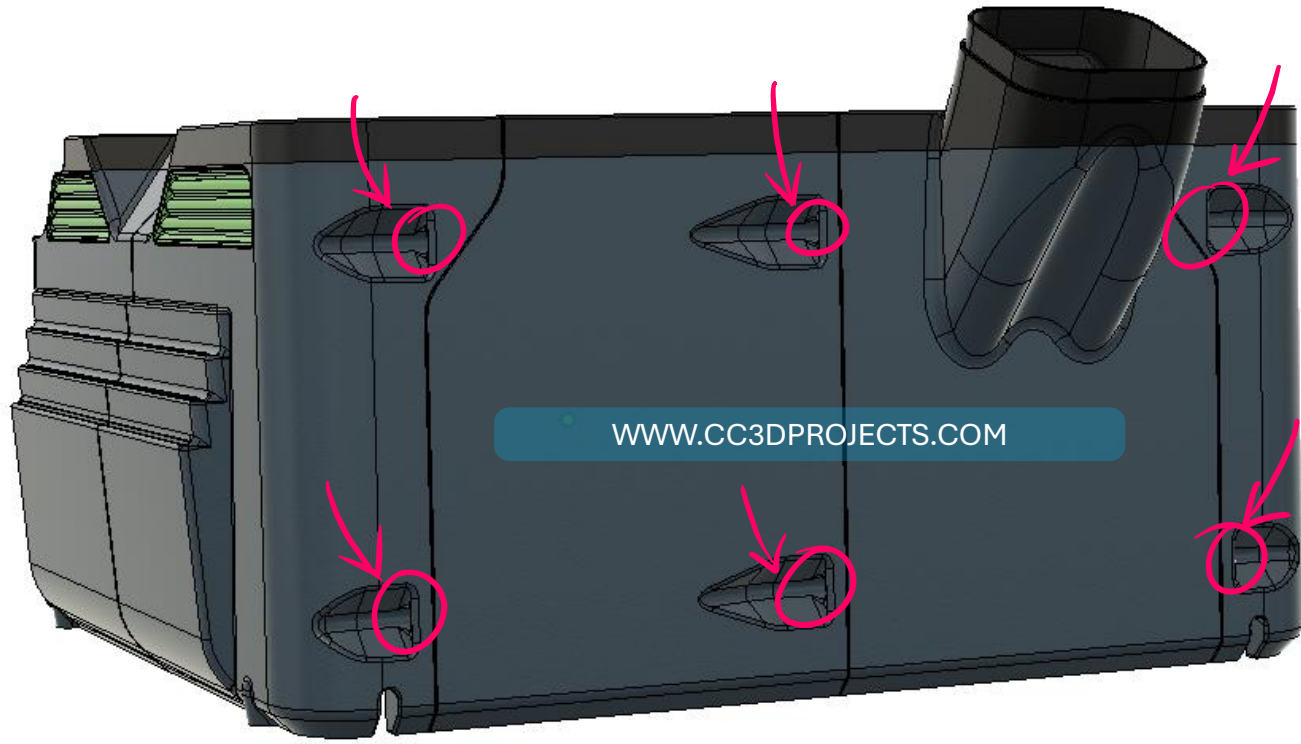

FRAME ASSEMBLY

BAMBU LAB P2S DRAWER

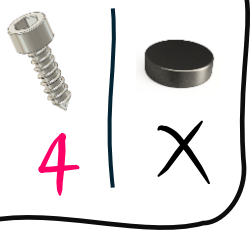

INSERT THE SCREWS INTO THE HIGHLIGHTED HOLES AND TIGHTEN THEM TO SECURE EVERYTHING IN PLACE.

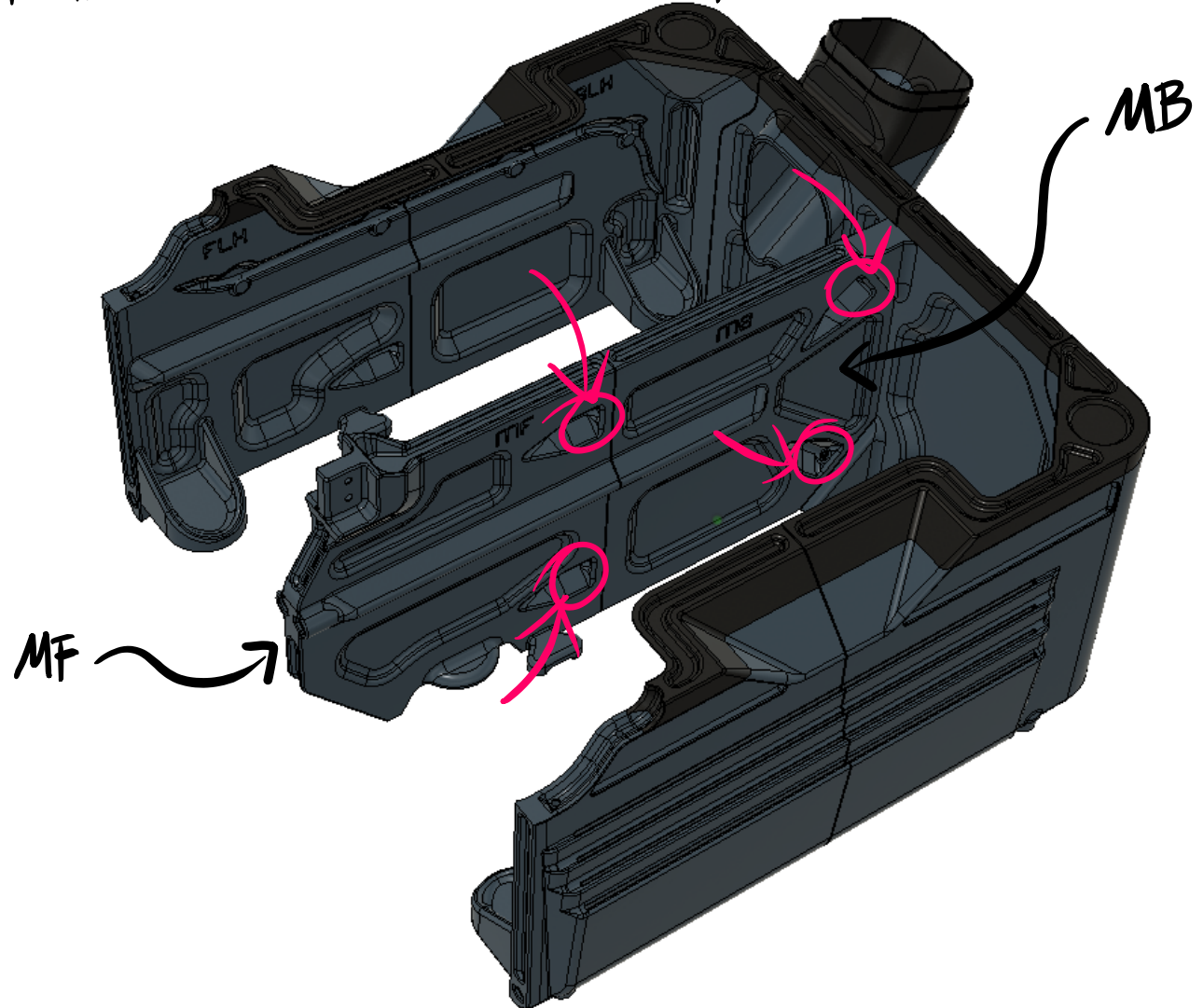

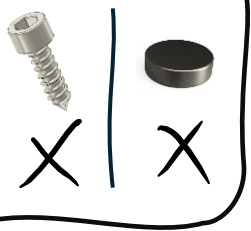

FRAME ASSEMBLY

BAMBU LAB P2S DRAWER



INSERT THE TWO GREEN REINFORCEMENTS INTO THEIR SLOTS. THEY ARE IDENTICAL IN SIZE, SO YOU CAN'T GO WRONG!

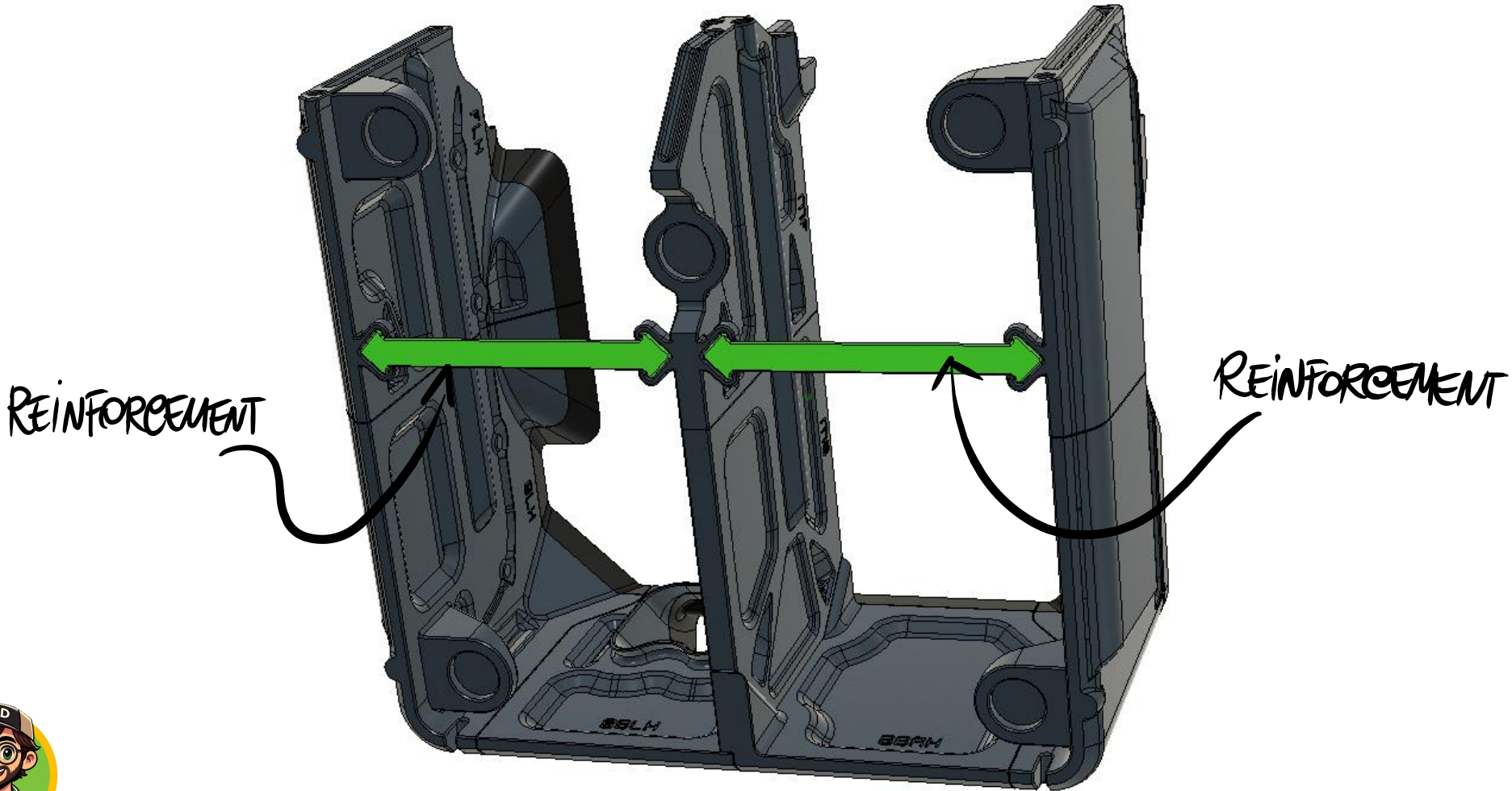



FRAME ASSEMBLY

BAMBU LAB P2S DRAWER



LET'S INSTALL THE FRONT BRIDGE

BRDGT-RH

BRDGT-LH

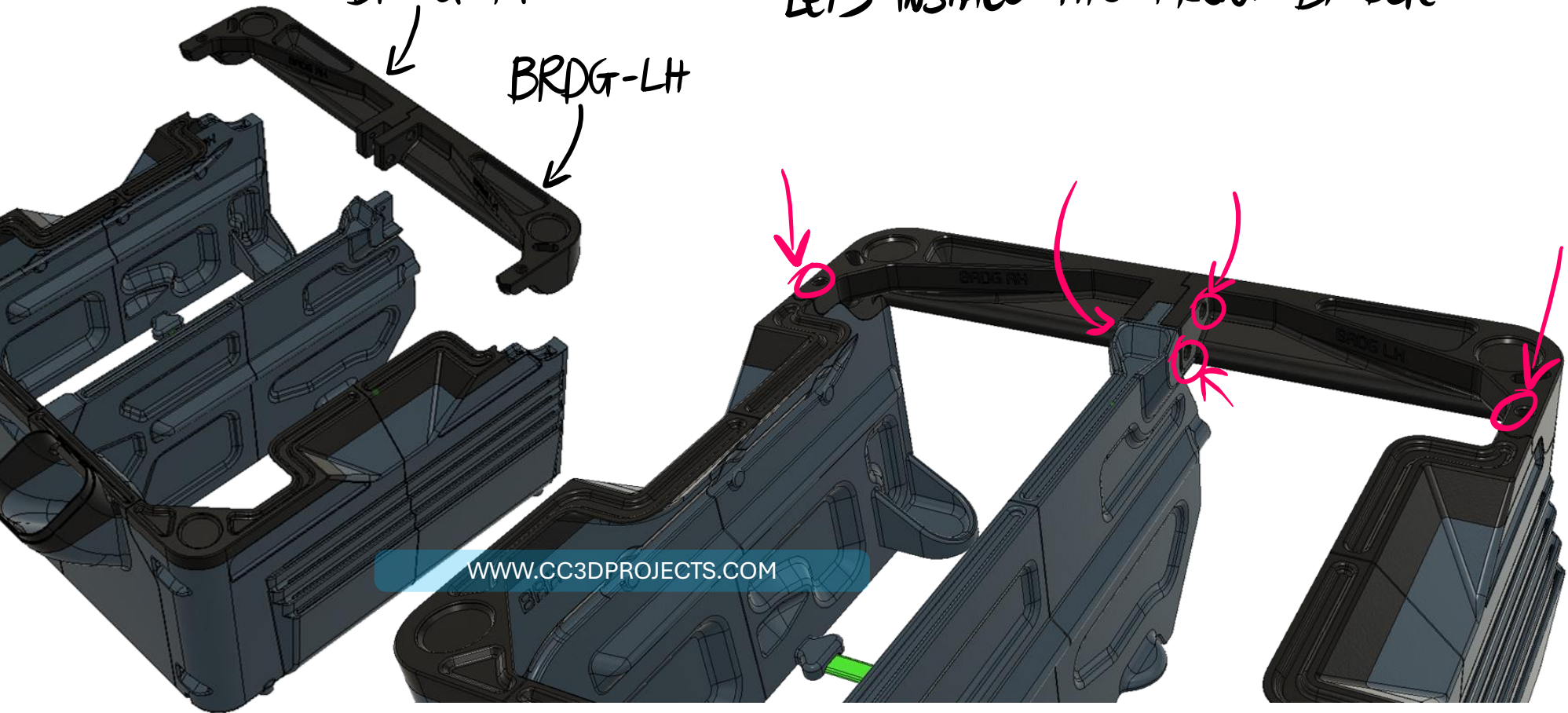

WWW.CC3DPROJECTS.COM

SLOT THE PIECES TOGETHER AND SECURE THEM WITH SCREWS USING THE HOLES MARKED IN RED.



ALL MATERIAL PRODUCED AND PROVIDED HAS BEEN CONCEIVED, AUTHORED AND PRODUCED BY ENRICO MAZZAROLI - ALL RIGHTS RESERVED.

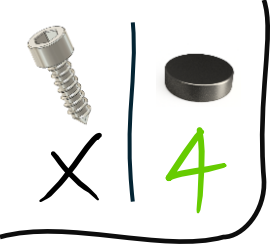

FRAME ASSEMBLY

BAMBU LAB P2S DRAWER



LET'S INSTALL THE DRAWER MAGNETS ON THE FRONT.

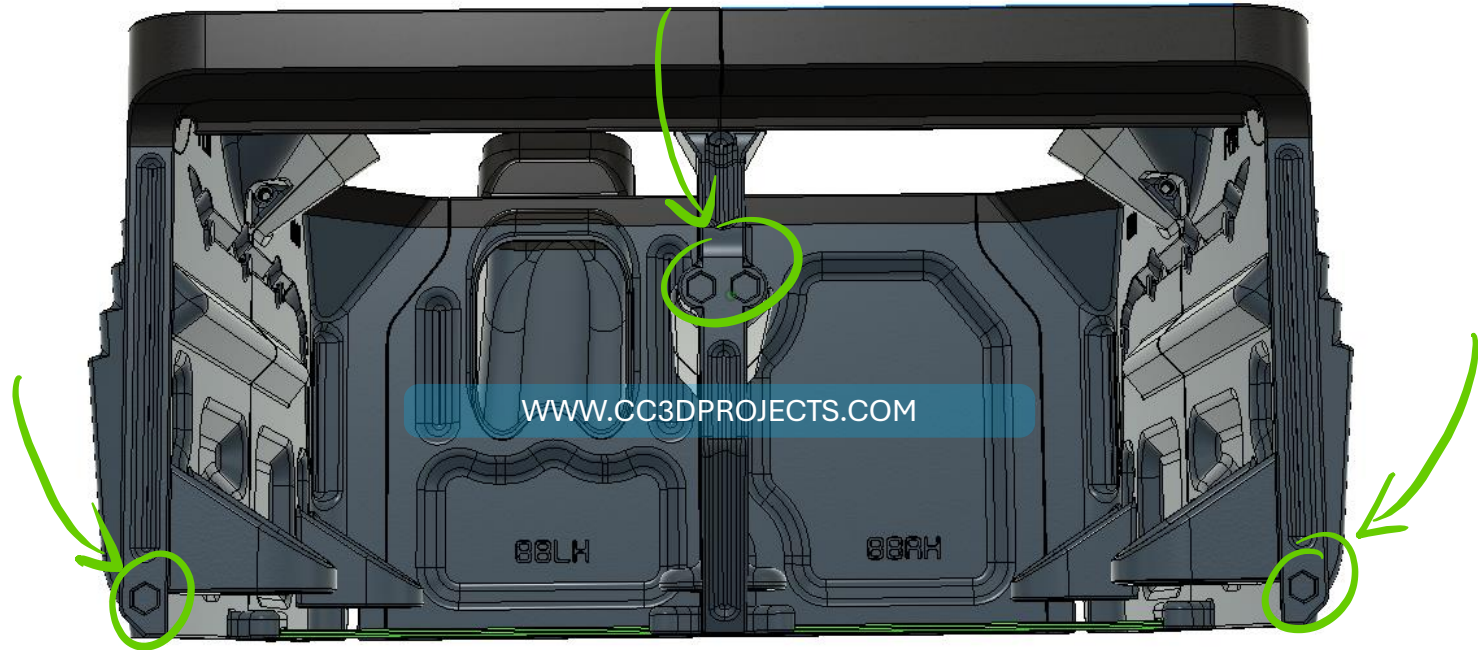

TO INSTALL THOSE MAGNETS USE THE MAGNET INSTALLER "A".
YOU'LL FIND THE MAGNET INSTALLER FOR FREE ON MY SHOP!



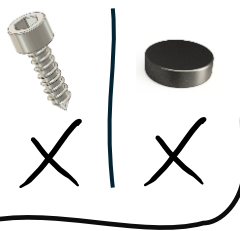

FRAME ASSEMBLY

BAMBU LAB P2S DRAWER



LET'S INSTALL THE SIDE INSERTS - YOU NEED SUPER GLUE FOR THIS!

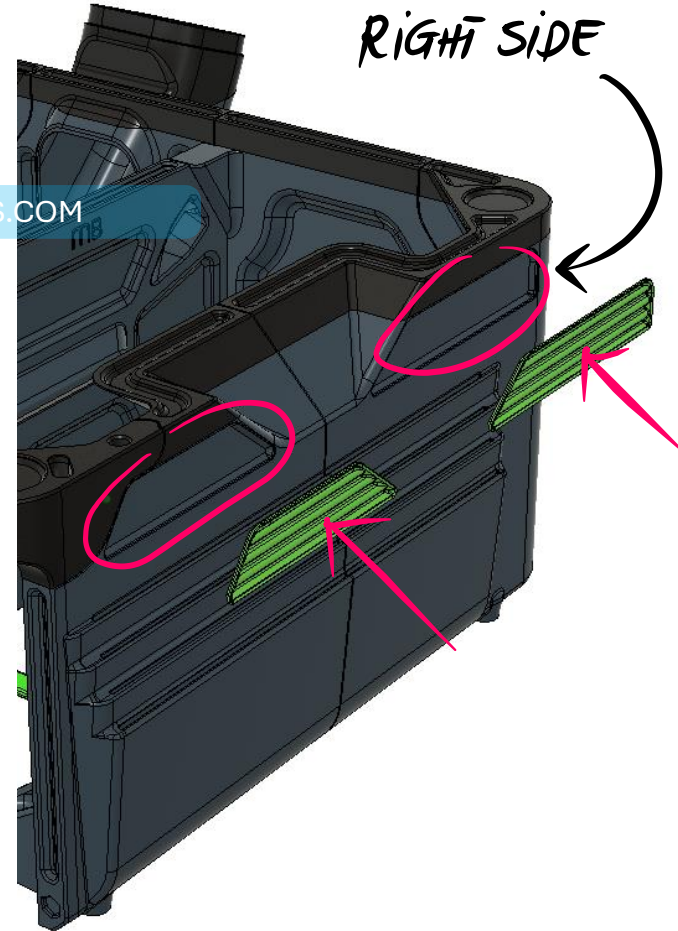
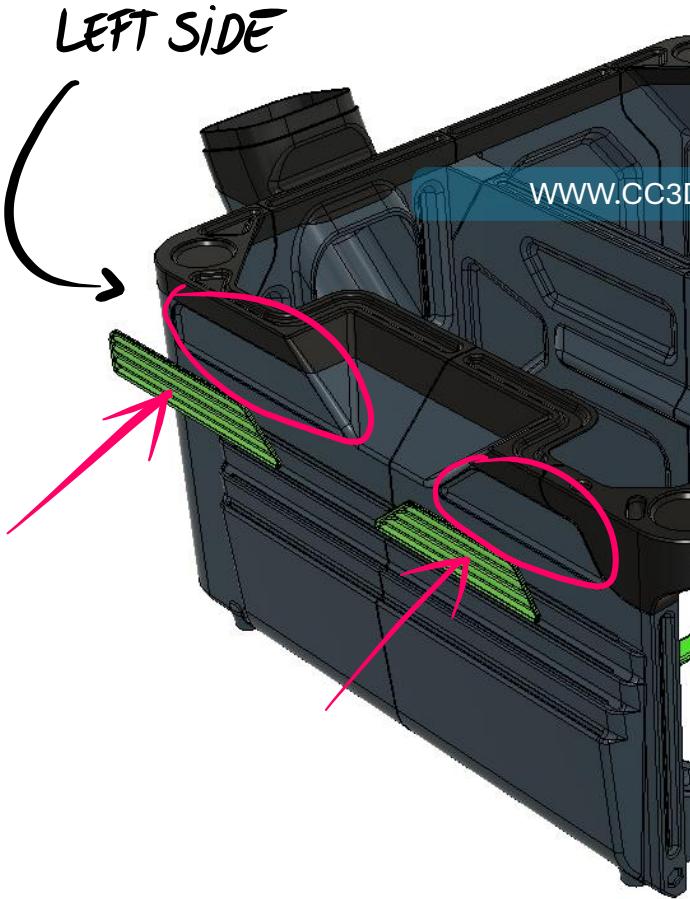

ADD A FEW DROPS OF GLUE TO THE BACK OF THE INSERTS AND STICK THEM INTO THE DEDICATED SLOTS ON THE SIDE WALLS.



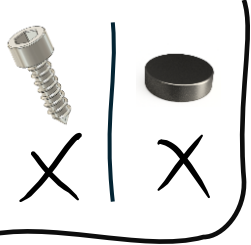

LED INSTALLATION

BAMBU LAB P2S DRAWER



THE LED STRIP INSTALLATION SHOULD BE QUITE SIMPLE

USE THE RECESS TO GIVE THE LED STRIP YOU CUT TO SIZE.

RECESS

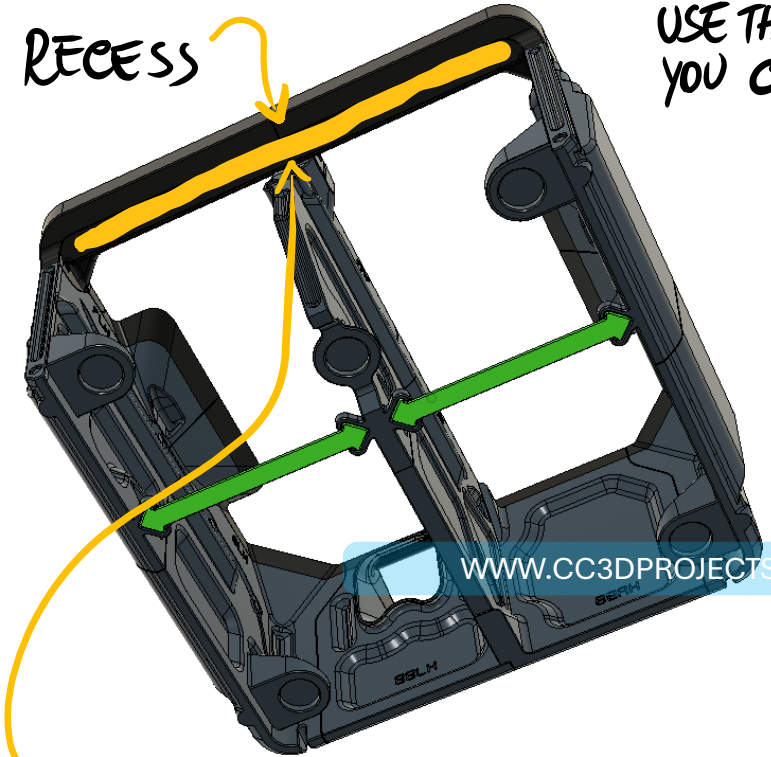

LED CABLE PATH!

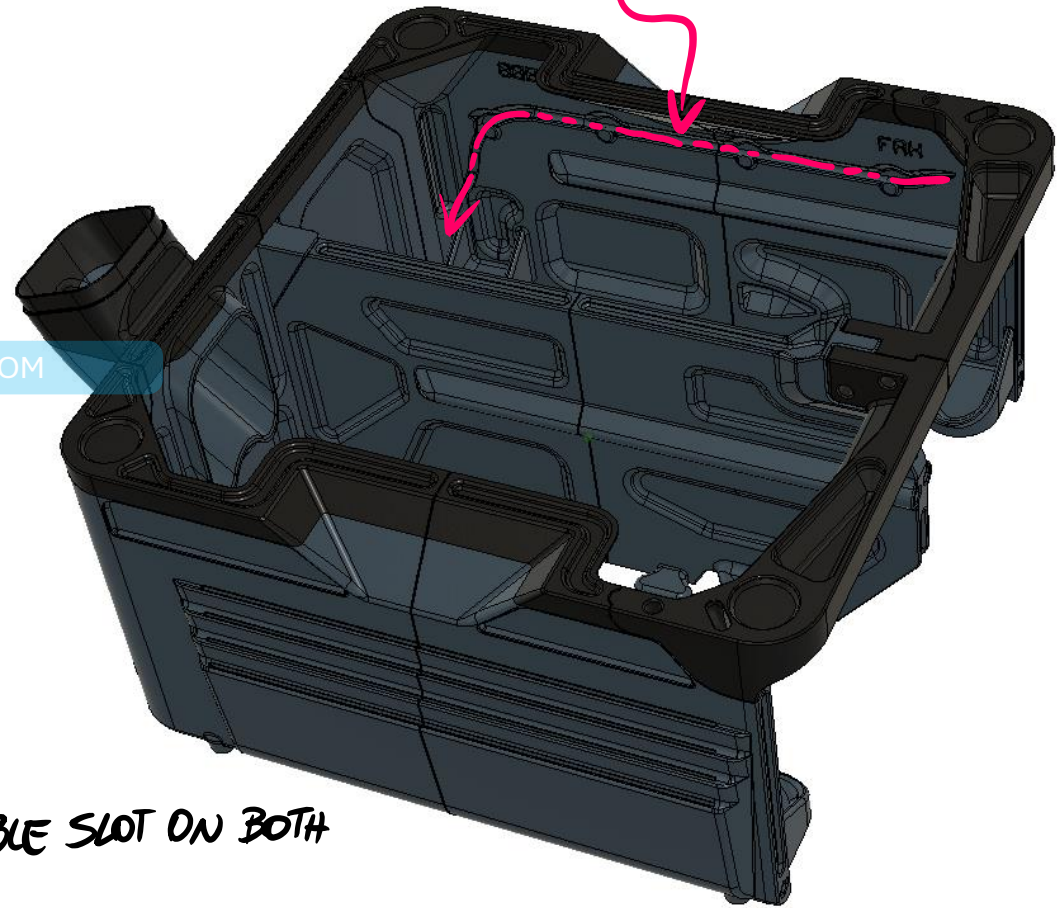

WWW.CC3DPROJECTS.COM

HERE YOU CAN PLACE YOUR LED STRIP.

YOU'LL FIND THE SAME CABLE SLOT ON BOTH SIDE OF THE DRAWER



ALL MATERIAL PRODUCED AND PROVIDED HAS BEEN CONCEIVED, AUTHORED AND PRODUCED BY ENRICO MAZZAROL - ALL RIGHTS RESERVED.

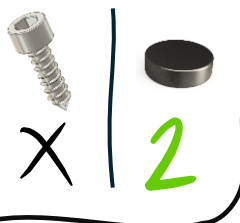

DRAWERS ASSEMBLY

BAMBU LAB P2S DRAWER



CHOOSE
THIS OR THIS

THIS TIME NO SCREWS -
ONCE YOU PICK YOUR TOOL DRAWER,
JUST GLUE THE PARTS WITH SUPER
GLUE AND YOU ARE DONE!

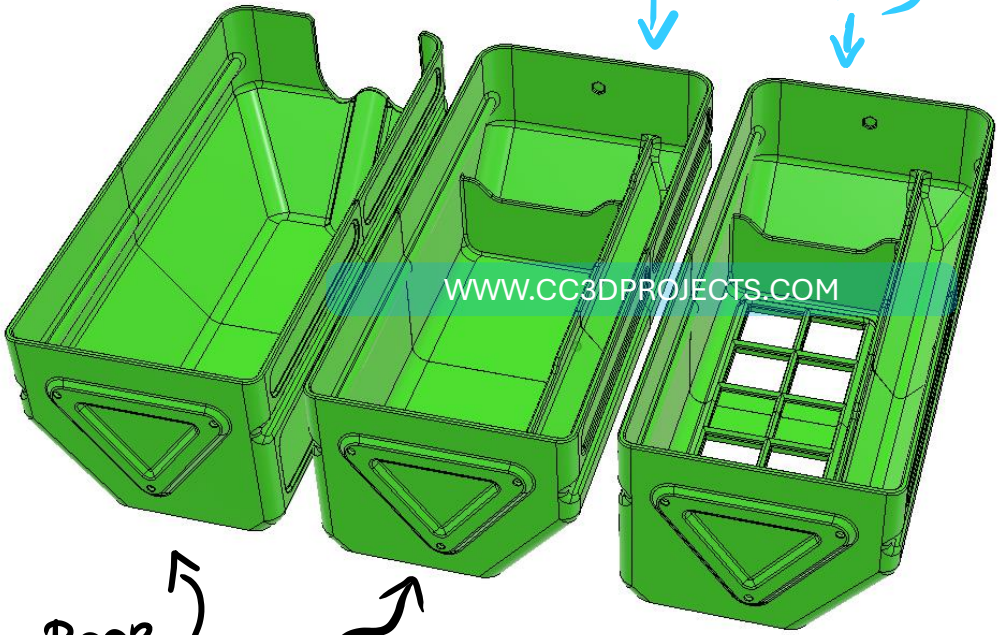

WWW.CC3DPROJECTS.COM

POOP
DRAWER

STANDARD
TOOL DRAWER

GRIDFINITY
TOOL DRAWER
*(FREE OPTION ON
MY SHOP)

INSIDE THE TOOL DRAWER YOU'LL ALSO FIND
TWO HOLES WHERE YOU SHOULD GLUE IN TWO
MAGNETS USING THE "MAGNET INSTALLER A"

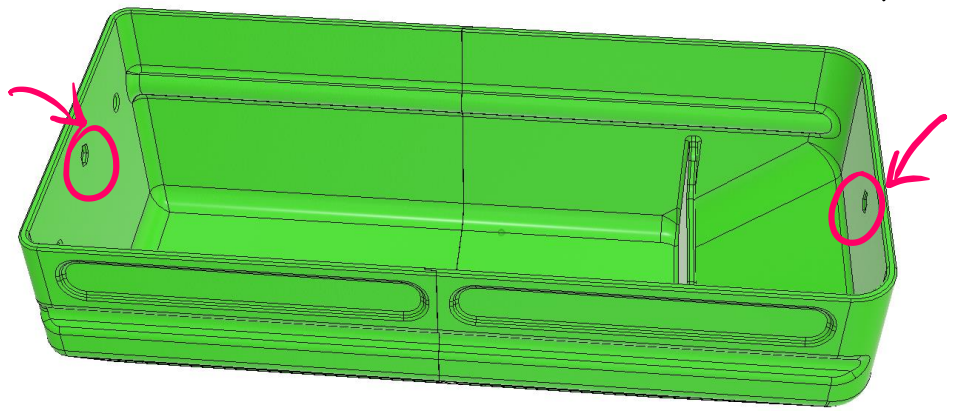

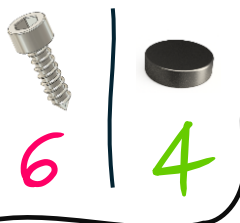

DRAWERS ASSEMBLY

BAMBU LAB P2S DRAWER



INSTALL ALSO THE MAGNETS USING THE MAGNET INSTALLER "B".
THE HOLES ARE MARKED IN GREEN.

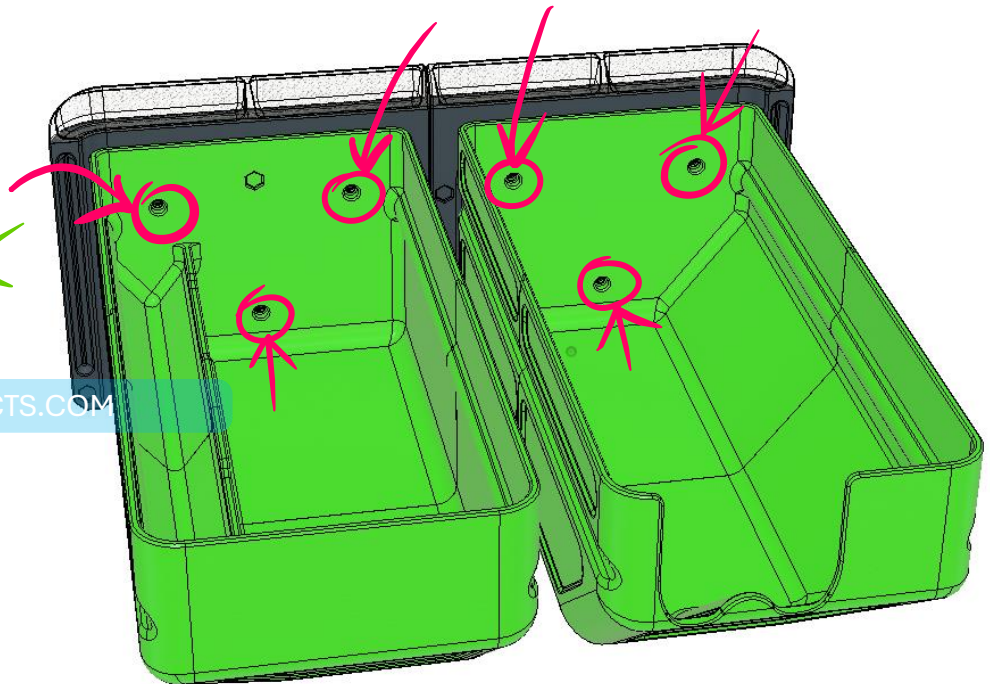
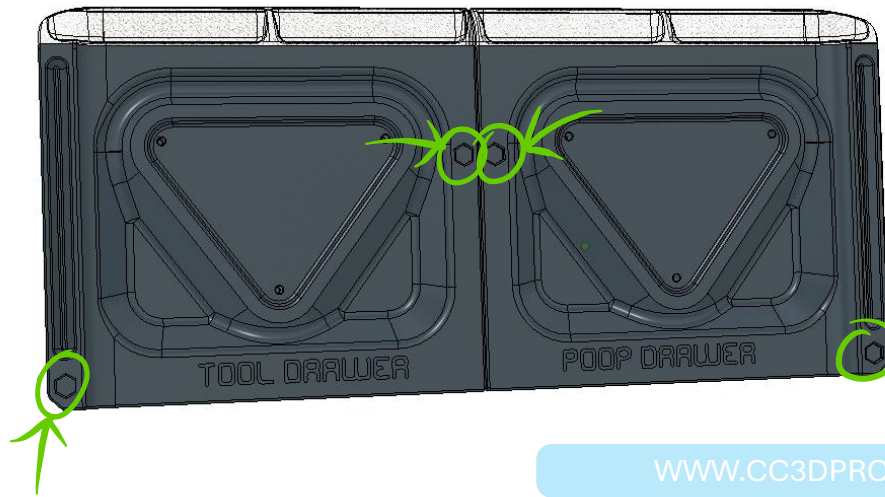

WWW.CC3DPROJECTS.COM

INSTALL THE FRONTS ON THE DRAWER
USING SCREWS INTO THE RED MARKED HOLES



DRAWERS ASSEMBLY

BAMBU LAB P2S DRAWER



NOW ATTACH THE MAGNETS TO THE HOTEND HOLDER INSERT.
YOU'LL NEED ONE FOR EACH SHORT SIDE OF THE BOX.

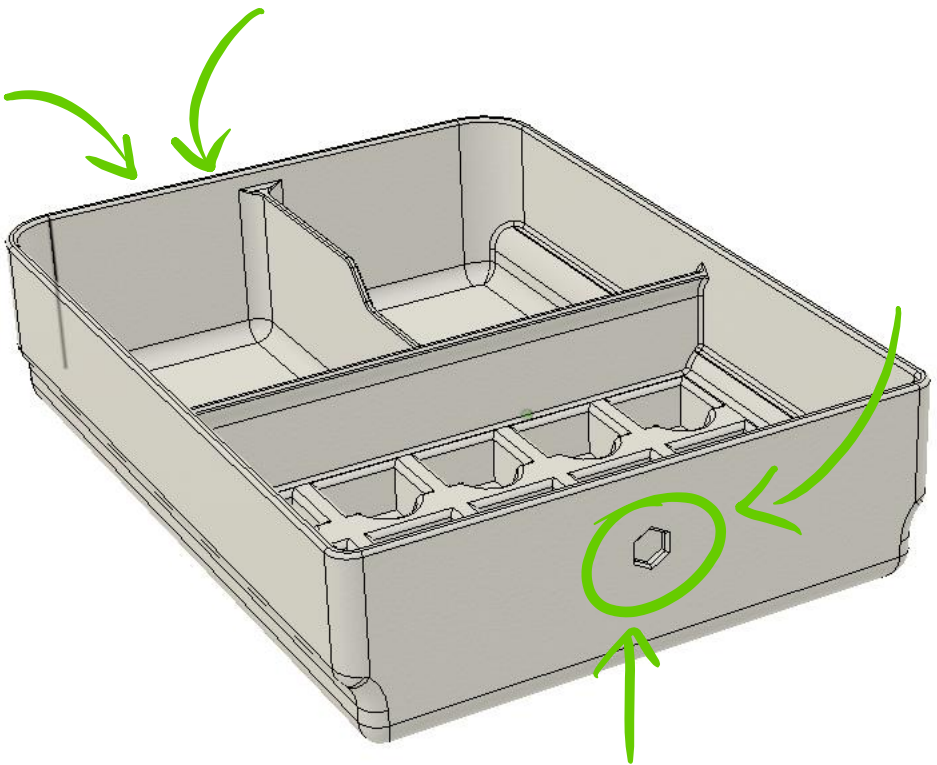

YOU'LL FIND SPACE FOR UP TO 15 HOTENDS,
PLUS A COUPLE OF EXTRA COMPARTMENTS
FOR SILICONE SOCKS.

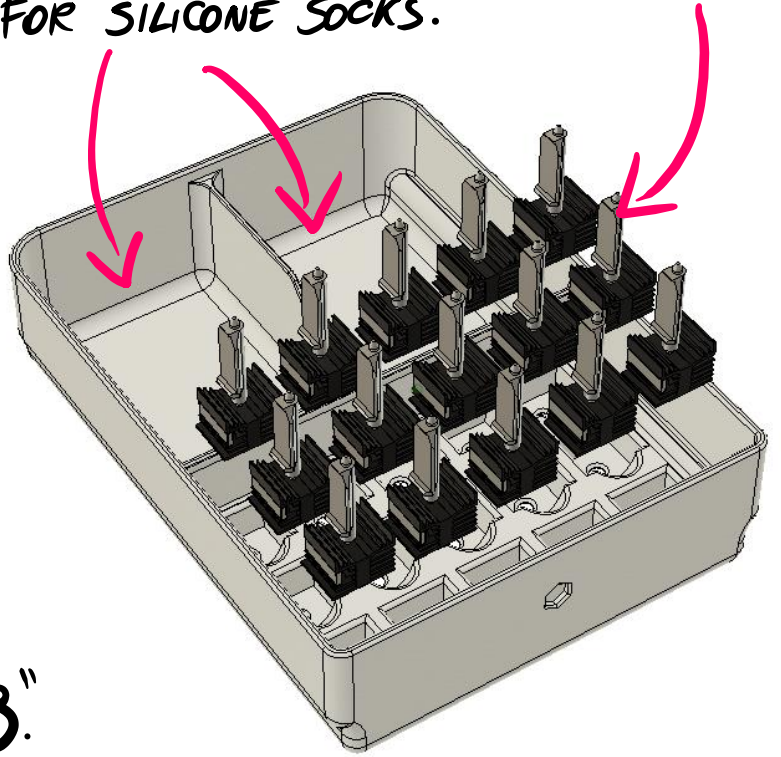

GLUE THE MAGNETS USING THE "MAGNET INSTALLER B."

ONCE PLACED INSIDE THE DRAWER, YOU CAN SLIDE IT AND LOCK IT
EITHER ALL THE WAY BACK OR ALL THE WAY FORWARD THANK TO THE
BUILT-IN MAGNETS.



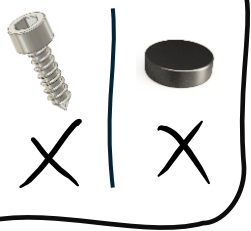

DRAWERS ASSEMBLY

BAMBU LAB P2S DRAWER



POOP DRAWER ALSO HAS TWO INTERNAL BOXES TO MAXIMIZE SPACE

TOOL DRAWER STANDARD OPTION:

LARGE DRAWER WITH BUILD-IN COMPARTEMENTS AND A DEDICATED INSERT FOR THE HOTEND.

TOOL DRAWER GRIDFINITY OPTION:

IF YOU PREFER GRIDFINITY (FREE OPTION), YOU CAN USE THE INCLUDED BOXES OR YOU CAN DESIGN YOUR OWN DOWNLOADING FROM FREE PLATFORMS OR USING THE GRIDFINITY ONLINE CONFIGURATOR

HERE THE LINK ↴

<https://gridfinitygenerator.com/en/baseplate>

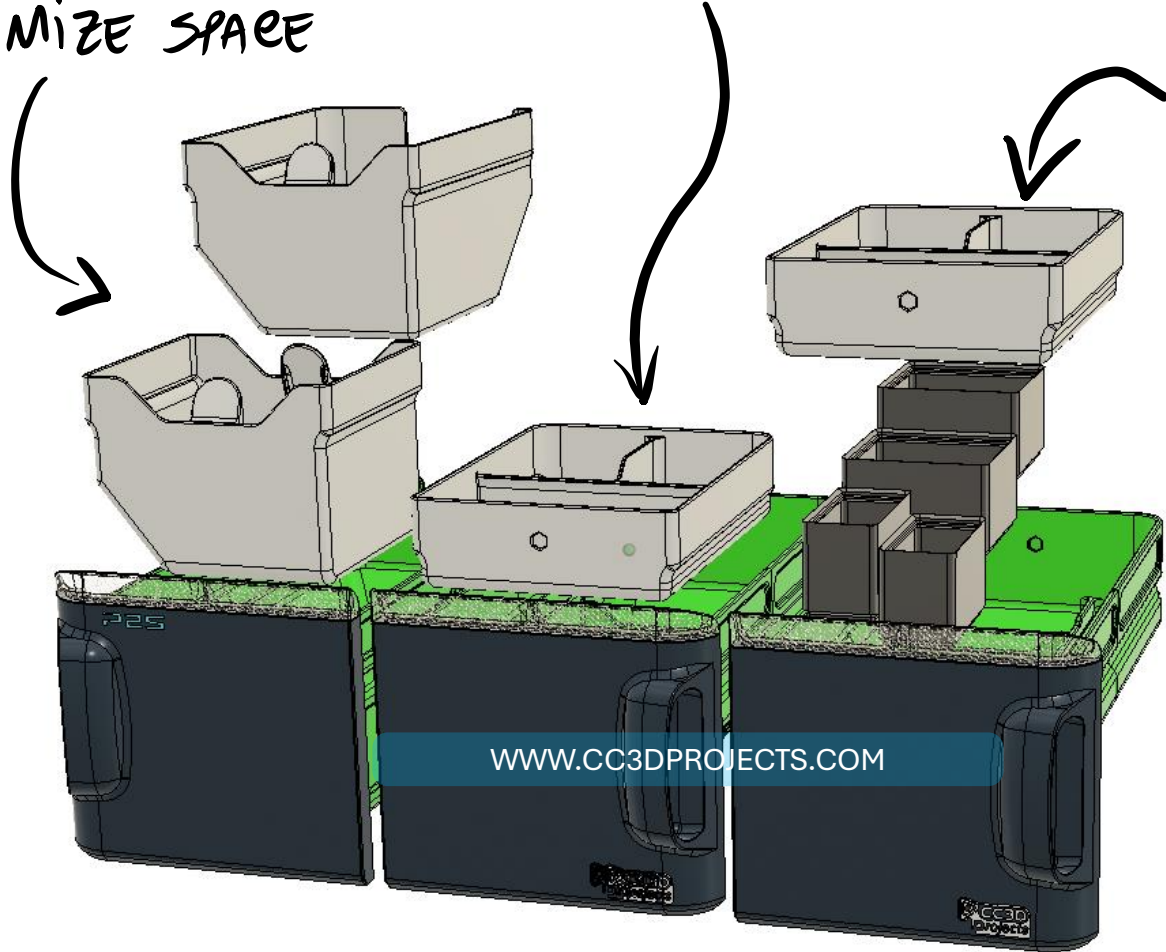

WWW.CC3DPROJECTS.COM



ALL MATERIAL PRODUCED AND PROVIDED HAS BEEN CONCEIVED, AUTHORED AND PRODUCED BY ENRICO MAZZAROL - ALL RIGHTS RESERVED.

FEET INSTALLATION BAMBU LAB P2S DRAWER

WHITE FEET SHOULD YOU INSTALL?

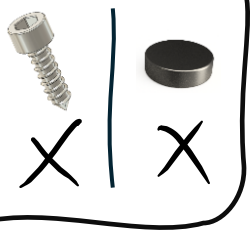

ADHESIVE SILICONE HEMISPHERICAL PADS.

THE PRINTER ALREADY COMPENSATE FOR VIBRATIONS IT PRODUCES.

STICK THE PADS ON AS SHOWN.



HULA FEET.

THEY ARE USEFULL IF YOU HAVE MORE THE TWO PRINTERS ON THE SAME SURFACE.

I DESIGNED THESE TO USE BAMBU X1E HULA FEET, INSTALL THE HULAS INTO THE HIGHLIGHTED HOLES.

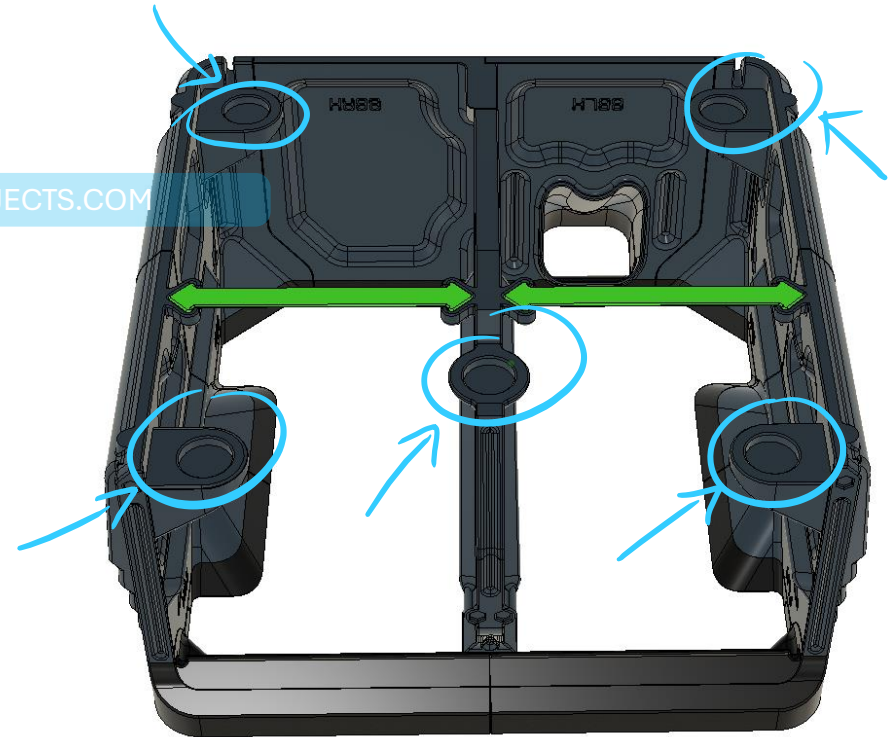

HULA FEET & VIBRATION - WHAT I LEARNED **BAMBU LAB P2S DRAWER**

JUST SHARING A FEW REFLECTIONS BASED ON HANDS-ON EXPERIENCE AND SOME MECHANICAL REASONING ABOUT MODERN 3D PRINTERS.

I THINK IT'S IMPORTANT TO SEPARATE VIBRATION ISOLATION FROM ACTUAL PRINT QUALITY.

- INPUT SHAPING IS DESIGNED TO COMPENSATE FOR THE PRINTER'S OWN STRUCTURAL RESONANCES DURING FAST AXIS MOVEMENTS.
- HULA FEET, ON THE OTHER HAND, ARE MAINLY MEANT TO ISOLATE THE PRINTER FROM THE SURFACE IT'S SITTING ON.

- THOSE ARE TWO DIFFERENT PURPOSES.

A SIMPLE WAY TO LOOK AT IT: IMAGINE HAVING A PERFECTLY TUNED SPORTS CAR AND THEN PARKING IT ON A SOFT SURFACE. THE SUSPENSION IS STILL EXCELLENT — BUT NOW YOU'VE ADDED COMPLIANCE UNDERNEATH, WHICH CHANGES THE OVERALL BEHAVIOR OF THE SYSTEM.

WHEN YOU RUN INPUT SHAPING CALIBRATION, YOU'RE MEASURING THE ENTIRE SYSTEM (PRINTER PLUS SUPPORT PLUS SURFACE). IF YOU INTRODUCE ELASTIC ELEMENTS UNDERNEATH, YOU'RE EFFECTIVELY ADDING A NEW LOW-FREQUENCY RESONANCE. AND IF THE TABLE ITSELF ISN'T PERFECTLY STABLE, SMALL CHANGES OVER TIME — LOAD SHIFTS, SETTLING, MICRO-MOVEMENTS — CAN SLIGHTLY CHANGE THAT RESONANCE. THAT MEANS A SINGLE CALIBRATION MAY NOT ALWAYS REMAIN PERFECTLY REPRESENTATIVE.

IT'S ALSO WORTH CONSIDERING THE MATERIAL ASPECT. TPU AND SIMILAR FLEXIBLE MATERIALS CAN CREEP OR SETTLE UNDER CONSTANT LOAD OVER TIME. AS THAT HAPPENS, THE DYNAMIC RESPONSE OF THE SYSTEM MAY CHANGE SLIGHTLY, POTENTIALLY AFFECTING THE CONSISTENCY OF A PREVIOUSLY TUNED CALIBRATION.

- **IN MY OPINION — AND BASED ON MY EXPERIENCE...**

...ON A MODERN PRINTER WITH A RIGID FRAME AND PROPERLY TUNED INPUT SHAPING, HULA FEET DON'T REALLY IMPROVE PRINT QUALITY. THEY CAN ABSOLUTELY HELP REDUCE NOISE OR VIBRATION TRANSMITTED TO FURNITURE, BUT THAT'S A DIFFERENT GOAL.

NOW REGARDING MY DRAWER: THE PRINCIPLE IS COMPLETELY DIFFERENT.

IT DOES NOT INTRODUCE ELASTICITY BETWEEN THE PRINTER AND THE SUPPORT.

THE DRAWER IS RIGID, AND THE PRINTER SITS ON ITS ORIGINAL FEET. THE SILICONE PADS ARE THERE ONLY TO IMPROVE GRIP AND PREVENT SLIPPING — NOT TO CREATE A SOFT SUSPENSION SYSTEM.

SOME MIGHT ARGUE THAT RAISING THE PRINTER HIGHER COULD INCREASE OSCILLATION. BUT HEIGHT ALONE DOESN'T CREATE INSTABILITY — ELASTICITY DOES.

- **THINK ABOUT IT THIS WAY:**

IF YOU PLACE AN OBJECT ON A TALL BUT RIGID STRUCTURE, IT WON'T WOBBLE.

IF YOU PLACE IT ON SOMETHING SOFT, EVEN IF IT'S LOW, IT CAN MOVE.

IF THE PRINTER IS STABLE ON THE DRAWER, AND THE DRAWER ITSELF IS RIGID AND FIRMLY SUPPORTED, THE WHOLE SYSTEM BEHAVES AS A SINGLE SOLID BODY. EVEN IF IT'S TALLER, AS LONG AS IT REMAINS STRUCTURALLY RIGID, IT WON'T INTRODUCE NEW RESONANCES OR INTERFERE WITH INPUT SHAPING COMPENSATION.

JUST TO BE CLEAR: THESE ARE SIMPLY MY PERSONAL THOUGHTS AND EXPERIENCES.

EVERYONE IS FREE TO MAKE THEIR OWN CHOICES, AND I FULLY RESPECT THAT. DIFFERENT SETUPS, DIFFERENT GOALS — WHAT WORKS FOR YOU IS WHAT MATTERS.



Enrico

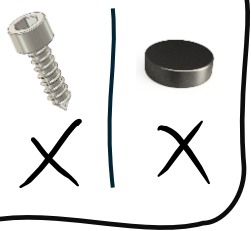

DRAWERS INSTALLATION

BAMBU LAB P2S DRAWER



SLIDE THE DRAWERS IN!

IF THE DRAWERS DO NOT SLIDE SMOOTHLY
FIRST CHECK THAT THE RAILS ARE
ALIGNED WITH THE WAWS.

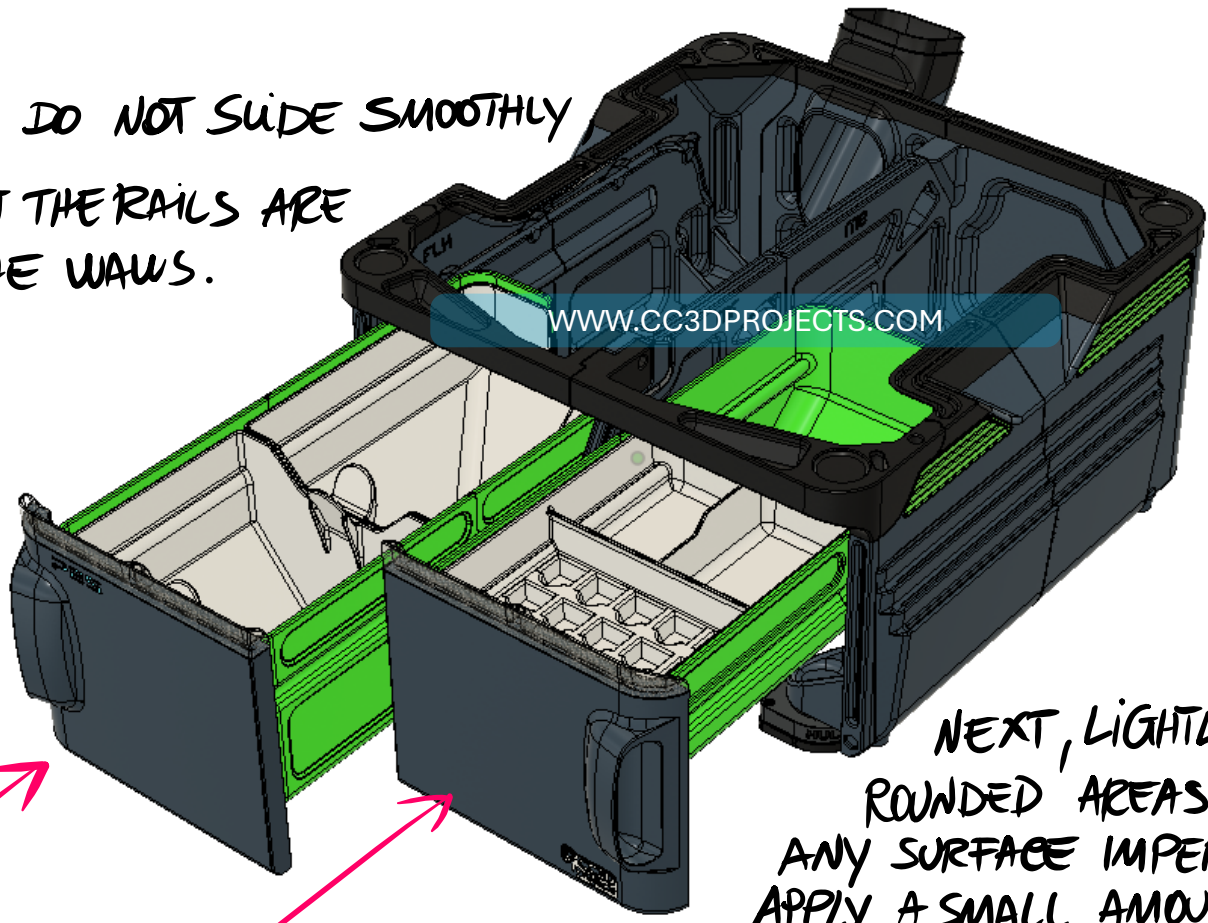

NEXT, LIGHTLY SAND THE
ROUNDED AREAS TO REMOVE
ANY SURFACE IMPERFECTIONS, THEN
APPLY A SMALL AMOUNT OF GREASE
FOR LUBRICATION.

KEEP IN MIND THAT PETG NATURALLY HAS MORE GRIP THAN PLA!



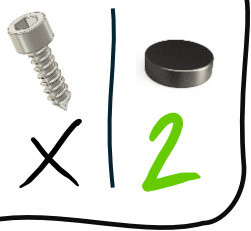

BACK PIPE SETUP

BAMBU LAB P2S DRAWER



TIME TO INSTALL THE MAGNETS ON THE BACK PIPE.

GLUE THE MAGNET IN PLACE USING THE "MAGNET INSTALLER A".

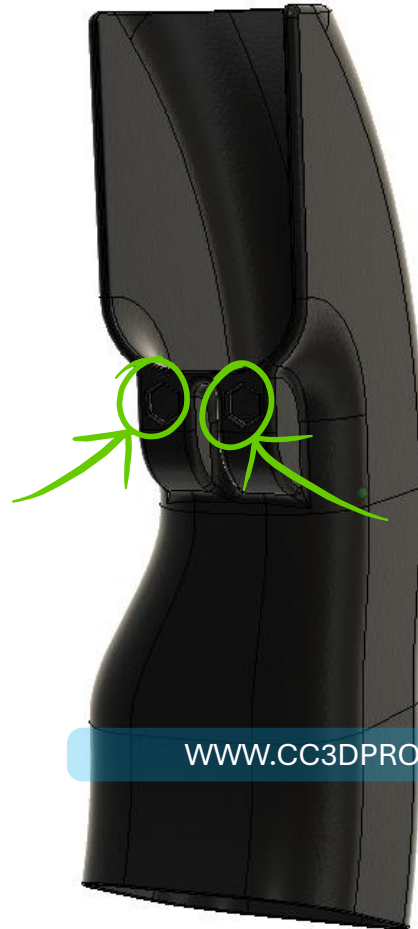

WWW.CC3DPROJECTS.COM



BACK PIPE INSTALLATION BAMBU LAB P2S DRAWER

NOW PLACE THE PRINTER ON THE DRAWER. TAKE IT EASY, AND MAYBE GET SOMEONE TO HELP. DON'T WANT YOU HURTING YOUR BACK OR DROPPING THE PRINTER! ❤️

THEN ATTACH THE BACK PIPE AND YOU ARE DONE!

THE PIPE GOES HERE

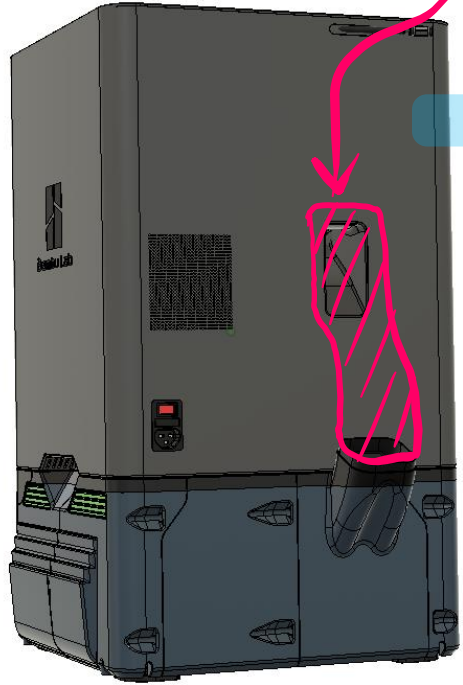

WWW.CC3DPROJECTS.COM

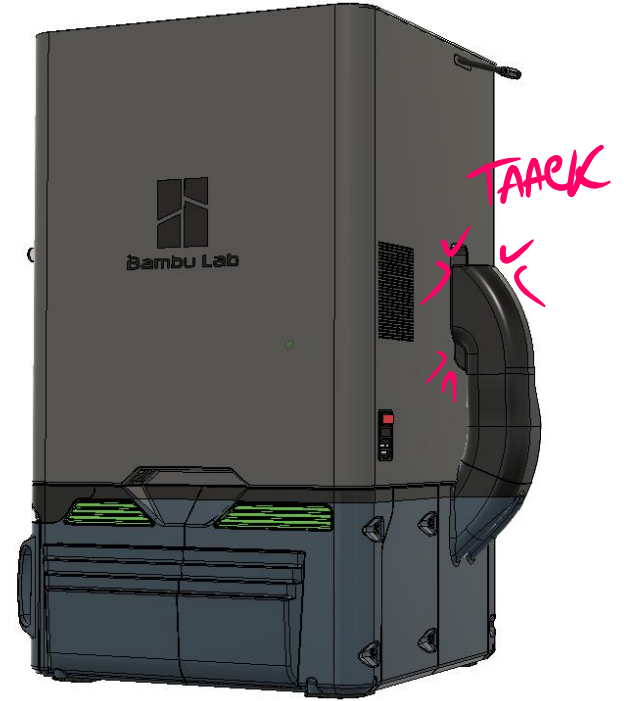
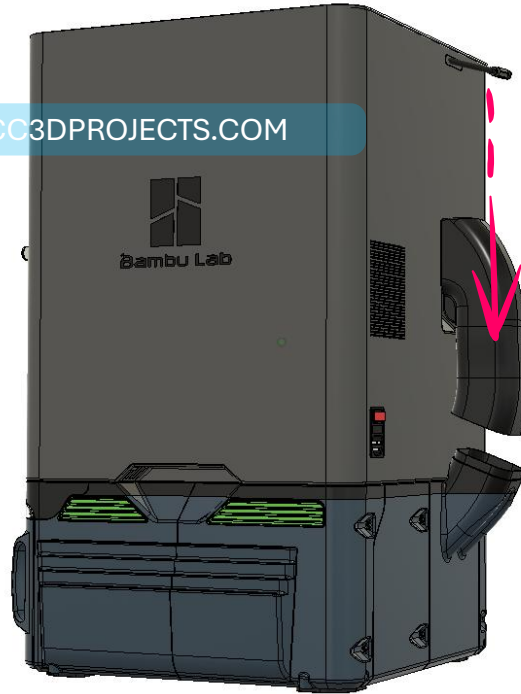

PRINT BED PLACEMENT BAMBU LAB P2S DRAWER

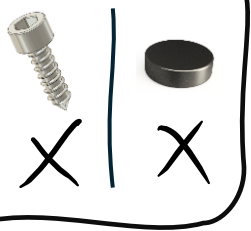

NOW YOU'RE READY TO SLIDE IN ALL THE BUILD PLATES YOU OWN, JUST KEEP IN MIND IT ONLY HOLDS UP TO 8, SO DON'T GO TO CRAZY WITH THE SHOPPING! LOL

INSTALLATIO



BAMBU LAB P2S DRAWER

ALRIGHT, LOOK LIKE YOU MADE IT TO THE END!
BUT, IF YOUR RESULT DOESN'T LOOKS KINDA LIKE THIS...
... MY FRIEND ...

WHAT ARE YOU DOING WITH YOUR LIFE? 😊
SERIOUSLY THOUGH ...

JUST HIT ME UP, WE'LL FIGURE OUT
WHAT WENT WRONG!!

BUT

WWW.CC3DPROJECTS.COM

IF YOU ARE PROUD OF WHAT YOU BUILD
(AND YOU SHOULD BE) ...

... WELL ...

... HOW ABOUT SNAPPING A COUPLE
OF PICS AND TOSSING THEM ONLINE?

MAYBE TAGGING ME?

#CC3DPROJECTS

THANKS
Enrico



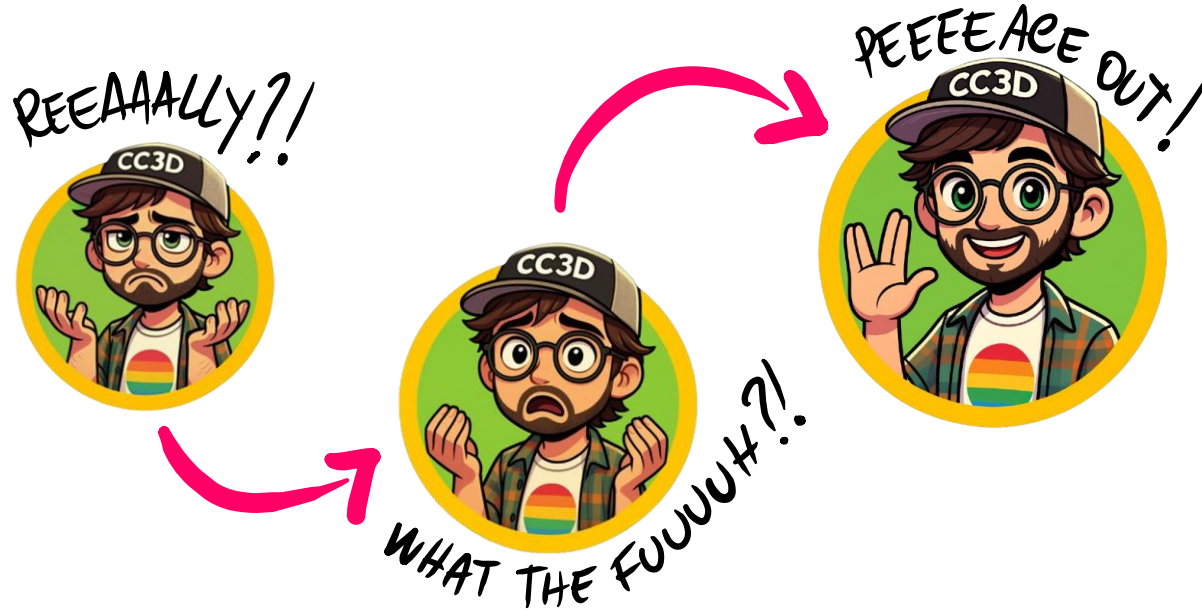

THANKS FOR STICKING WITH ME THROUGH THIS ASSEMBLY GUIDE
IT TOOK ME HOURS TO PUT THIS GUIDE TOGETHER, I TRULY HOPE YOU LIKE IT!
IF THERE'S ANYTHING I CAN DO BETTER, PLEASE LET ME KNOW!
I'M ALWAYS HERE TO HELP AND IMPROVE MY WORK AND MY MODELS!

CIAO
Enrico





WWW.CC3DPROJECTS.COM

© 2025 CC3DPROJECTS. ALL RIGHTS RESERVED.

THIS MANUAL IS PROTECTED BY COPYRIGHT LAW AND MAY NOT BE REPRODUCED, DISTRIBUTED, OR USED IN WHOLE OR IN PART WITHOUT THE WRITTEN PERMISSION OF THE AUTHOR OR PUBLISHER. ANY VIOLATION WILL BE PROSECUTED TO THE FULLEST EXTENT OF THE LAW.

THE BAMBU LAB P2S DRAWER AND ALL ITS COMPONENTS, INCLUDING BUT NOT LIMITED TO DESIGNS, SCHEMATICS, ASSEMBLY INSTRUCTIONS, AND PHOTOGRAPHS, ARE THE EXCLUSIVE PROPERTY OF ENRICO MAZZAROL AND ARE PROTECTED BY COPYRIGHT LAW AND OTHER INTELLECTUAL PROPERTY LAWS.

COPYING, DISTRIBUTING, MODIFYING, REPRODUCING, TRANSMITTING, OR USING THE HDRI SYSTEM IN ANY FORM WITHOUT THE WRITTEN PERMISSION OF CC3DPROJECTS IS PROHIBITED.

FOR USAGE REQUESTS, PERMISSIONS, OR OTHER INQUIRIES, PLEASE CONTACT CC3DPROJECT@GMAIL.COM.

