



Bambu Lab *H2D* DRAWER

DRAWER FOR BAMBU LAB H2D.

THE CUSTOM DESIGNED DRAWER FOR THE **BAMBU LAB H2D** PRINTER IS A MODULAR, FUNCTIONAL SOLUTION BUILT TO IMPROVE ORGANIZATION AND WASTE MANAGEMENT. THE FRAME IS FULLY 3D-PRINTABLE AND FEATURES A DUAL-COLOR DESIGN FOR A CLEAN, MODERN LOOK.

MAIN FEATURES:

- **DUAL-COLOR PRINTABLE FRAME:** DESIGNED FOR EASY PRINTING WITH A STYLISH FINISH.
- **POOP COLLECTION DRAWER:** REMOVABLE TRAY TO COLLECT PURGE WASTE DIRECTLY FROM THE PRINTER.
- **TOOLS & SPARE PARTS DRAWER:** EXTRA STORAGE SPACE FOR HAND TOOLS, NOZZLES, AND REPLACEMENT PARTS.
- **REAR WASTE PIPE SYSTEM:** INCLUDES A BACK EXIT PIPE TO CHANNEL WASTE TO AN EXTERNAL CONTAINER.
- **TWO VERSIONS INCLUDED:** RIGID PIPE AND FLEXIBLE PIPE TO SUIT DIFFERENT SETUPS.
- **INTERNAL MINI DRAWERS:** PERFECT FOR ORGANIZING SMALL TOOLS, SCREWS, OR MAINTENANCE PARTS.
- **OPTIONAL HULA FEET COMPATIBILITY:** READY FOR OPTIONAL INSTALLATION OF HULA FEET FOR VIBRATION ISOLATION.

THIS DRAWER IS DESIGNED TO SEAMLESSLY INTEGRATE WITH THE H2D, DELIVERING ADDED FUNCTIONALITY WITHOUT COMPROMISING ACCESS OR STYLE.

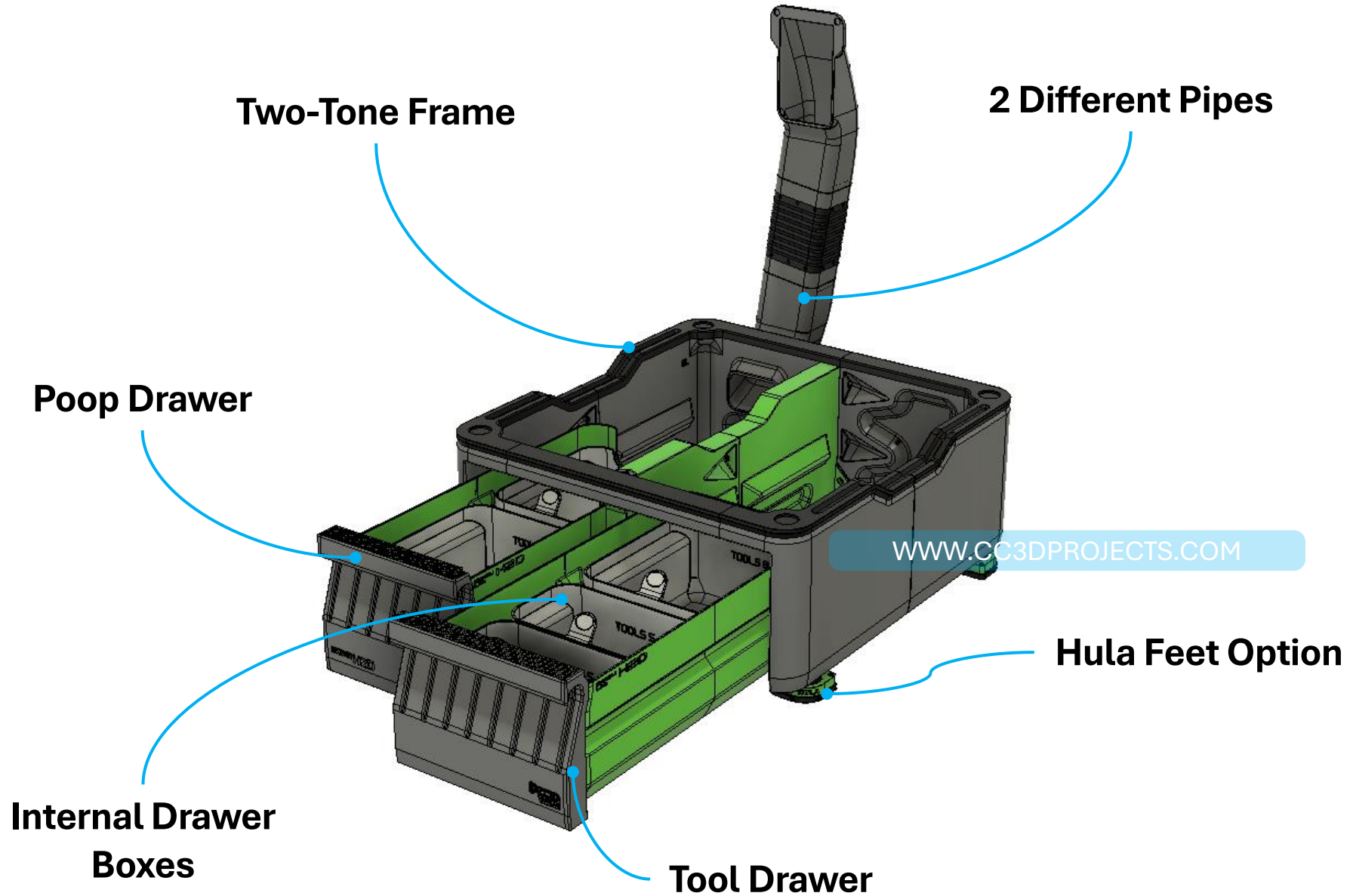

DIMENSIONS

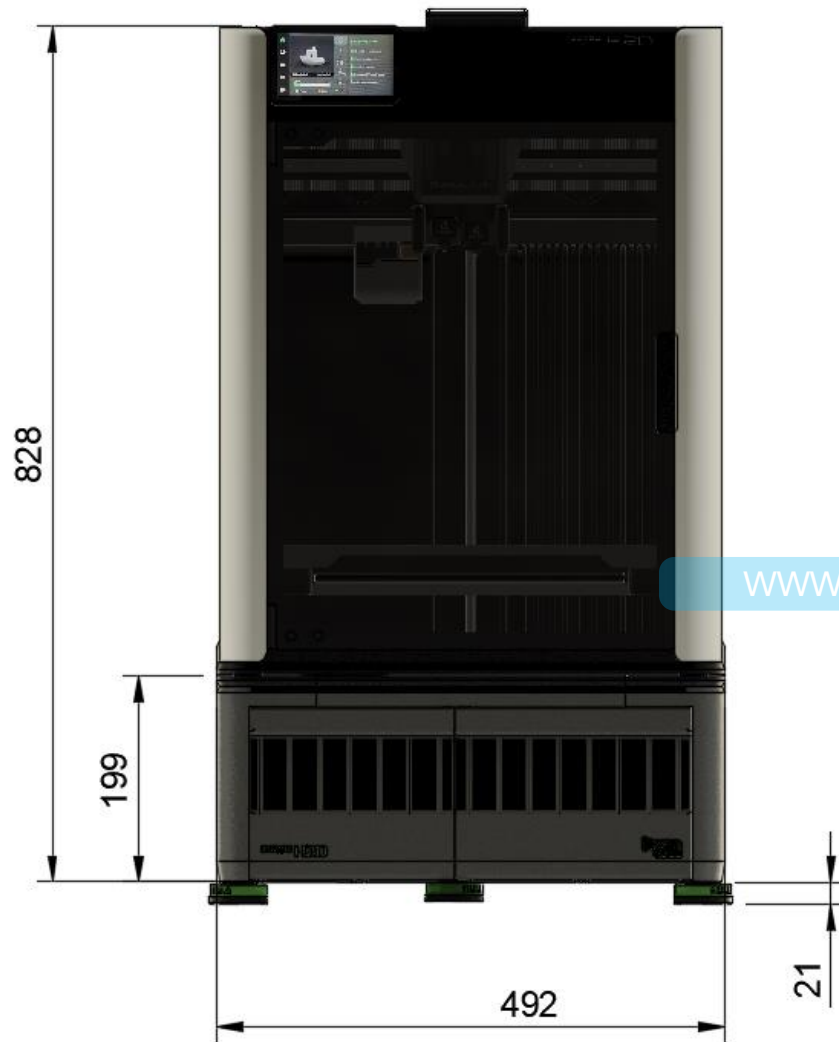

Main Body and Drawers

PETG



210 g

PETG



3.4 Kg

PETG



1.7 Kg

Print time
5d 23h 30m

Rigid Pipe

PETG



300 g

Print time
10h 51m

Flexible Pipe

TPU

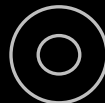

70 g

PETG



260g

Print time
16h 20m

REQUIRED SPARE PARTS:



SCREW M4 14 mm

30 units



MAGNET 8X2 mm

10 units

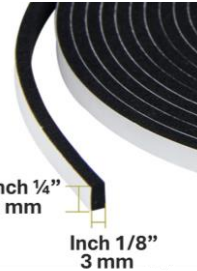

Adhesive GASKET

1m

PROJECTS.COM

FOLLOW THESE SIMPLE TIPS AND YOU'RE GOLDEN:



1. STICK WITH REGULAR PETG

USE STANDARD PETG, AND SKIP THE HIGH FLOW (HF) STUFF. HF MIGHT SOUND COOL, BUT IT CAN'T HANDLE HEAT AS WELL, AND THAT CAN MESS WITH YOUR PRINT'S DURABILITY. YEAH, REGULAR PETG IS SHINIER — I GET IT — BUT HERE'S A TRICK: SPRAY IT WITH A MATTE CLEAR COAT LIKE I DID. BOOM! PROBLEM SOLVED.



2. DON'T USE PLA FOR SUPPORTS

VOID USING PLA AS SUPPORT MATERIAL. SERIOUSLY. EVEN IF YOU SWITCH FILAMENTS, LEFTOVER PLA IN THE NOZZLE CAN MESS WITH LAYER ADHESION, AND THAT'S NO FUN. AND DON'T STRESS — THE SUPPORTS COME OFF EASY, I PROMISE. YOU GOT THIS.



3. KEEP IT SLOW AND STEADY

RESIST THE URGE TO CRANK UP THE PRINT SPEED. GOING TOO FAST CAN LEAD TO WEIRD-LOOKING CORNERS AND WARPED PARTS. STICK TO STANDARD SPEED — YOUR PRINT WILL THANK YOU.



4. USE A GRIPPY PRINT BED

THESE PARTS ARE ON THE BIGGER SIDE, SO BED ADHESION IS EVERYTHING. MAKE SURE YOUR BUILD PLATE'S GOT A GOOD GRIP TO AVOID WARPING OR LIFTING. TRUST ME, A SOLID FIRST LAYER MAKES ALL THE DIFFERENCE.

WWW.CC3DPROJECTS.COM



M4 SCREW

2



Tube Connector

0

LEFT SIDE PANEL

Bambu Lab H2D DRAWER



BRING THE PARTS TOGETHER AND INSERT THE SCREWS INTO THE HOLES MARKED IN RED. TIGHTEN THE SCREWS FIRMLY, BUT DO NOT OVERTIGHTEN — WHEN YOU START TO FEEL RESISTANCE, YOU'RE GOOD TO GO!

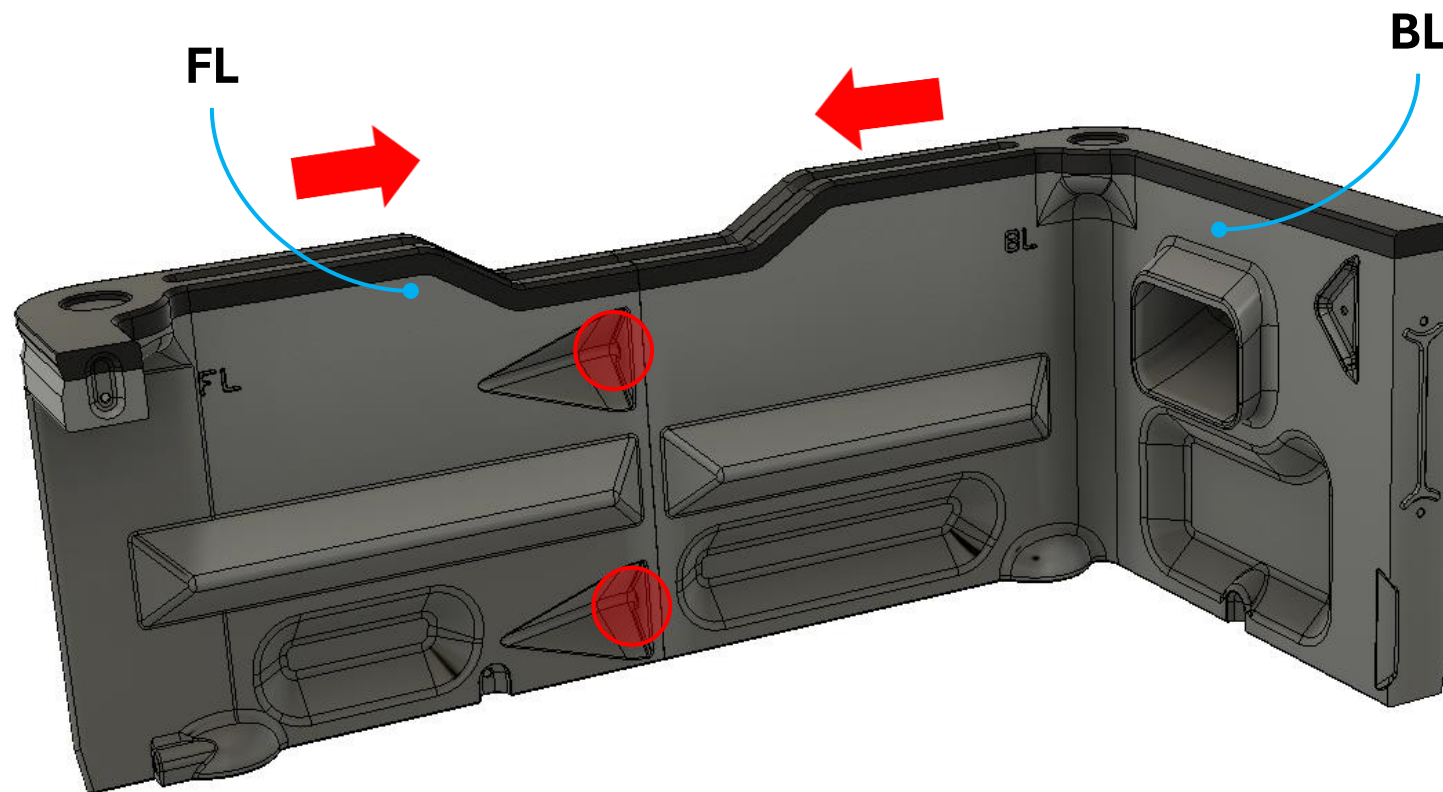



M4 SCREW

2



Tube Connector

0

RIGHT SIDE PANEL

Bambu Lab H2D DRAWER



Buy me a coffee



BRING THE PARTS TOGETHER AND INSERT THE SCREWS INTO THE HOLES MARKED IN RED. TIGHTEN THE SCREWS FIRMLY, BUT DO NOT OVERTIGHTEN — WHEN YOU START TO FEEL RESISTANCE, YOU'RE GOOD TO GO!

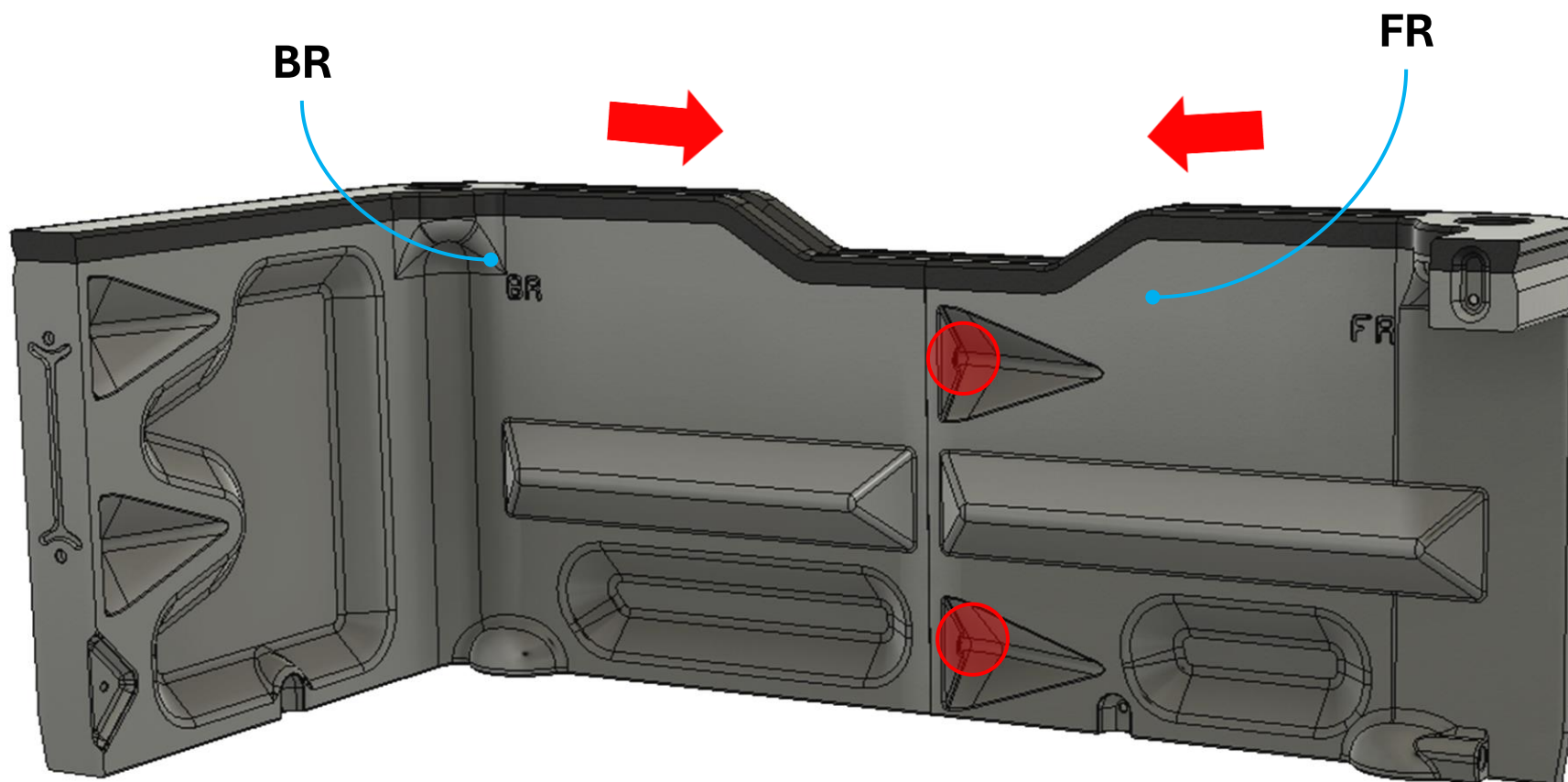



M4 SCREW

2



Tube Connector

0

MAIN BODY

Bambu Lab H2D DRAWER



Buy me a coffee



BRING THE PARTS TOGETHER AND INSERT THE SCREWS INTO THE HOLES MARKED IN RED. TIGHTEN THE SCREWS FIRMLY, BUT DO NOT OVERTIGHTEN — WHEN YOU START TO FEEL RESISTANCE, YOU'RE GOOD TO GO!

Left Side

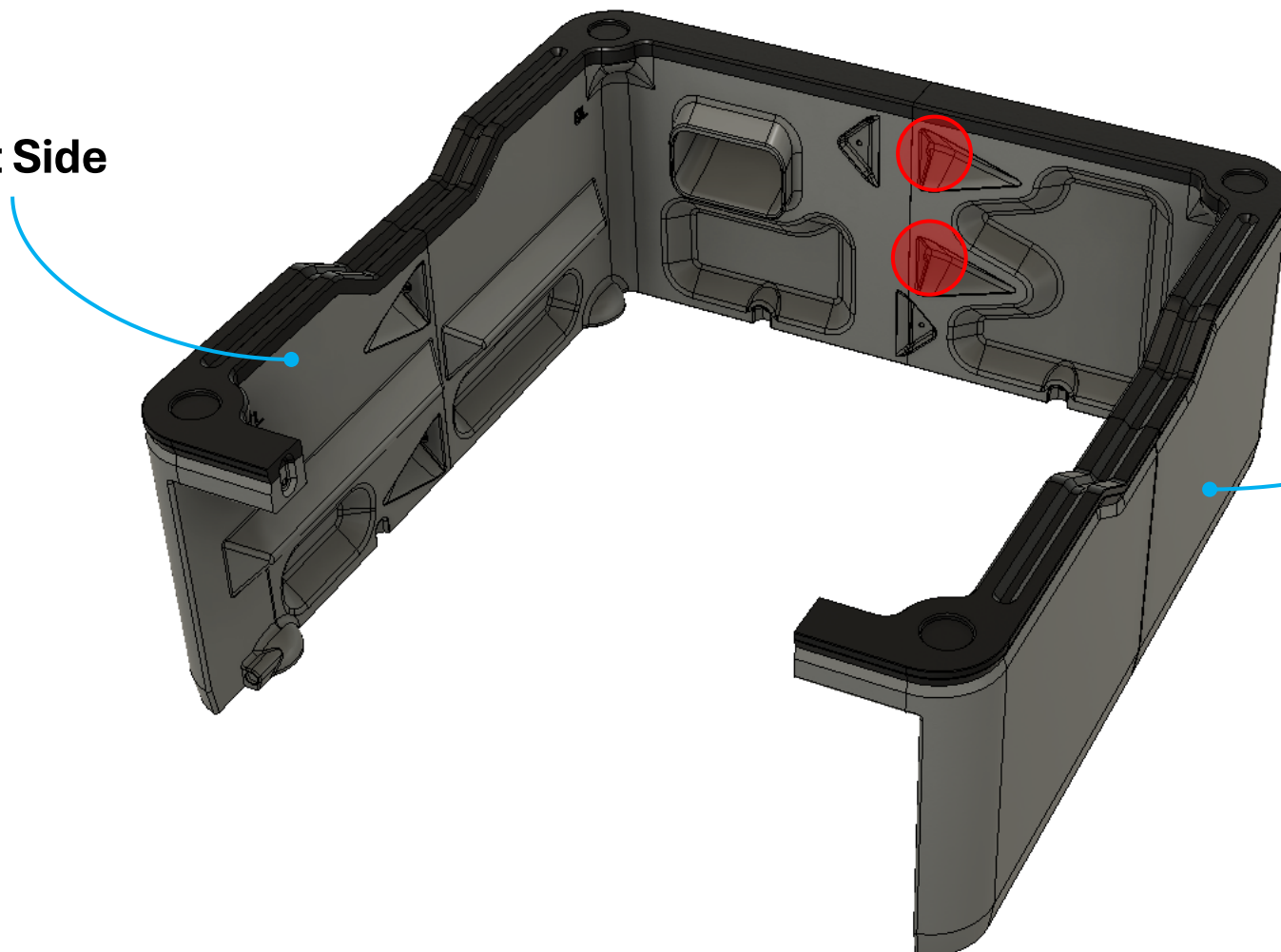

Right Side



M4 SCREW

2



Tube Connector

0

MIDDLE PANEL

ENCLOSURE A1



Buy me a coffee



THIS IS AN IMPORTANT STEP. YOU'LL NEED TO REPLACE A CRITICAL STRUCTURAL COMPONENT: PART T2 MUST BE REPLACED WITH THE UPGRADED T2B PART.REFER TO PAGE 21 OF THE MAIN MANUAL FOR DETAILED ASSEMBLY INSTRUCTIONS.DO NOT PRINT THE T2 PART – YOU'LL FIND IT ALREADY ON THE PRINT FILE “**ENCLOSURE A1 TOP.3MF**”BED 01 FROM THE MAIN ENCLOSURE PRINT.

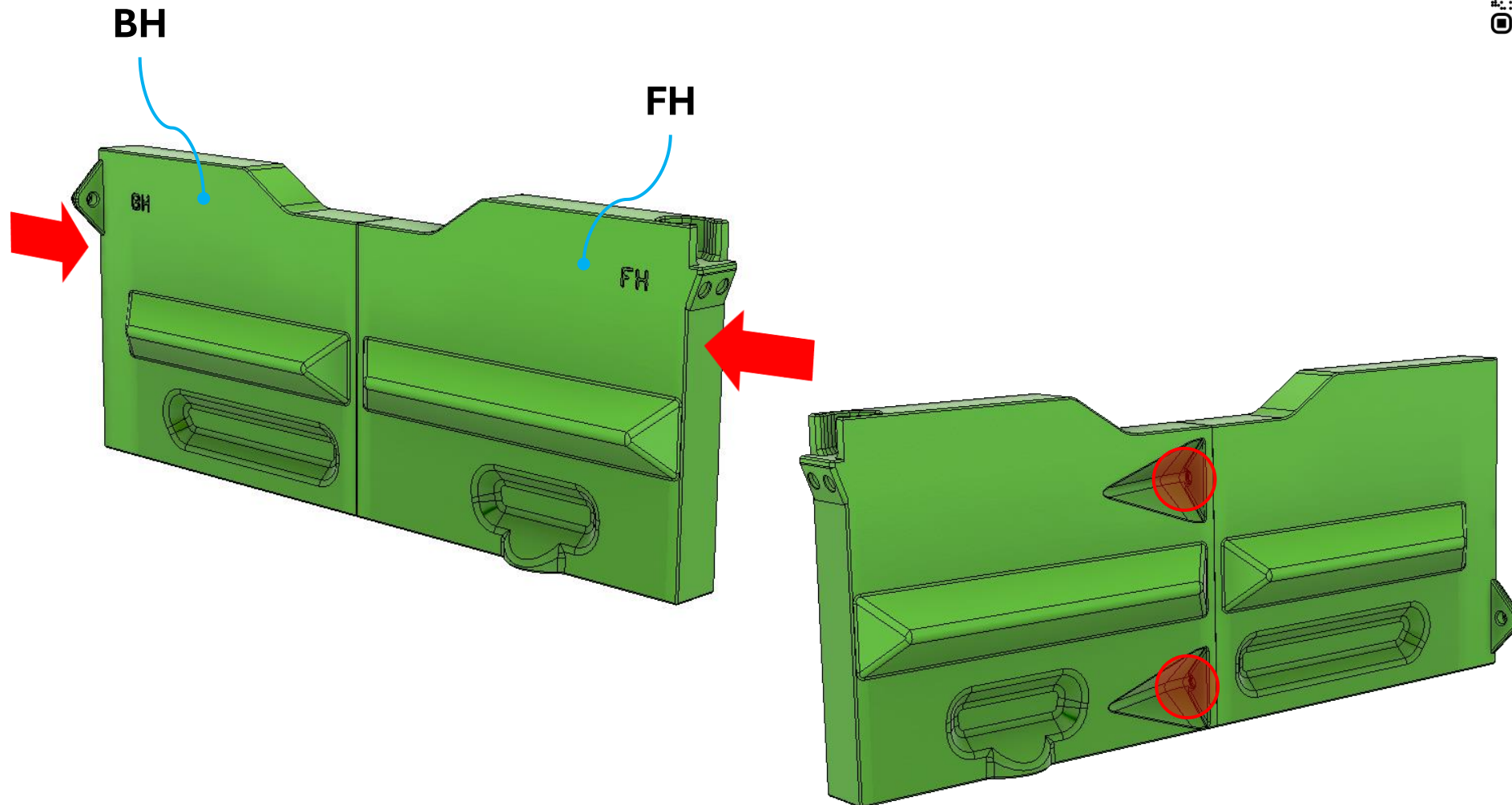



MIDDLE PANEL

Bambu Lab H2D DRAWER



Buy me a coffee



BRING THE PARTS TOGETHER AND INSERT THE SCREWS INTO THE HOLES MARKED IN RED. TIGHTEN THE SCREWS FIRMLY, BUT DO NOT OVERTIGHTEN — WHEN YOU START TO FEEL RESISTANCE, YOU'RE GOOD TO GO!

Left Side

Right Side

Center Side

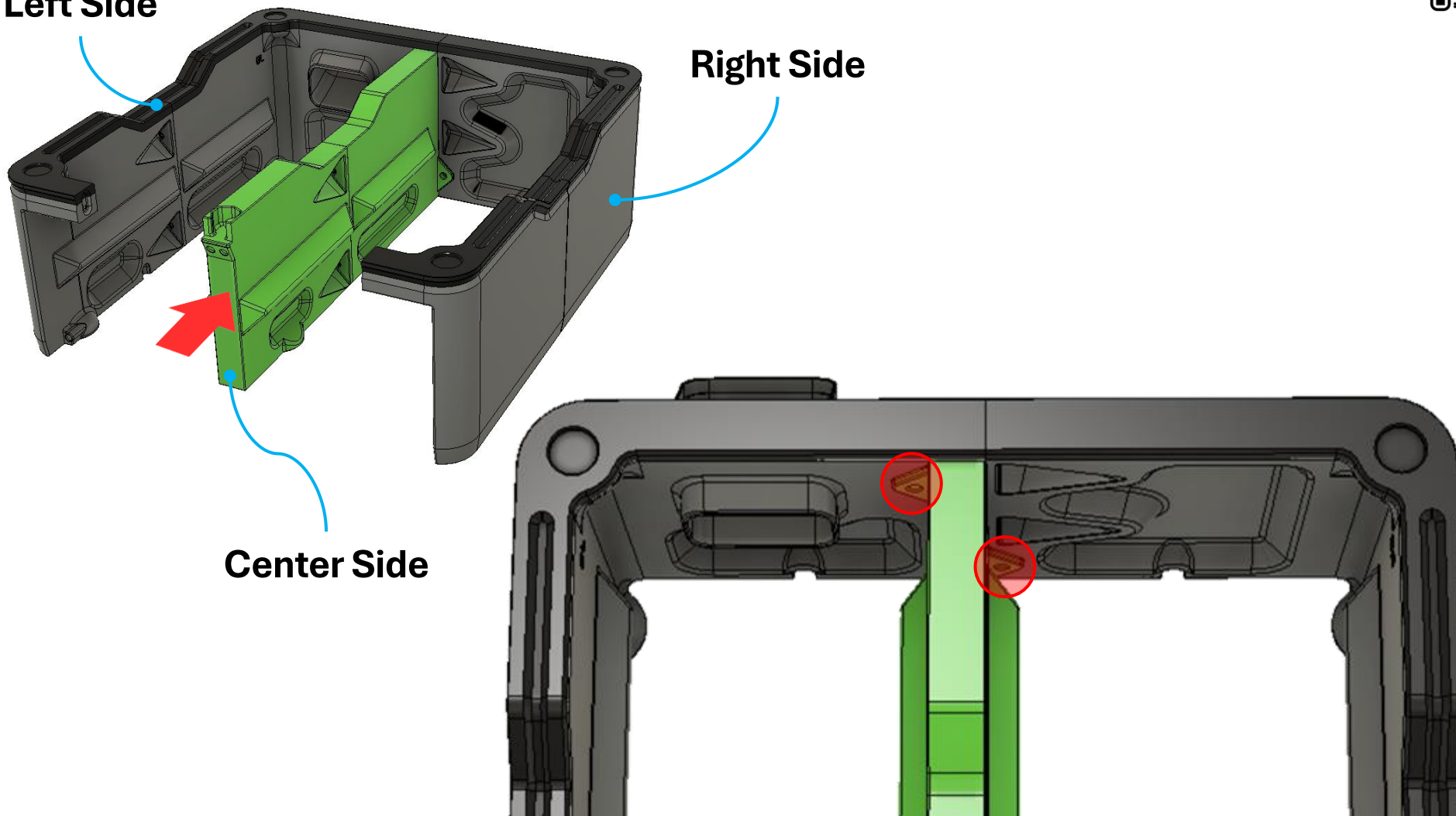



M4 SCREW

0



Tube Connector

4

BODY MAGNETS

Bambu Lab H2D DRAWER



USE **MAGNET INSTALLER A**, AVAILABLE FOR FREE ON MY SHOP, TO GLUE THE MAGNETS INTO THE HOLES MARKED IN YELLOW.

Buy me a coffee

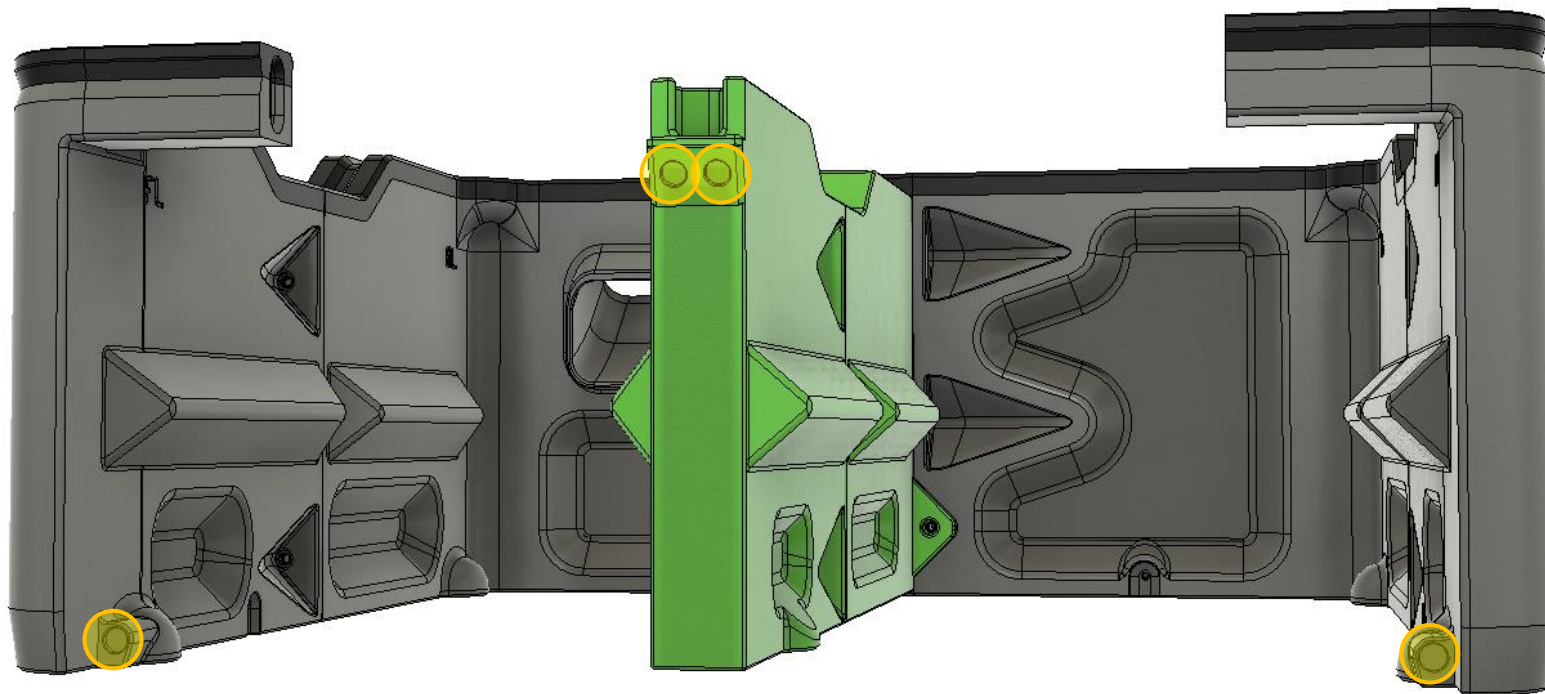



M4 SCREW

3



Tube Connector

0

FRONT BRIDGE

SNAP THE BRIDGE INTO PLACE, THEN SECURE IT BY INSERTING SCREWS INTO THE HOLES MARKED IN RED. TIGHTEN THE SCREWS UNTIL THEY START TO RESIST — THAT'S PERFECT!

Bambu Lab H2D DRAWER



Buy me a coffee

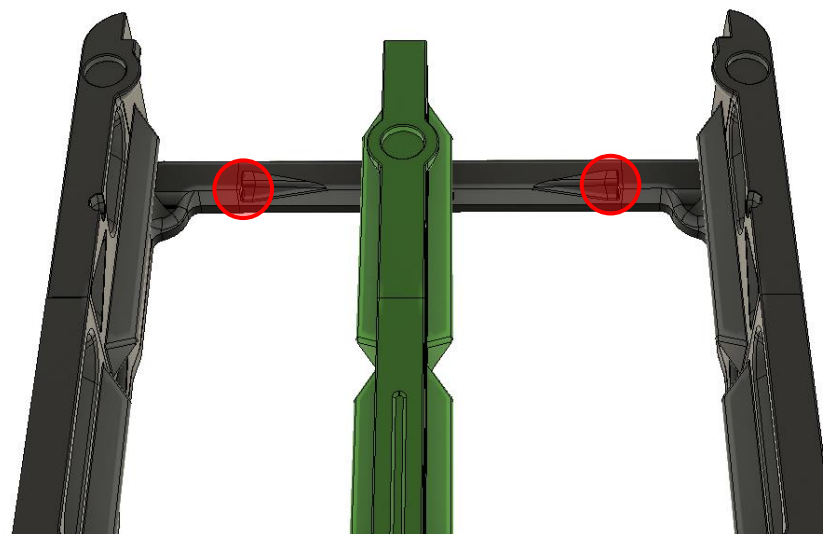
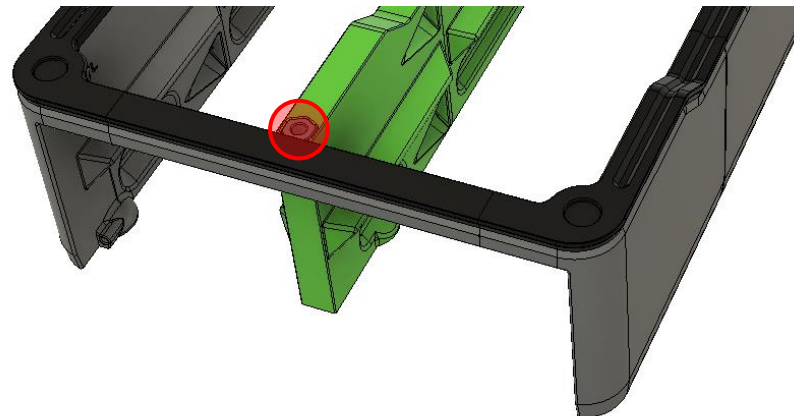
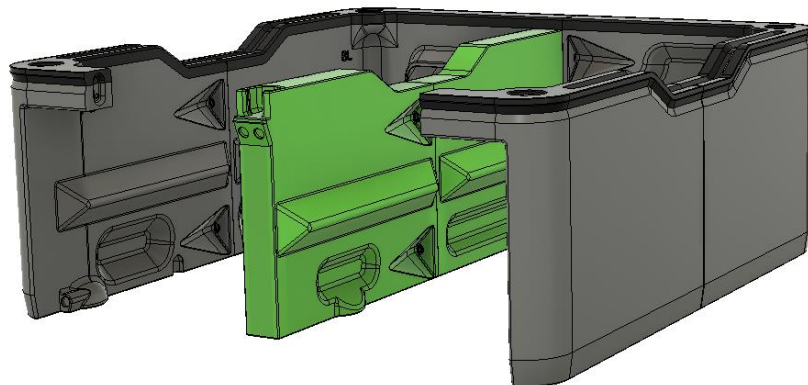



POOP DRAWER

JOIN THE TWO MAIN PARTS OF THE DRAWER BY INSERTING SCREWS INTO THE HOLES MARKED IN RED. TIGHTEN UNTIL THEY START TO FEEL FIRM — DO NOT OVERTIGHTEN.

Bambu Lab H2D DRAWER



Buy me a coffee

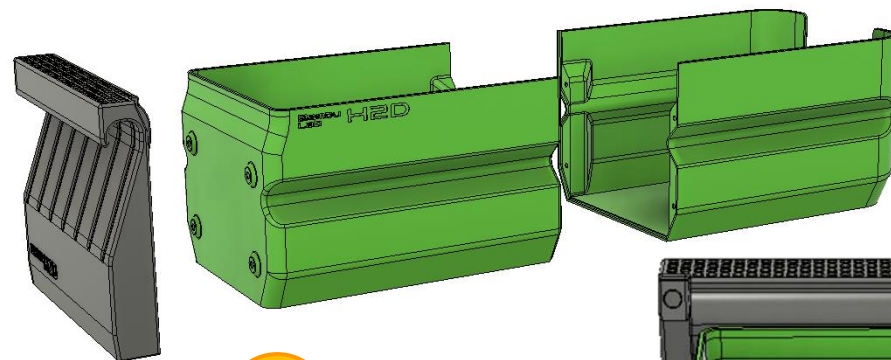

ATTACH THE FRONT PANEL TO THE DRAWER USING THE 4 SCREWS MARKED IN RED.

2

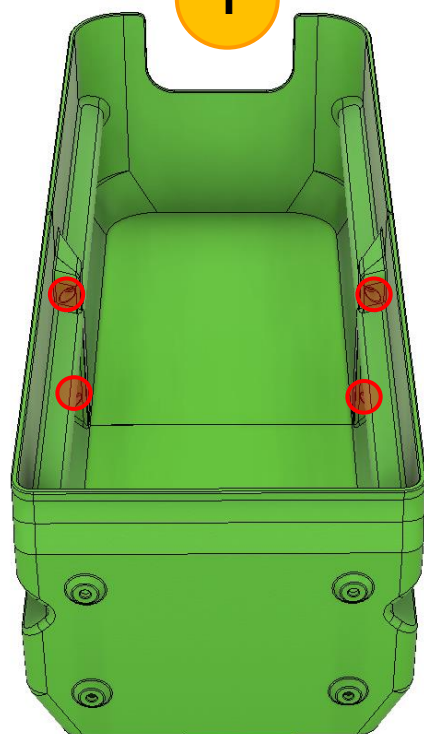

1

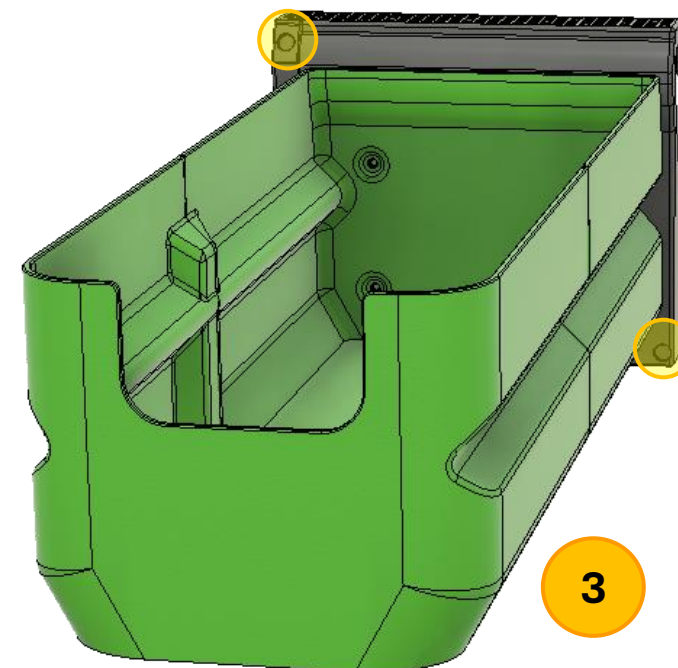

3

USE **MAGNET INSTALLER B** TO GLUE THE MAGNETS INTO THE HOLES MARKED IN YELLOW.



TOOL DRAWER

Bambu Lab H2D DRAWER



Buy me a coffee



JOIN THE TWO MAIN PARTS OF THE DRAWER BY INSERTING SCREWS INTO THE HOLES MARKED IN RED. TIGHTEN UNTIL THEY START TO FEEL FIRM — DO NOT OVERTIGHTEN.

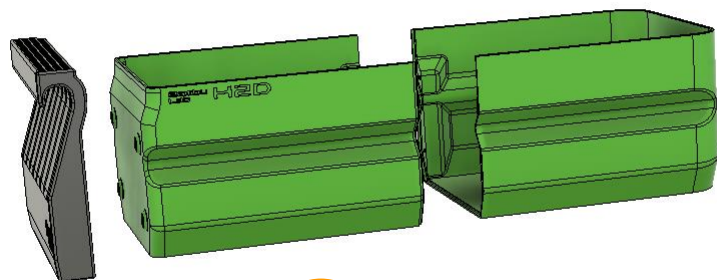

ATTACH THE FRONT PANEL TO THE DRAWER USING THE 4 SCREWS MARKED IN RED.

1

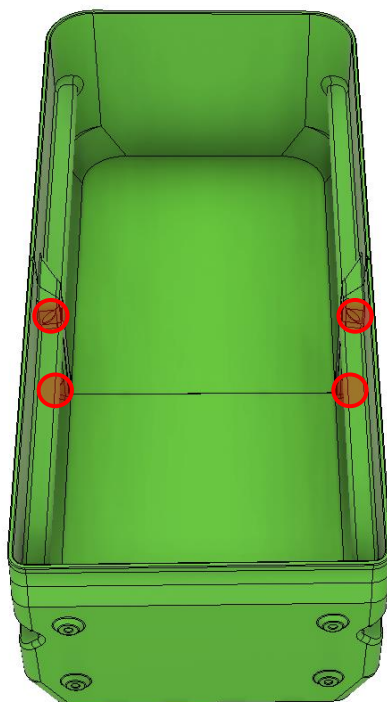

2



3

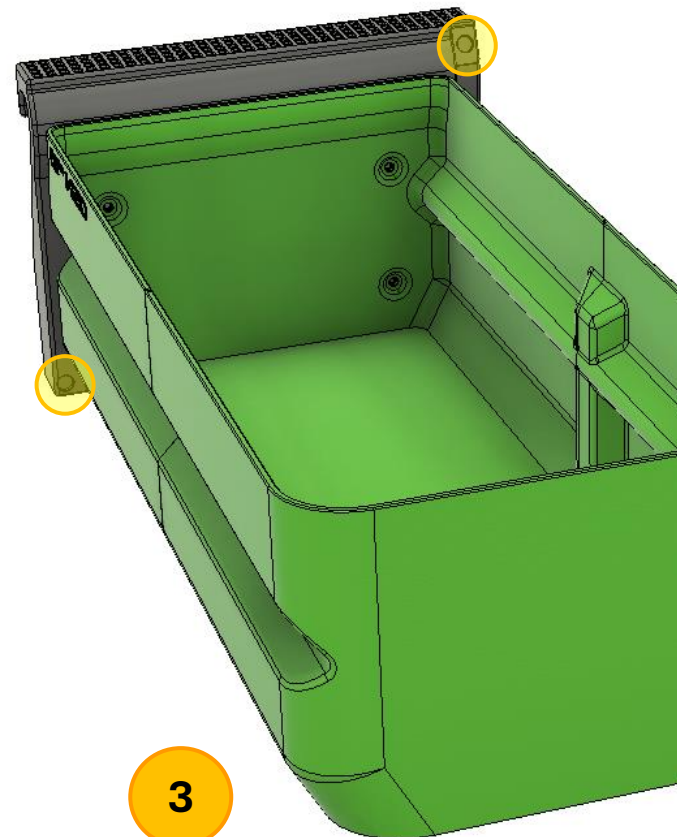

USE **MAGNET INSTALLER B** TO GLUE THE MAGNETS INTO THE HOLES MARKED IN YELLOW.



M4 SCREW

0



Tube Connector

0

DRAWER BOXES

Bambu Lab H2D DRAWER



NOW TAKE THE PRINTED BOXES AND INSERT THEM INTO THE DRAWERS AS SHOWN. PAY SPECIAL ATTENTION TO THE POOP DRAWER: THE POOP BOX MUST STAY AT THE BACK OF THE DRAWER.

Buy me a coffee





M4 SCREW

0



Tube Connector

0

MAIN BODY COMPLETION

Bambu Lab H2D DRAWER



INSERT THE DRAWERS INTO THE MAIN STRUCTURE — AND THAT'S IT, THE MAIN BODY IS COMPLETE.

Buy me a coffee

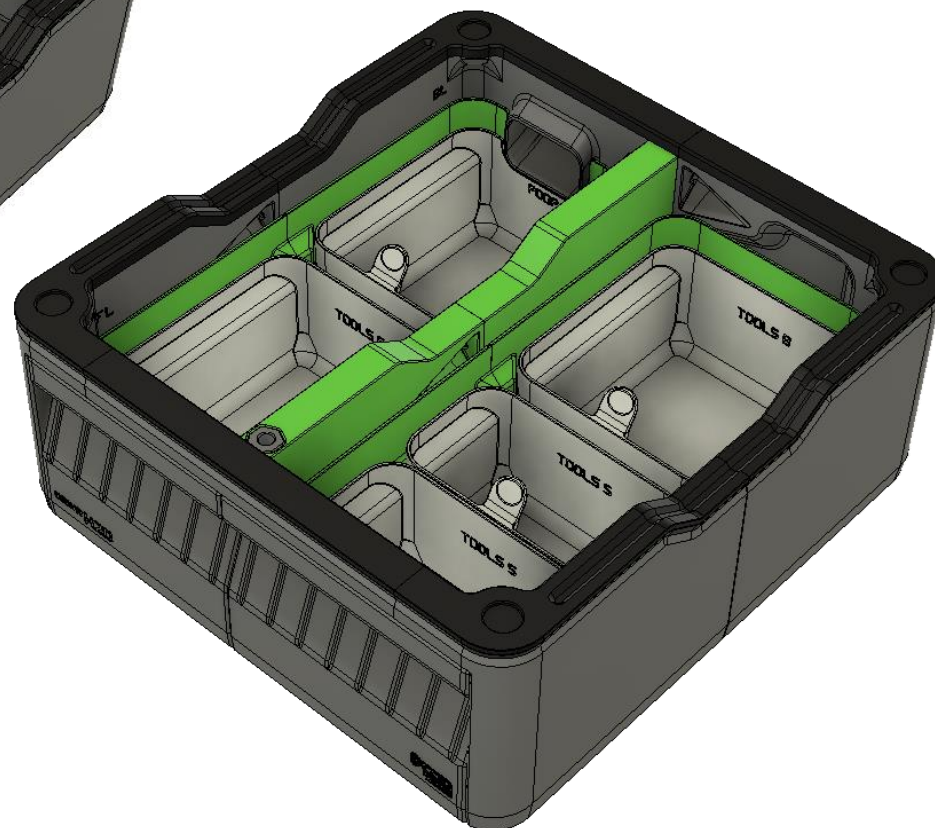
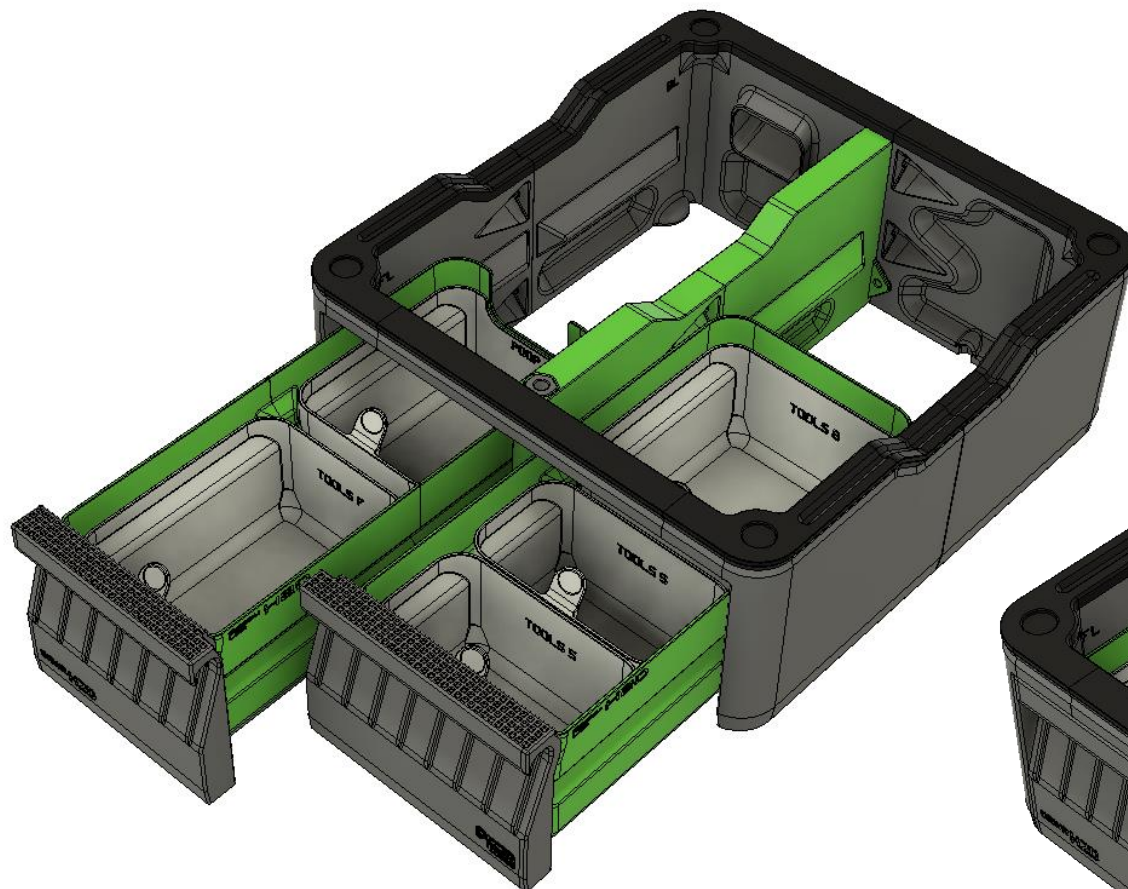



BACK POOP PIPE

ENCLOSURE A1



NOW LET'S MOVE ON TO THE REAR PIPE.

YOU HAVE TWO DIFFERENT VERSIONS — CHOOSE THE ONE YOU PREFER.

USE **MAGNET INSTALLER B** TO GLUE THE MAGNETS INTO THE HOLES MARKED IN YELLOW.

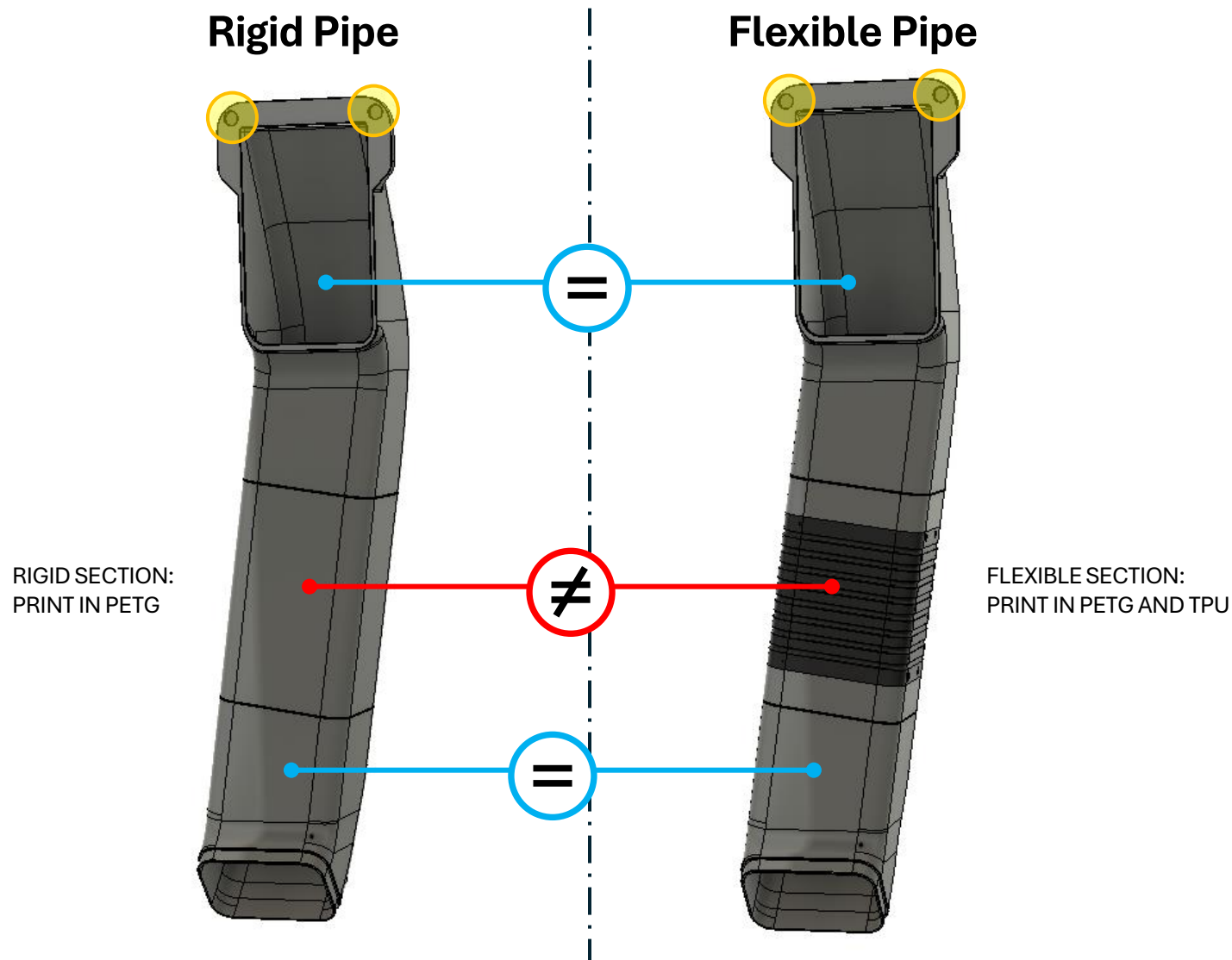



M4 SCREW

0



Tube Connector

0

BACK POOP PIPE

Bambu Lab H2D DRAWER



START BY INSERTING THE BOTTOM PART, FOLLOWED BY YOUR CHOICE OF THE MIDDLE SECTION, AND FINISH WITH THE TOP PART.
ALL PIECES SHOULD SNAP TOGETHER WITHOUT GLUE OR TOOLS.

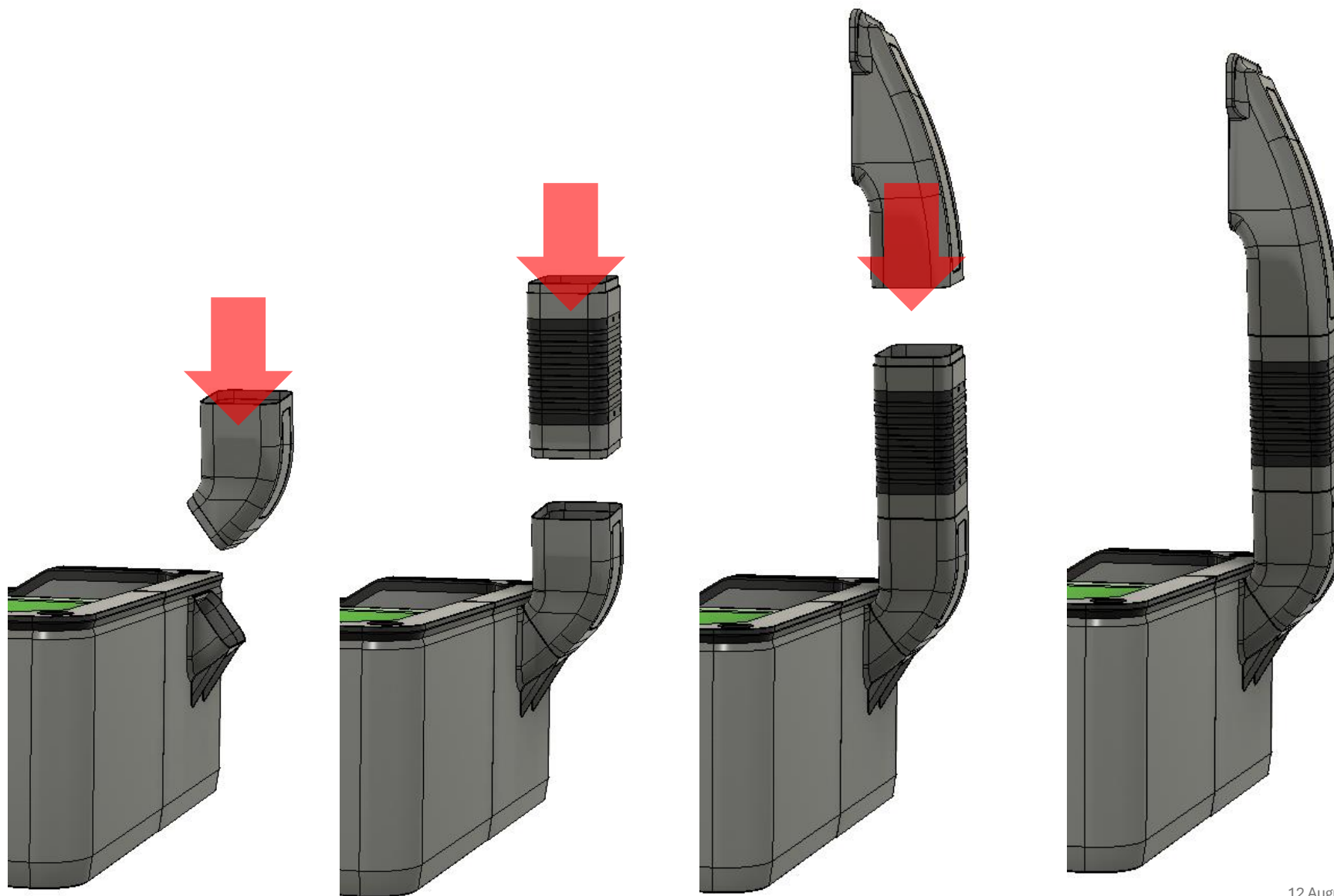



M4 SCREW

0



Tube Connector

0

BACK POOP PIPE

Bambu Lab H2D DRAWER



ONCE THE PRINTER IS PLACED ON TOP OF THE STRUCTURE, MAKE SURE THE PIPE MAGNETS ATTACH TO THE BACK OF THE PRINTER PROPERLY.





M4 SCREW

0



Tube Connector

0

HULA FEET INSTALLATION

Bambu Lab H2D DRAWER



IF YOU WANT TO INSTALL **HULA FEET**, YOU'LL NEED TO USE **FIVE** OF THEM.
INSERT THEM INTO THE HOLES MARKED IN LIGHT BLUE.





Thanks for sticking with me through this assembly guide!

It took me hours to put this guide together, and I truly hope it's been clear and easy to follow.

If there's anything that wasn't super clear or if you feel like something's missing, don't hesitate to reach out.

I'm always here to help and provide any support or clarification you need.

enjoy your new FEATURE!

Ciao!!!



WWW.CC3DPROJECTS.COM

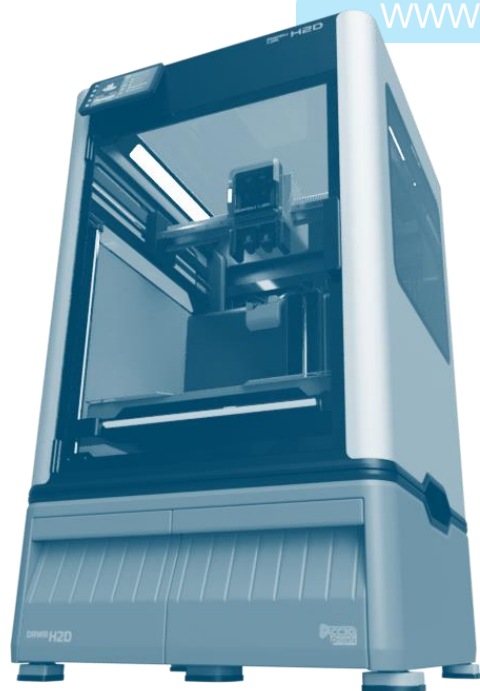

© 2025 CC3DPROJECTS. ALL RIGHTS RESERVED.

THIS MANUAL IS PROTECTED BY COPYRIGHT LAW AND MAY NOT BE REPRODUCED, DISTRIBUTED, OR USED IN WHOLE OR IN PART WITHOUT THE WRITTEN PERMISSION OF THE AUTHOR OR PUBLISHER. ANY VIOLATION WILL BE PROSECUTED TO THE FULLEST EXTENT OF THE LAW.

THE DRAWER BAMBU H2D AND ALL ITS COMPONENTS, INCLUDING BUT NOT LIMITED TO DESIGNS, SCHEMATICS, ASSEMBLY INSTRUCTIONS, AND PHOTOGRAPHS, ARE THE EXCLUSIVE PROPERTY OF ENRICO MAZZAROL AND ARE PROTECTED BY COPYRIGHT LAW AND OTHER INTELLECTUAL PROPERTY LAWS.

COPYING, DISTRIBUTING, MODIFYING, REPRODUCING, TRANSMITTING, OR USING THE HDRY SYSTEM IN ANY FORM WITHOUT THE WRITTEN PERMISSION OF CC3DPROJECTS IS PROHIBITED.

FOR USAGE REQUESTS, PERMISSIONS, OR OTHER INQUIRIES, PLEASE CONTACT CC3DPROJECT@GMAIL.COM.



Bambu Lab *Plate Holder* H2D

BUILD PLATE HOLDER FOR BAMBU LAB H2D

THIS BUILD PLATE HOLDER IS SPECIFICALLY DESIGNED TO FIT DIRECTLY UNDERNEATH THE **BAMBU LAB H2D DRAWER**, CREATING A COMPACT AND EFFICIENT STORAGE SYSTEM FOR PRINT SURFACES.

MAIN FEATURES:

DESIGNED TO FIT UNDER THE H2D DRAWER: MAXIMIZES SPACE BY STACKING STORAGE COMPONENTS.

HOLDS UP TO 3 STANDARD BUILD PLATES AND 1 ENCODER PLATE: KEEPS PLATES ORGANIZED, PROTECTED, AND READY TO USE.

OPTIONAL HULA FEET COMPATIBILITY: SUPPORTS THE INSTALLATION OF HULA FEET FOR ADDED STABILITY AND VIBRATION DAMPENING.

THIS HOLDER HELPS YOU KEEP YOUR WORKSPACE CLEAN AND YOUR BUILD PLATES SAFE, RIGHT WHERE YOU NEED THEM.

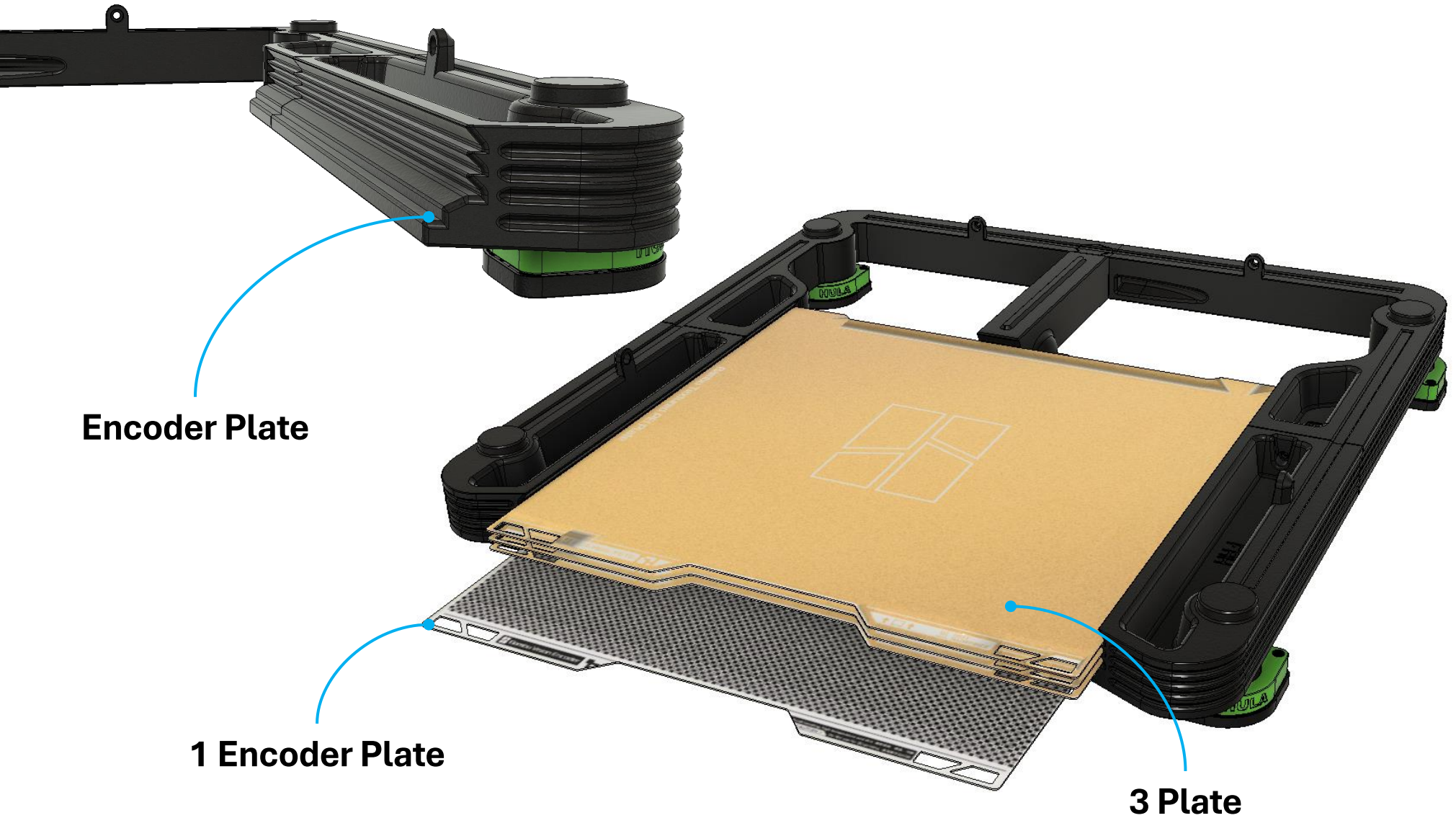



WWW.CC3DPROJECTS.COM

REQUIRED SPARE PARTS:



SCREW M4 14 mm

7 units



Adhesive GASKET

1m

FOLLOW THESE SIMPLE TIPS AND YOU'RE GOLDEN:



1. STICK WITH REGULAR PETG

USE STANDARD PETG, AND SKIP THE HIGH FLOW (HF) STUFF. HF MIGHT SOUND COOL, BUT IT CAN'T HANDLE HEAT AS WELL, AND THAT CAN MESS WITH YOUR PRINT'S DURABILITY. YEAH, REGULAR PETG IS SHINIER — I GET IT — BUT HERE'S A TRICK: SPRAY IT WITH A MATTE CLEAR COAT LIKE I DID. BOOM! PROBLEM SOLVED.



2. DON'T USE PLA FOR SUPPORTS

VOID USING PLA AS SUPPORT MATERIAL. SERIOUSLY. EVEN IF YOU SWITCH FILAMENTS, LEFTOVER PLA IN THE NOZZLE CAN MESS WITH LAYER ADHESION, AND THAT'S NO FUN. AND DON'T STRESS — THE SUPPORTS COME OFF EASY, I PROMISE. YOU GOT THIS.



3. KEEP IT SLOW AND STEADY

RESIST THE URGE TO CRANK UP THE PRINT SPEED. GOING TOO FAST CAN LEAD TO WEIRD-LOOKING CORNERS AND WARPED PARTS. STICK TO STANDARD SPEED — YOUR PRINT WILL THANK YOU.



4. USE A GRIPPY PRINT BED

THESE PARTS ARE ON THE BIGGER SIDE, SO BED ADHESION IS EVERYTHING. MAKE SURE YOUR BUILD PLATE'S GOT A GOOD GRIP TO AVOID WARPING OR LIFTING. TRUST ME, A SOLID FIRST LAYER MAKES ALL THE DIFFERENCE.

WWW.CC3DPROJECTS.COM



M4 SCREW

3



Tube Connector

0

HOLDER MAIN BODY

Bambu Lab H2D DRAWER



BRING THE PARTS TOGETHER AND ALIGN THEM. INSERT SCREWS INTO THE HOLES MARKED IN RED. TIGHTEN THE SCREWS UNTIL YOU FEEL RESISTANCE — DO NOT OVER-TIGHTEN. ONCE THEY START TO FEEL SNUG, YOU'RE PERFECTLY SET!

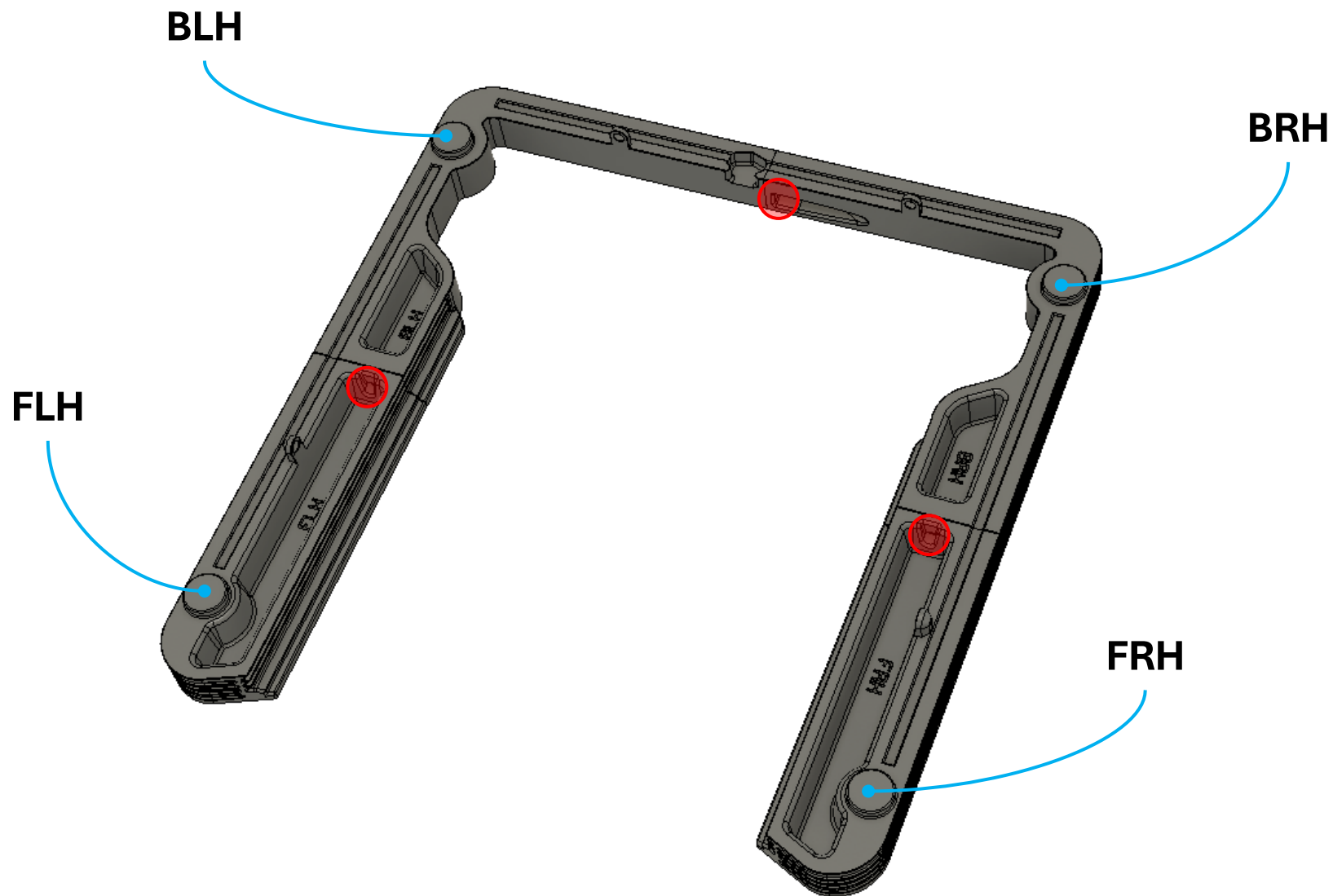



M4 SCREW

0



Tube Connector

0

GASKETS INSTALLATION

Bambu Lab H2D DRAWER



NOW INSTALL THE 6X3MM DOUBLE-SIDED FOAM SEAL INTO THE GROOVES ON THE TOP SIDE. THIS WILL HELP PREVENT CREAKING OR FRICTION BETWEEN PARTS.

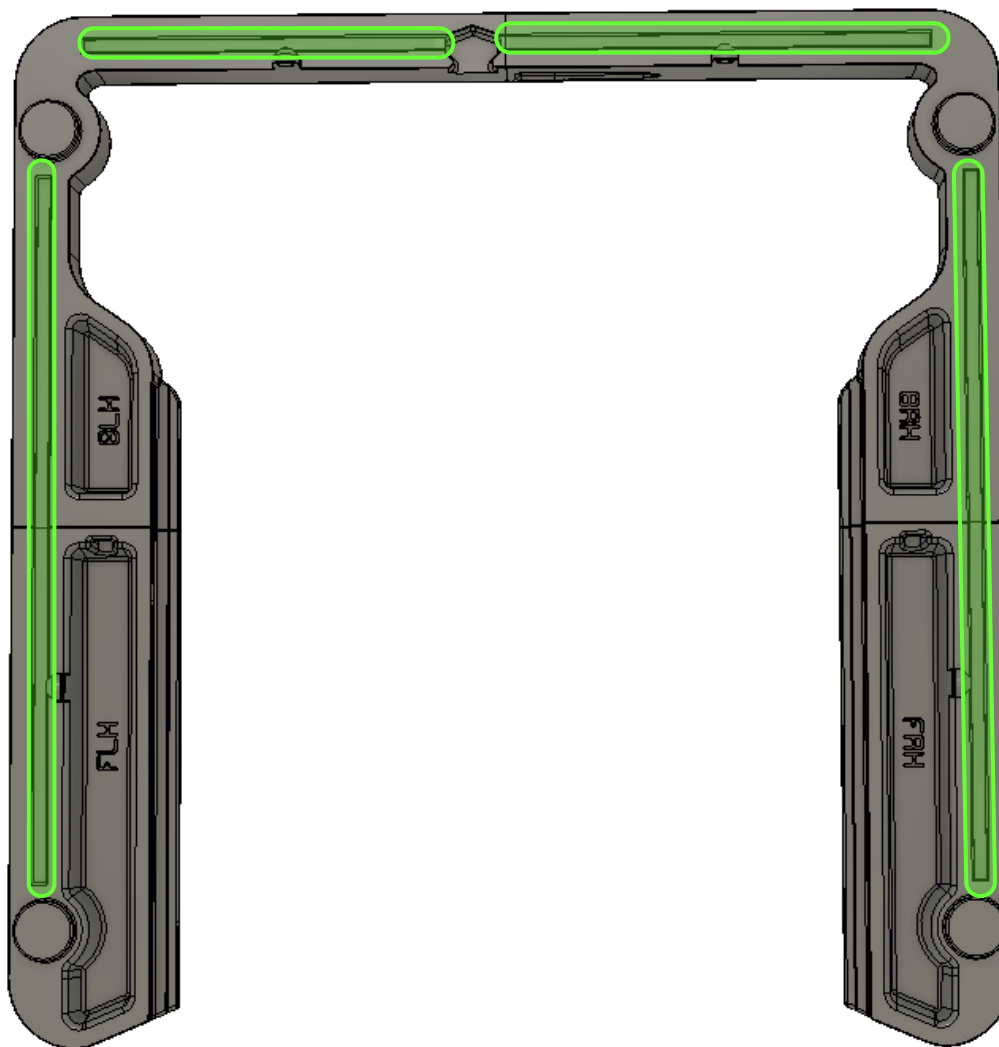



M4 SCREW

0



Tube Connector

0

MIDDLE PIECE INSTALLATION

SNAP THE REAR CENTER PIECE INTO PLACE.

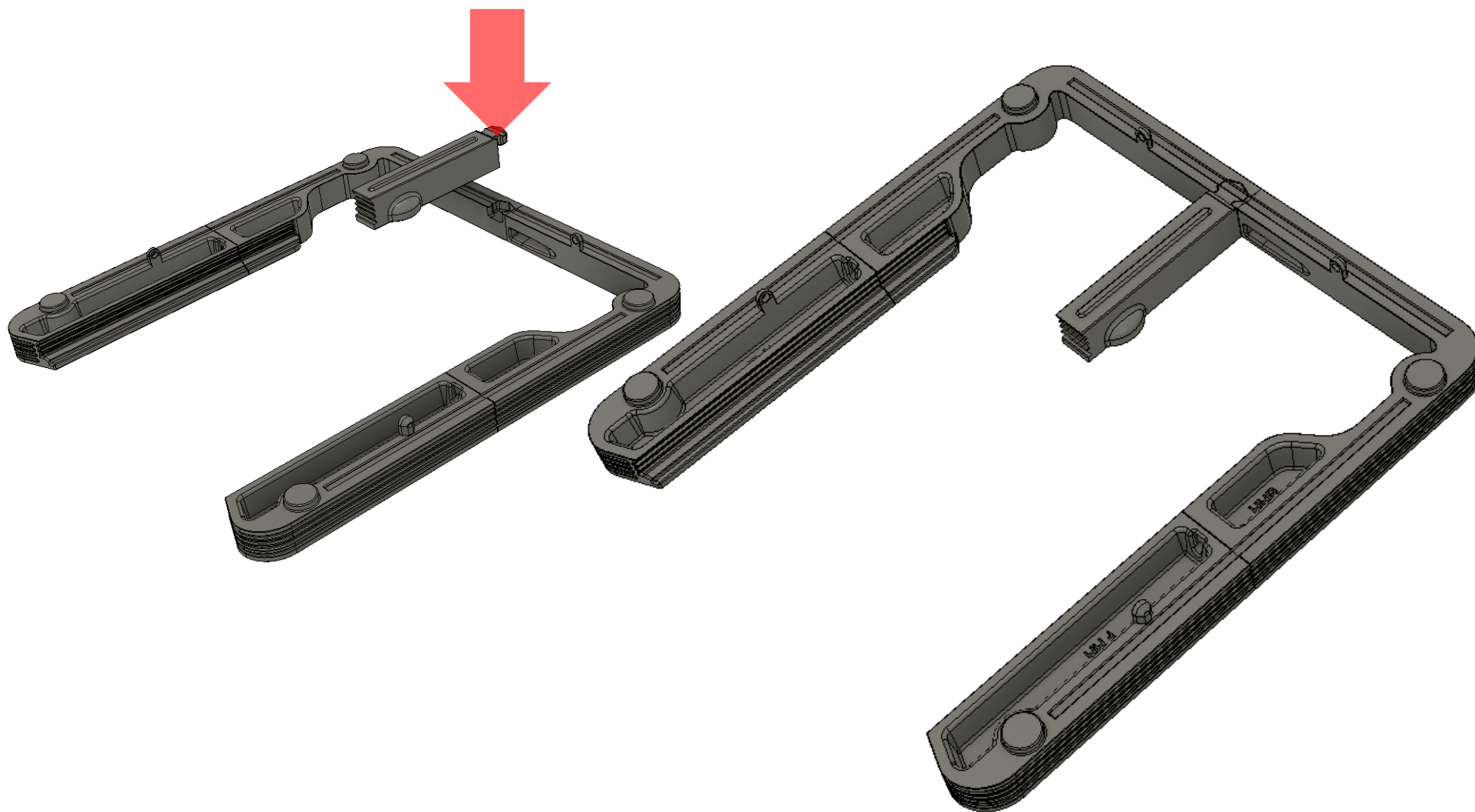



M4 SCREW

4



Tube Connector

0

WEDDING DRAWER – PLATE HOLDER

ENCLOSURE A1



PLACE THE DRAWER ON TOP OF THE PLATE HOLDER AND SNAP THEM TOGETHER.
SECURE THEM BY INSERTING SCREWS INTO THE HOLES MARKED IN RED.

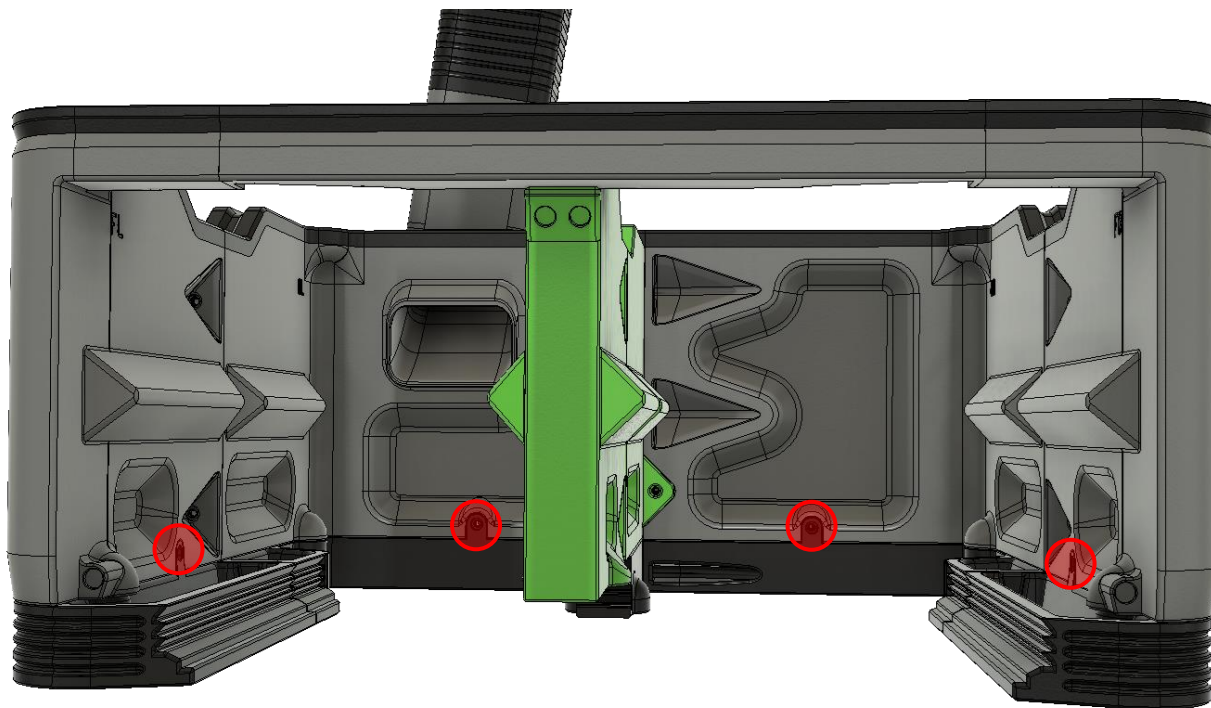
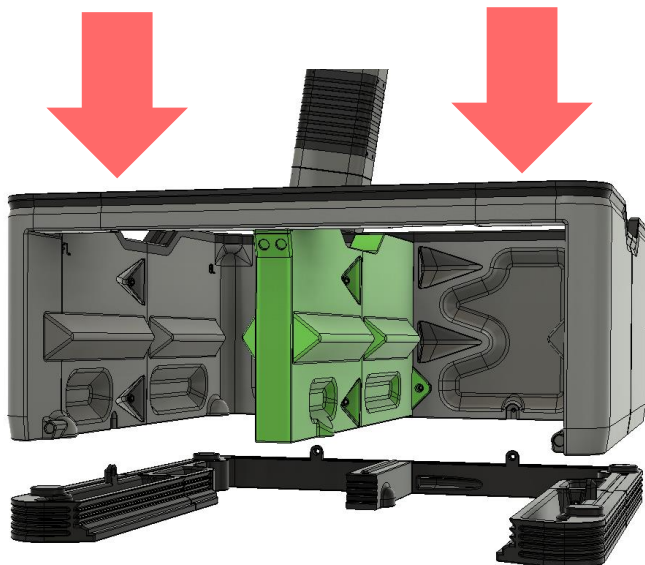



M4 SCREW

0



Tube Connector

0

HULA FEET INSTALLATION

Bambu Lab H2D DRAWER



IF YOU WANT TO INSTALL THE HULA FEET, PAY CLOSE ATTENTION AND INSERT THE FEET INTO THE HOLES MARKED IN LIGHT BLUE.

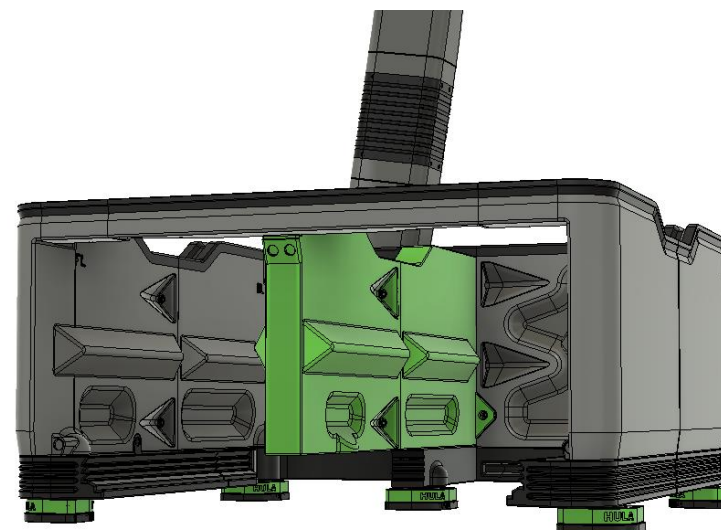



Thanks for sticking with me through this assembly guide!

It took me hours to put this guide together, and I truly hope it's been clear and easy to follow.

If there's anything that wasn't super clear or if you feel like something's missing, don't hesitate to reach out.

I'm always here to help and provide any support or clarification you need.

enjoy your new FEATURE!

Ciao!!!



WWW.CC3DPROJECTS.COM



© 2025 CC3DPROJECTS. ALL RIGHTS RESERVED.

THIS MANUAL IS PROTECTED BY COPYRIGHT LAW AND MAY NOT BE REPRODUCED, DISTRIBUTED, OR USED IN WHOLE OR IN PART WITHOUT THE WRITTEN PERMISSION OF THE AUTHOR OR PUBLISHER. ANY VIOLATION WILL BE PROSECUTED TO THE FULLEST EXTENT OF THE LAW.

THE PLATE HOLDER BAMBU LAB H2D AND ALL ITS COMPONENTS, INCLUDING BUT NOT LIMITED TO DESIGNS, SCHEMATICS, ASSEMBLY INSTRUCTIONS, AND PHOTOGRAPHS, ARE THE EXCLUSIVE PROPERTY OF ENRICO MAZZAROL AND ARE PROTECTED BY COPYRIGHT LAW AND OTHER INTELLECTUAL PROPERTY LAWS.

COPYING, DISTRIBUTING, MODIFYING, REPRODUCING, TRANSMITTING, OR USING THE HDRI SYSTEM IN ANY FORM WITHOUT THE WRITTEN PERMISSION OF CC3DPROJECTS IS PROHIBITED.

FOR USAGE REQUESTS, PERMISSIONS, OR OTHER INQUIRIES, PLEASE CONTACT CC3DPROJECT@GMAIL.COM.