

WWW.CC3DPROJECTS.COM

BAMBU H2D/H2S RAIZER

RAIZER FOR BAMBU LAB H2D / H2S

ELEVATE YOUR PRINTER. ENHANCE YOUR EXPERIENCE.

THE RAIZER FOR BAMBU LAB H2D - H2S IS DESIGNED TO EXPAND THE FUNCTIONALITY AND ERGONOMICS OF YOUR PRINTER, BRINGING GREATER CONVENIENCE, ORGANIZATION, AND STYLE TO YOUR 3D PRINTING SETUP.

KEY FEATURES:

🌀 FLEXIBLE SPOOL MANAGEMENT: SUPPORTS TWO 1 KG SPOOLS OR ONE 3 KG SPOOL MOUNTED ON TOP OF THE RAIZER, ENSURING STABLE AND TIDY FILAMENT FEEDING.

🔧 OPTIMIZED FOR TPU: SPECIFICALLY DESIGNED TO HANDLE TPU FILAMENTS, ENSURING SMOOTH, UNINTERRUPTED FLOW.

💡 INTEGRATED LIGHTING: A PERIMETER LED STRIP ELEGANTLY ILLUMINATES THE AREA AROUND YOUR PRINTER, IMPROVING BOTH VISIBILITY AND AESTHETICS.

🔩 ORIGINAL GLASS REMOVAL SYSTEM: INCLUDES PINS FOR MANAGING THE TOP GLASS REMOVAL, JUST LIKE THE ORIGINAL BAMBU LAB DESIGN.

THE RAIZER COMBINES FUNCTIONALITY, DESIGN, AND ATTENTION TO DETAIL IN ONE ESSENTIAL ACCESSORY FOR ANYONE LOOKING TO TAKE THEIR BAMBU LAB PRINTER TO THE NEXT LEVEL.



KEY CARATERISTICS

BAMBU H2D/H2S RAISER



RAISER CLOSED
IN STANDARD SETUP



SETUP WITH
2 POOLS (1KG EACH)

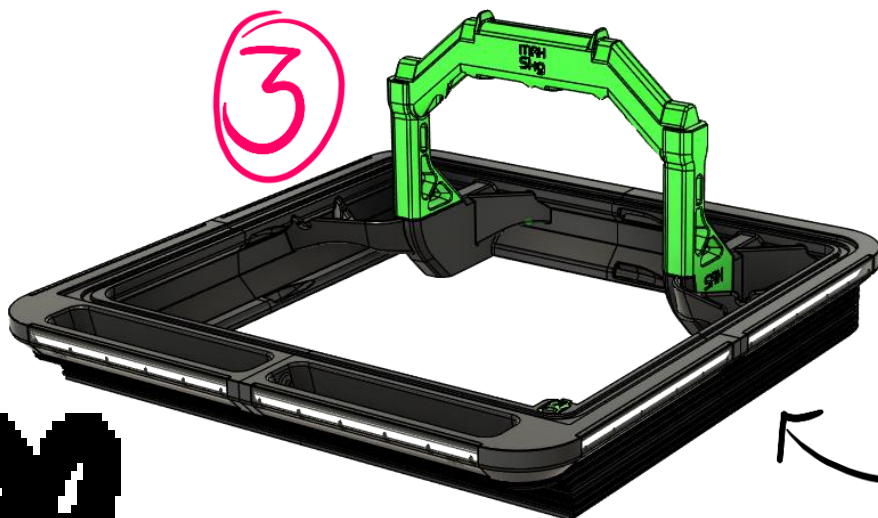
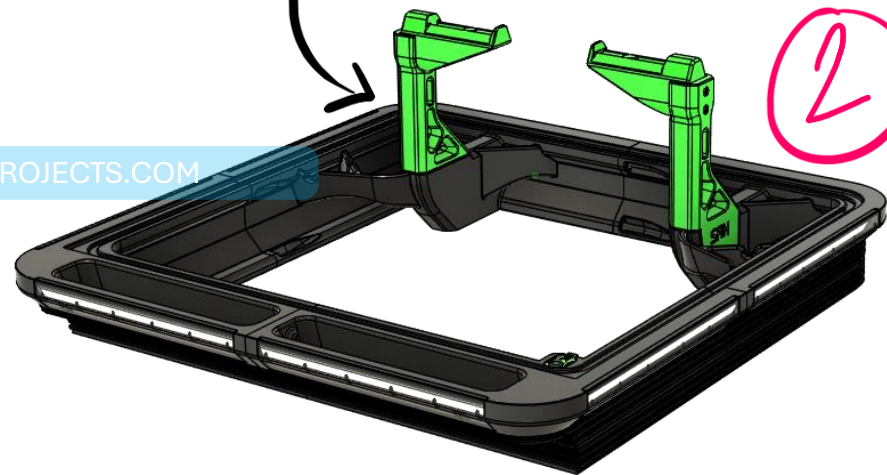

SETUP WITH
1 SPOOL (3KG)

WWW.CC3DPROJECTS.COM

KEY CARATERISTICS

BAMBU H2D/H2S RAISER

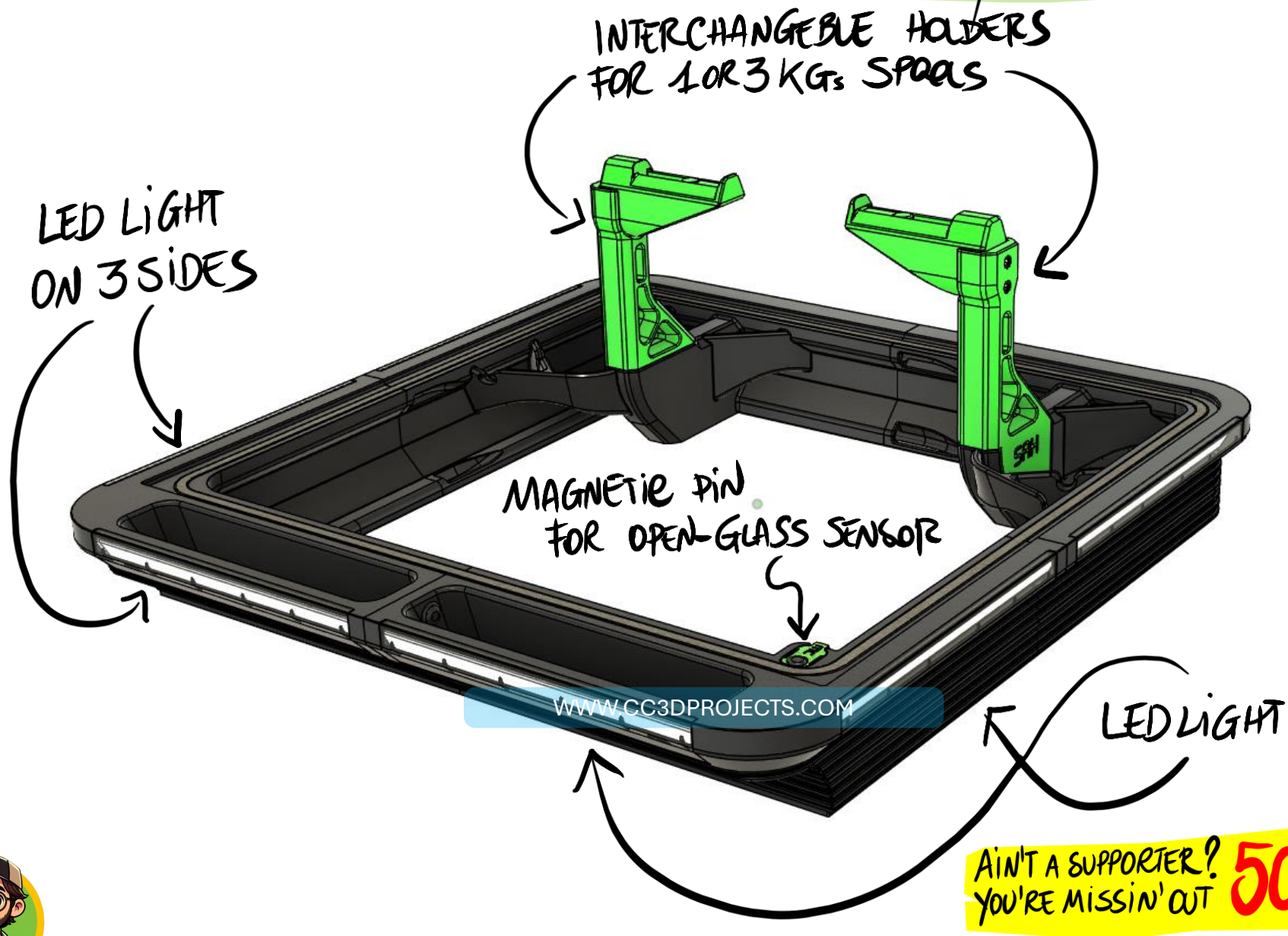

KEY CHARACTERISTICS

BAMBU H2D/H2S RAISER



OPEN-GLASS
SENSOR SETUP

KEY CHARACTERISTICS

// WHEN THE GLASS IS REMOVED,
THE PIN RISES AND BREAK
CONTACT WITH THE PRINTER'S SENSOR //

SPRING

COVER

PIN

MAGNET

WWW.CC3DPROJECTS.COM



KEY CARATERISTICS

BAMBU H2D/H2S RAISER



YOU WON'T LOSE ACCESS TO USB PORT
OR THE BUTTON, EVEN TO OPEN THE
FRONT AIR VENT OF THE PRINTER

YOU SEE?

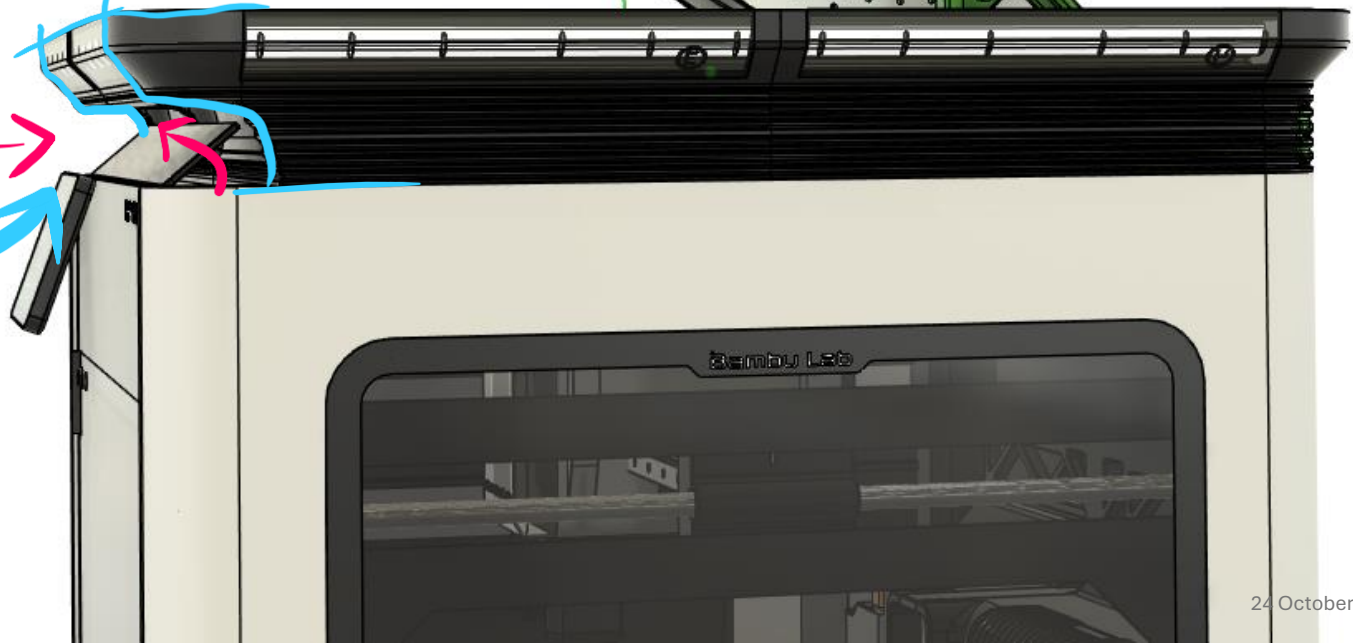
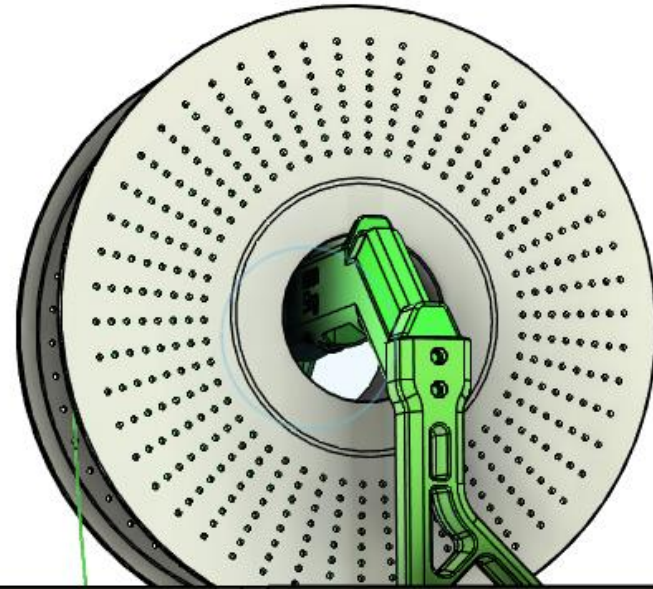

KEY CARATERISTICS

BAMBU H2D/H2S RAISER



GADGET BOX

YOU'LL NEATLY MANAGE
THE RAISER'S ADDITIONAL PARTS

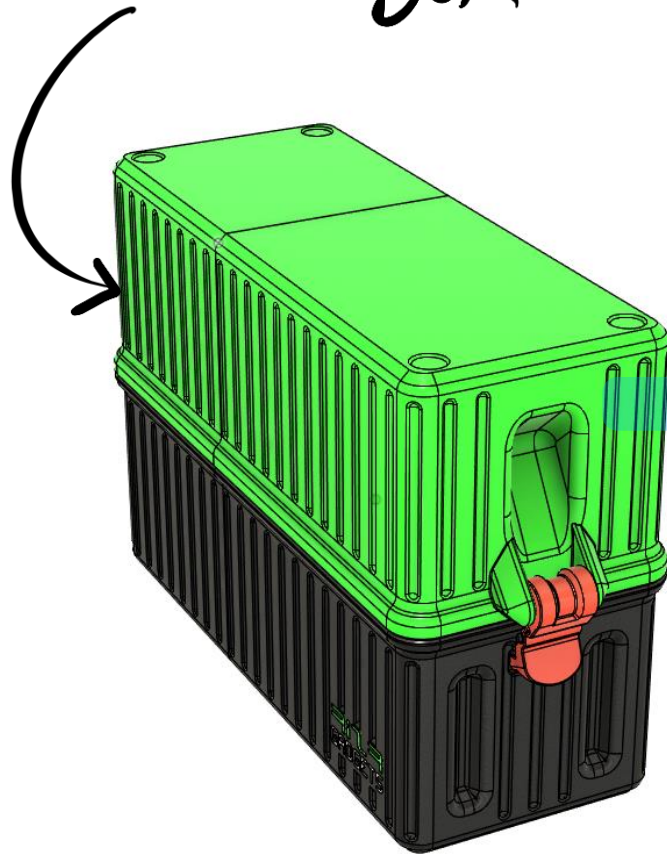

WWW.CC3DPROJECTS.COM

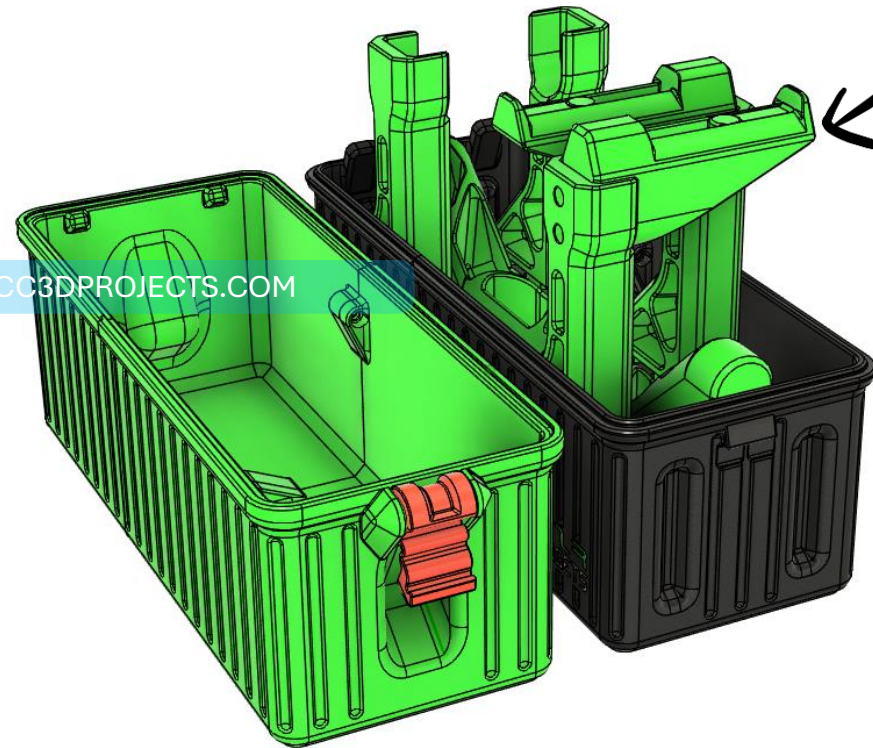

AIN'T A SUPPORTER?
YOU'RE MISSIN' OUT **50% OFF**
ALL MY MODELS

Raiser:

→ FILAMENTS:

- PETG GRAY 1.5 KG
- PETG GREEN 260 G
- PETG TRANSPARENT 165 G
(FOR LED COVERS)
- TPU GREEN 3 G

→ PRINT TIME = 2D 15 H 31 M

GADGET BOX:

WWW.CC3DPROJECTS.COM

→ FILAMENTS:

- PETG BLACK 450 G
- PETG GREEN 310 G
- PETG RED 10 G
- PETG WHITE 3 G

→ PRINT TIME = 23 H 25 M

REQUIRED HARDWARE:



SCREW M14 x 14mm 19 UNITS



MAGNET 8x2 mm 1 UNIT

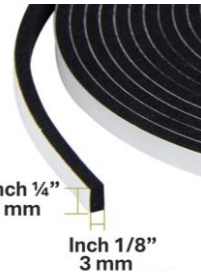

ADHESIVE GASKET 1 m



SPRING
DIAMETER = 5 mm
THICKNESS = 0.5 mm
HEIGHT = 15 mm
1 UNIT

SILICONE FEET 4 UNITS



TIPS 4 FLAWLESS PRINTS

BAMBU H2D/H2S RAISER



FOLLOW THESE SIMPLE TIPS AND YOU'RE GOLDEN:



1. STICK WITH REGULAR PETG

USE STANDARD PETG, AND SKIP THE HIGH FLOW (HF) STUFF. HF MIGHT SOUND COOL, BUT IT CAN'T HANDLE HEAT AS WELL, AND THAT CAN MESS WITH YOUR PRINT'S DURABILITY. YEAH, REGULAR PETG IS SHINIER — I GET IT — BUT HERE'S A TRICK: SPRAY IT WITH A MATTE CLEAR COAT LIKE I DID. BOOM! PROBLEM SOLVED.



2. DON'T USE PLA FOR SUPPORTS

IF YOU ARE USING A SINGLE NOZZLE PRINTER WITH A COLOR CHANGE SYSTEM, VOID USING PLA AS SUPPORT MATERIAL. SERIOUSLY. EVEN IF YOU SWITCH FILAMENTS, LEFTOVER PLA IN THE NOZZLE CAN MESS WITH LAYER ADHESION, AND THAT'S NO FUN. AND DON'T STRESS — THE SUPPORTS COME OFF EASY, I PROMISE. **YOU GOT THIS.**



3. KEEP IT SLOW AND STEADY

RESIST THE URGE TO CRANK UP THE PRINT SPEED. GOING TOO FAST CAN LEAD TO WEIRD-LOOKING CORNERS AND WARPED PARTS. STICK TO STANDARD SPEED — YOUR PRINT WILL THANK YOU.

WWW.CC3DPROJECTS.COM



4. USE A GRIPPY PRINT BED

THESE PARTS ARE ON THE BIGGER SIDE, SO BED ADHESION IS EVERYTHING. MAKE SURE YOUR BUILD PLATE'S GOT A GOOD GRIP TO AVOID WARPING OR LIFTING. TRUST ME, A SOLID FIRST LAYER MAKES ALL THE DIFFERENCE.

SLICER PRINT SETTINGS:

WALL LOOPS = 2
TOP SHELL = 2
BOTTOM SHELL = 2

SPARSE INFILL = 10%
INFILL PATTERN = GYROID

SUPPORT TYPE = TREE OR NORMAL/MIXED

DIFFERENT PARTS = DIFFERENT STRENGTH

(PERIMETERS, INFILL AND SUPPORTS MIGHT VARY, HOWEVER, ALL THE PROPER CONFIGURATIONS SHOULD BE INCLUDED IN THE PRINT FILE!)



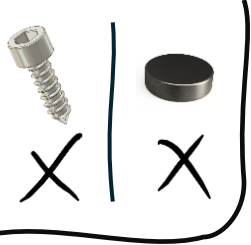

FRAME ASSEMBLY

BAMBU H2D/H2S RAISER

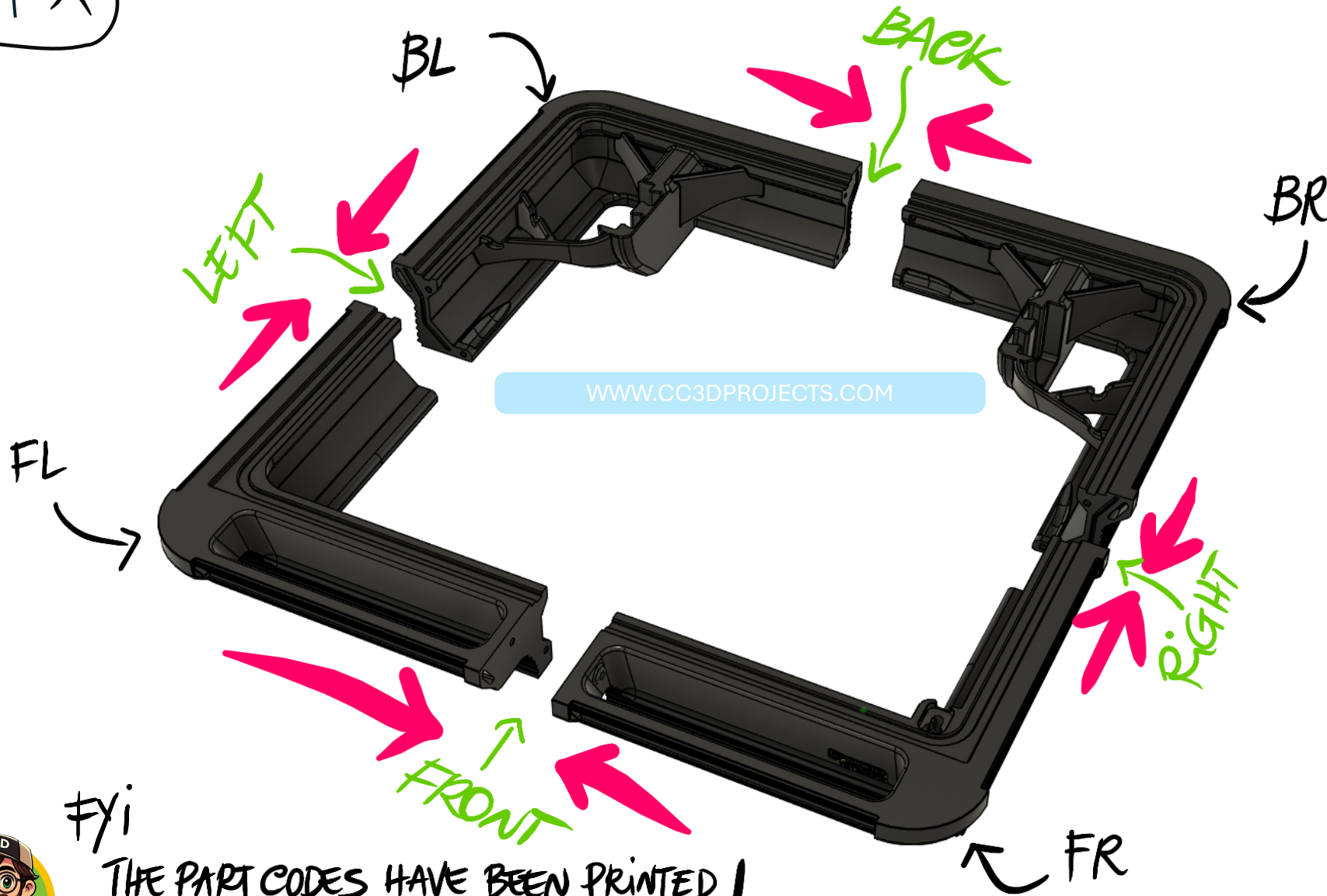

Fyi

THE PART CODES HAVE BEEN PRINTED ON EACH PIECE - TAKE A LOOK!





FRAME ASSEMBLY LEFT SIDE

BAMBU H2D/H2S RAISER



PUT A SCREW IN EACH OF THE HOLES MARKED IN RED...

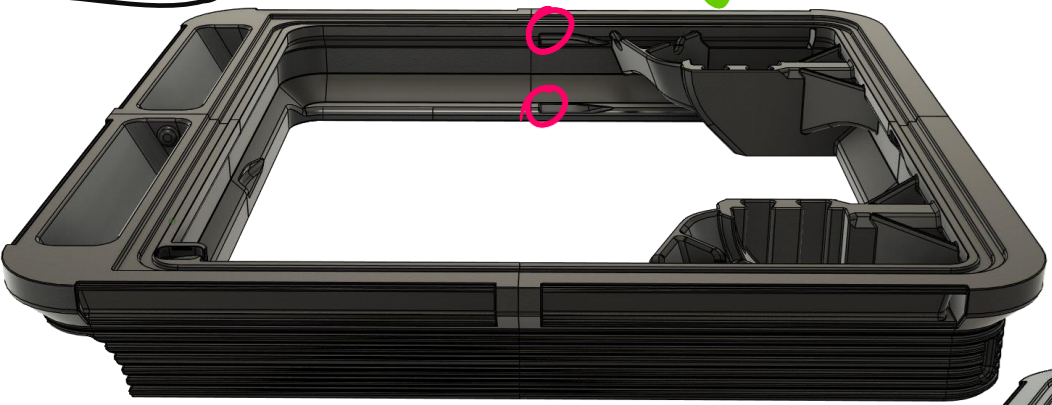

BACK SIDE

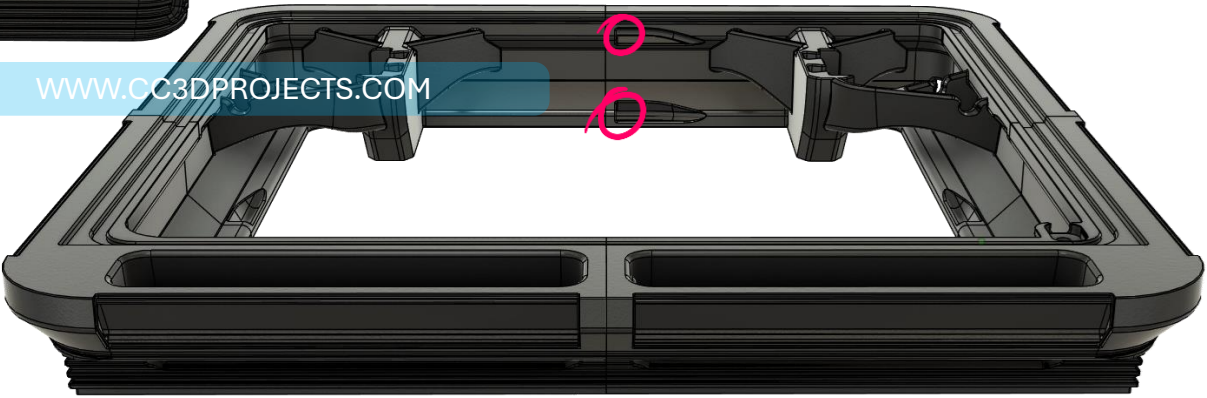

...TIGHTEN THEM UP, BUT DON'T GO OVERBOARD, OKAY?

RIGHT SIDE

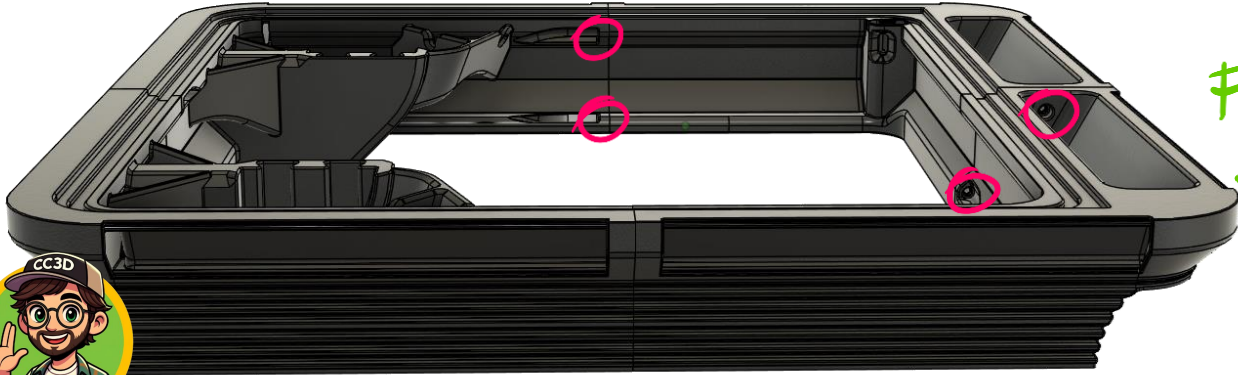

FRONT SIDE



WWW.CC3DPROJECTS.COM

ALL MATERIAL PRODUCED AND PROVIDED HAS BEEN CONCEIVED, AUTHORED AND PRODUCED BY ENRICO MAZZAROL - ALL RIGHTS RESERVED.

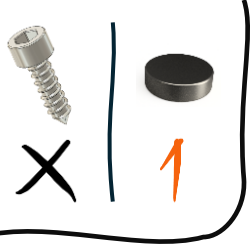

HARDWARE SETUP

BAMBU H2D/H2S RAISER



NO WORRIES!
IT'S A STANDARD SPRING,
EASY TO FIND ONLINE.
COLOR DOESN'T MATTER!

SPRING



CAP

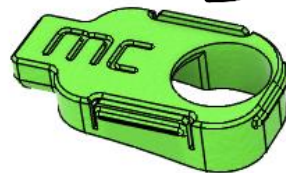

WWW.CC3DPROJECTS.COM

PIN



IN THIS HOLE, YOU'LL NEED TO INSTALL A MAGNET.
BEFORE GIVING IT IN PLACE, MAKE SURE ITS
POLARITY IS ALIGNED WITH THE ONE ATTACHED TO THE PRINTER'S TOP GLASS!



AIN'T A SUPPORTER?
YOU'RE MISSIN' OUT **50% OFF** ALL MY MODELS

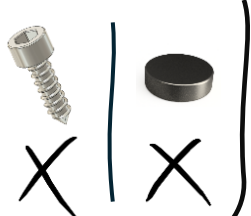

PIN ASSEMBLY

BAMBU H2D/H2S RAISER

1

INSERT THE SPRING INTO THE SMALLER HOLE - THE ONE WHERE YOU CAN SEE A PIN AT THE BOTTOM.

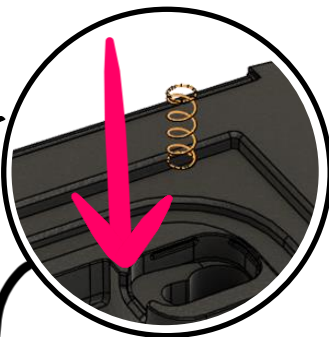

2

INSERT THE PIN AS SHOWN IN THE PICTURE

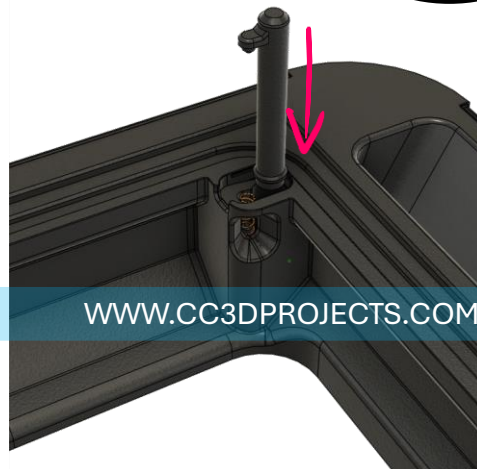

3

CLOSE EVERYTHING UP WITH THE CAP LIKE THIS

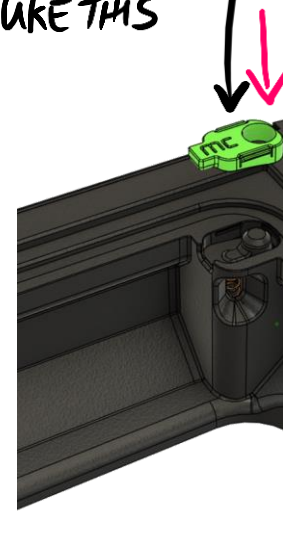
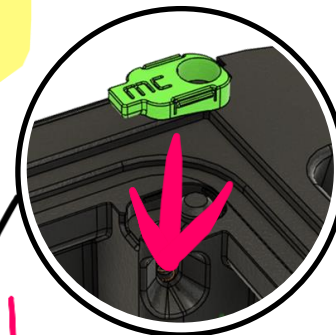

WWW.CC3DPROJECTS.COM



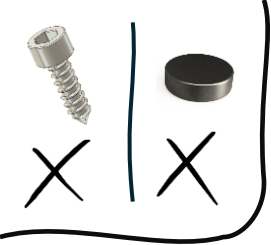

GASKET TIME

BAMBU H2D/H2S RAISER

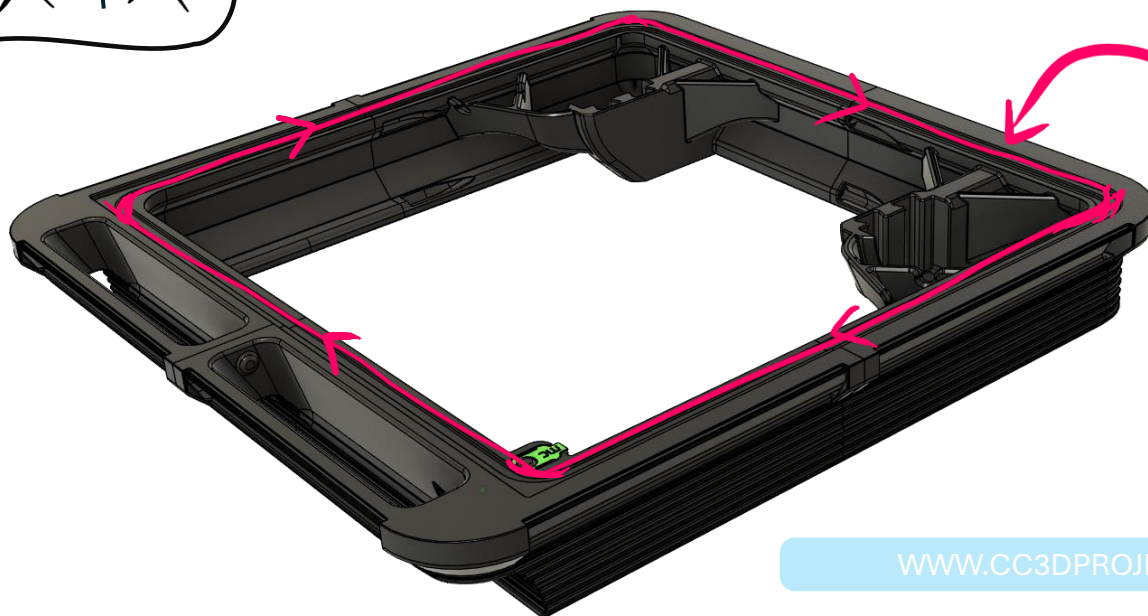

INSERT THE GASKET INTO THE GROOVE ALL AROUND THE RAISER PERIMETER

HERE'S THE GROOVE

WWW.CC3DPROJECTS.COM

THIS SHOULD BE THE FINAL RESULT.



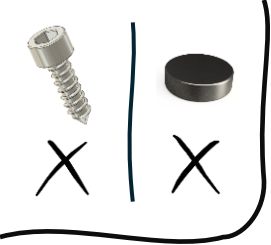

LED STRIP INSTALLATION

BAMBU H2D/H2S RAISER



STARTING FROM THE BACK RIGHT CORNER, A HOLE, BEGIN INSERTING THE LED STRIP ALL AROUND THE RAISER.

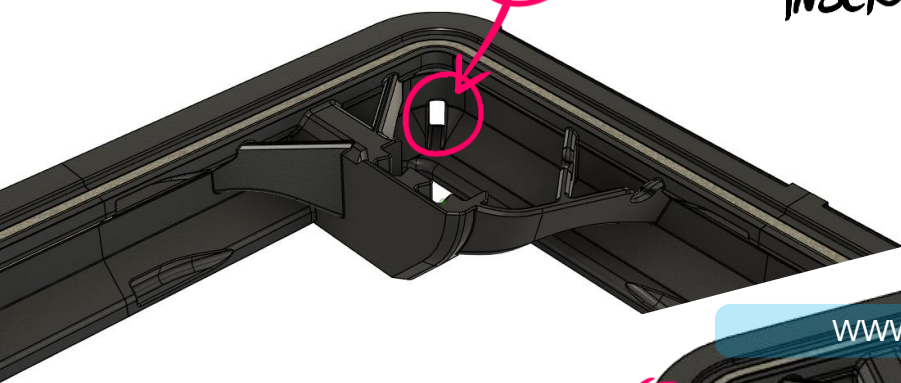

WWW.CC3DPROJECTS.COM



B

AT "EDGE B," YOU'LL FIND A HOLE WHERE YOU CAN TUCK ANY EXCESS STRIP

KEEP FEEDING THROUGH UNTIL THE POWER CABLE GOES INTO HOLE A, THEN CUT THE STRIP AS CLOSE AS POSSIBLE TO THE OPPOSITE EDGE B.

ONCE THAT'S DONE, STICK THE STRIP INTO THE GROOVE TO FINISH THE JOB.



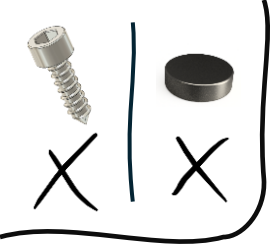

LED STRIP INSTALLATION

BAMBU H2D/H2S RAISER



HERE'S HOW THE BARK RIGHT CORNER SHOULD LOOK

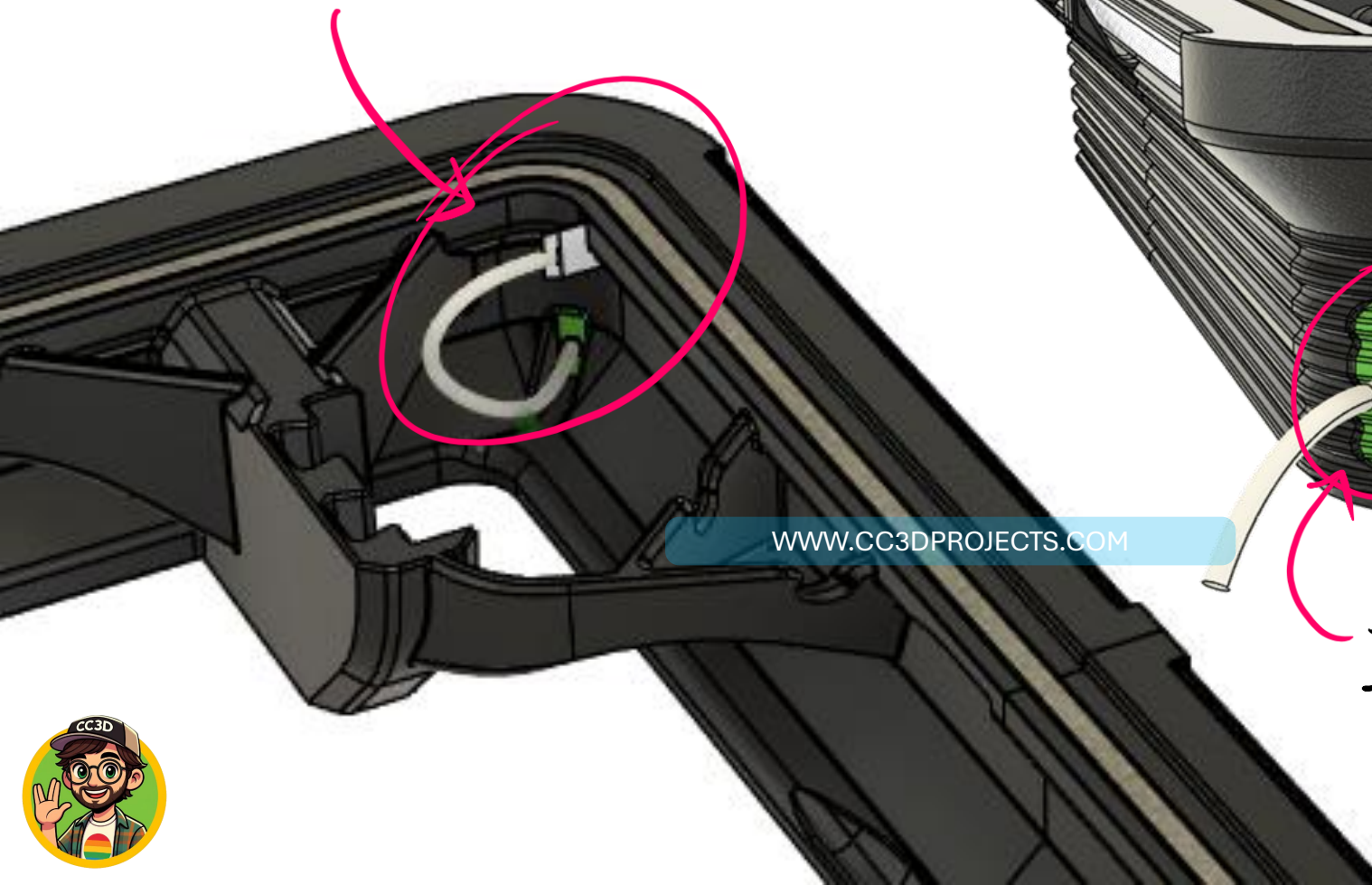

WWW.CC3DPROJECTS.COM



PLACE THE TPU CAP
TO SECURE THE CABLE



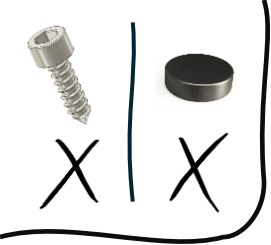

LED GLASS INSTALLATION

BAMBU H2D/H2S RAISER



TO INSTALL THE GLASS PANEL, FOLLOW THIS LAYOUT
EACH PANEL HAS ITS NUMBER MARKED DIRECTLY ON IT

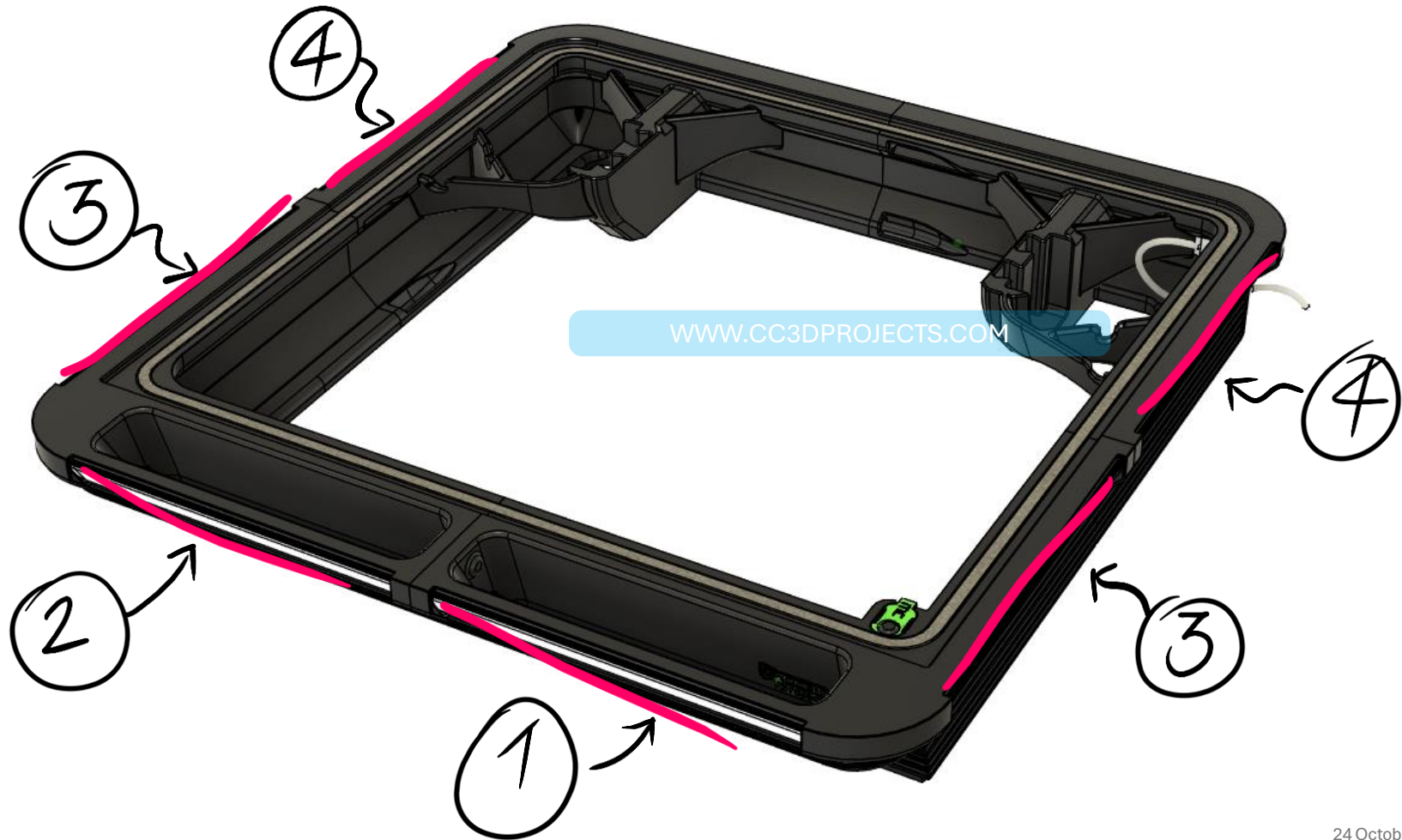

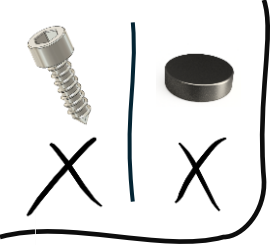

LED GLASS INSTALLATION

BAMBU H2D/H2S RAISER



SLIDE THE GLASS PANEL INTO THE LOWER GROOVE

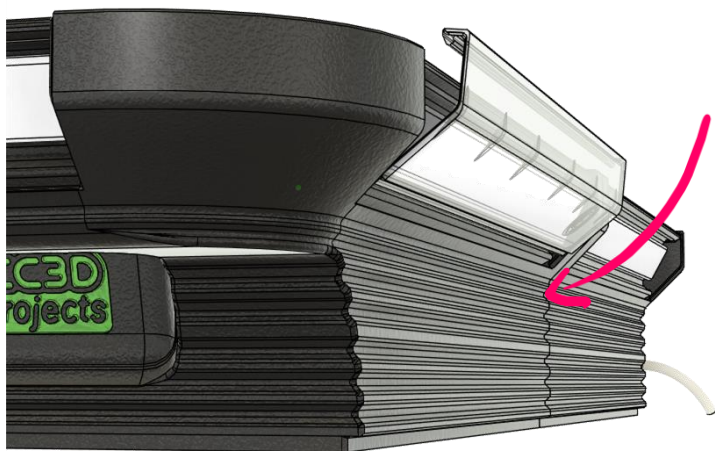

ROTATE IT UNTILL IT SNAPS INTO PLACE AT THE TOP

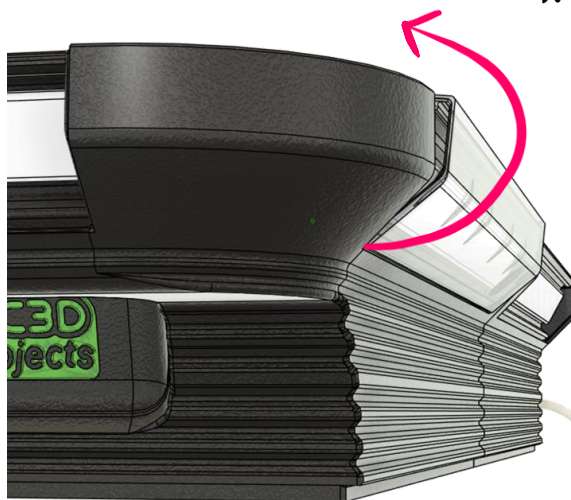

WWW.CC3DPROJECTS.COM

REPEAT THESE STEPS FOR ALL THE 6 GLASS PANELS, MAKING SURE TO FOLLOW THE NUMBERING.

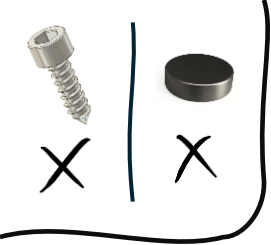

LET'S FINALIZE

BAMBU H2D/H2S RAISER



NOW PLACE YOUR NEW RAISER AND SET THE GLASS ON TOP...
YOU'RE ALL SET TO ENJOY YOUR NEW MOD!

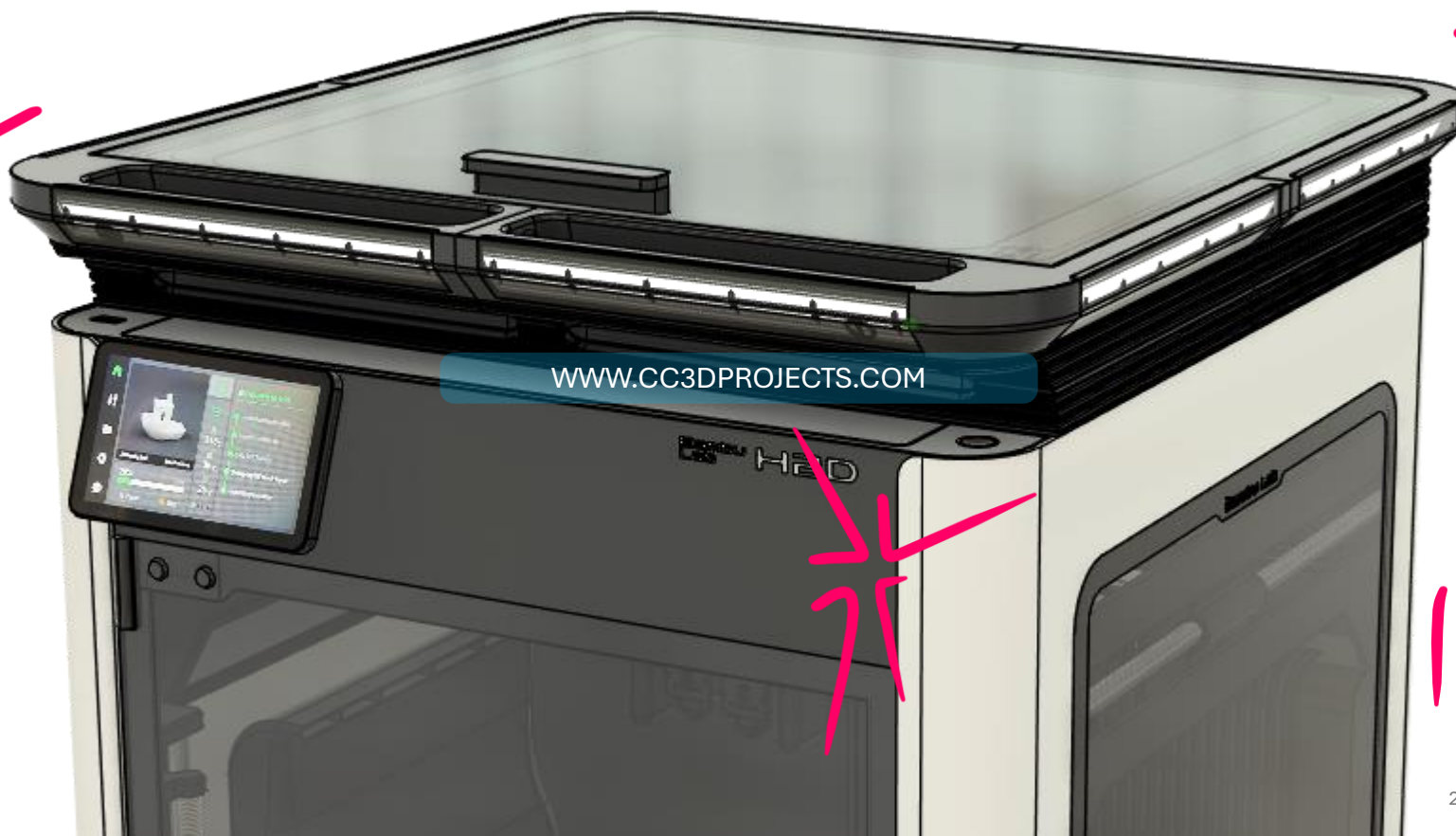

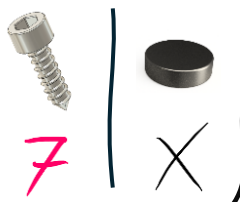

TIME 4 GADGET BOX

BAMBU H2D/H2S RAISER



BRING THE PIECES TOGETHER AS SHOWN BELOW
AND SECURE THEM WITH SCREWS INSERTED IN THE
HOLES HIGHLIGHTED IN RED

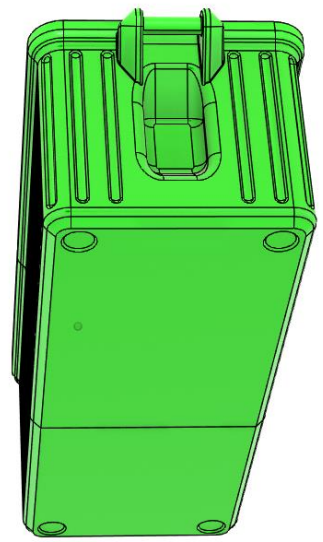
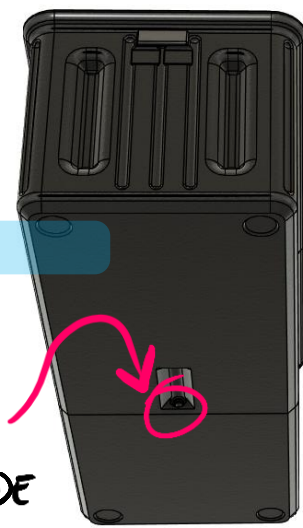
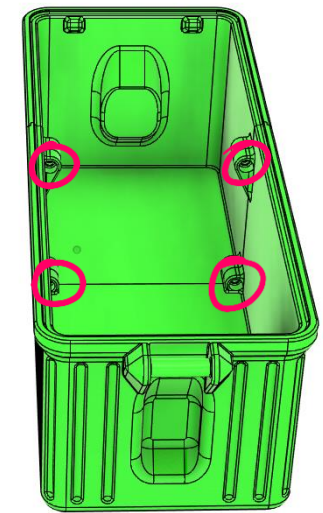
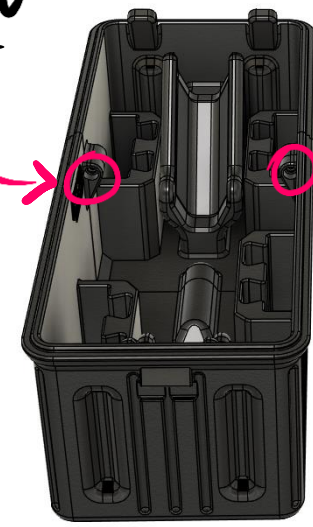
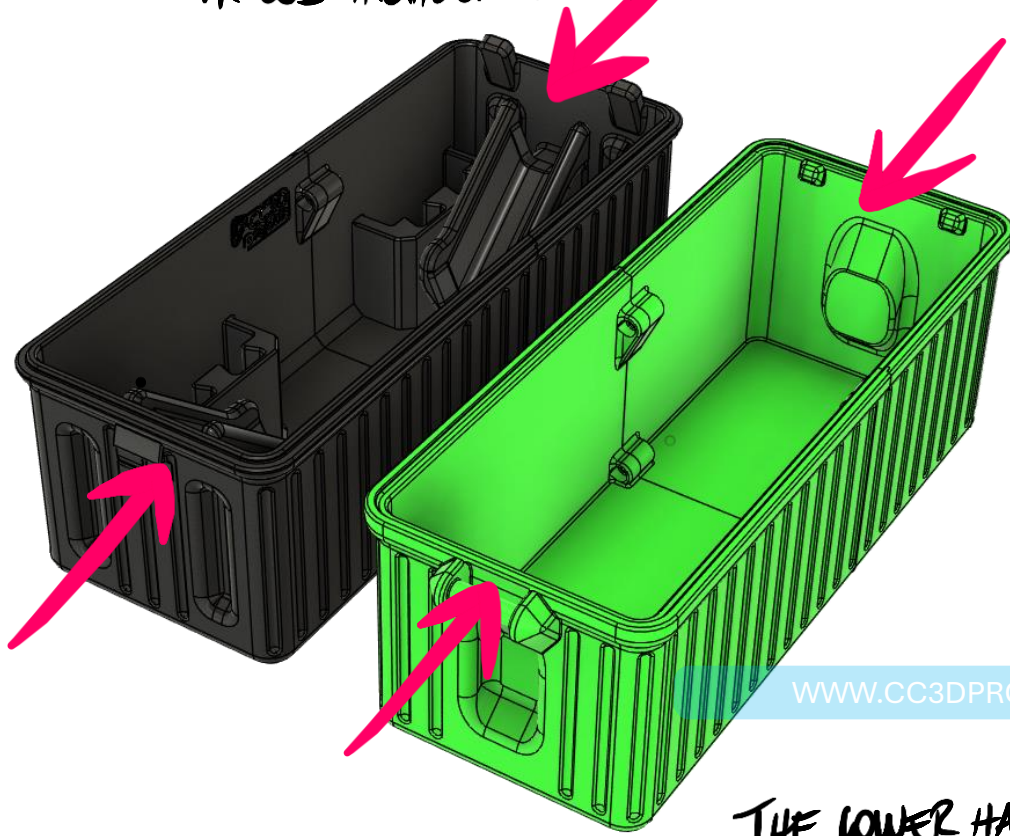

WWW.CC3DPROJECTS.COM

THE LOWER HALF OF THE
BOX HAS AN EXTERNAL
SCREW ON THE BOTTOM SIDE



ALL MATERIAL PRODUCED AND PROVIDED HAS BEEN CONCEIVED, AUTHORED AND PRODUCED BY ENRICO MAZZAROL - ALL RIGHTS RESERVED.

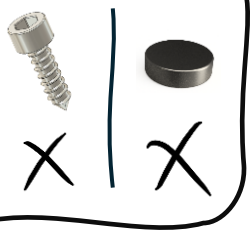

TIME 4 GADGET BOX

BAMBU H2D/H2S RAISER



LET'S ATTACH THE BOX'S LOCKING LATCH

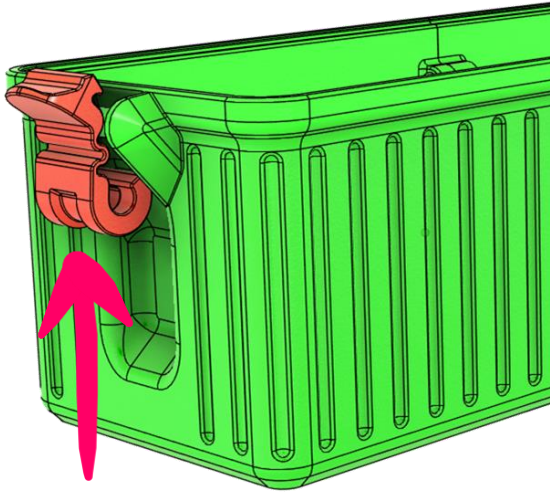

INSERT IT FROM THE BOTTOM UNTIL YOU FEEL A "TACK"

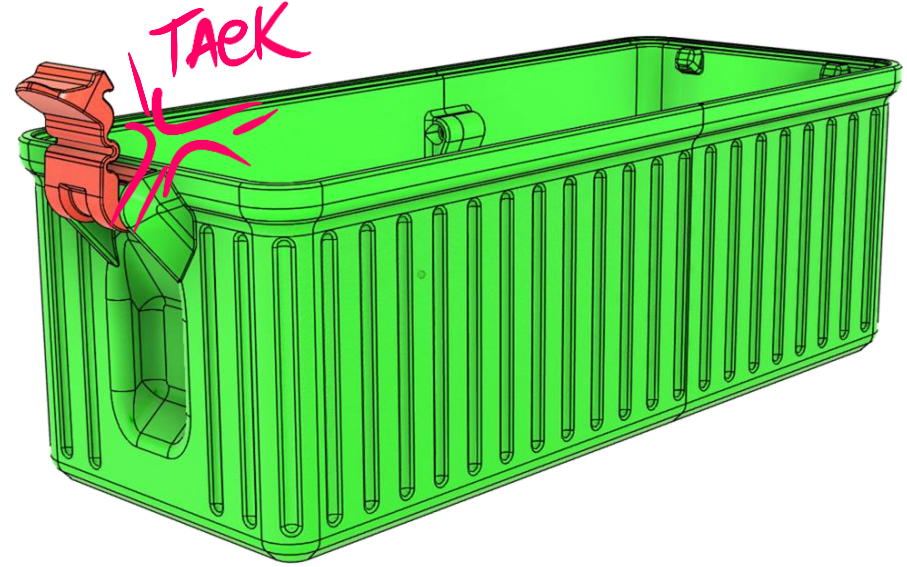

WWW.CC3DPROJECTS.COM

THE CUTOUTS ON THE UNDERSIDE OF THE BOX ARE MEANT FOR ADDING NON-SLIP SILICONE FEET.

CHOOSE WHICHEVER ONES YOU LIKE; THESE ARE COUNTLESS OPTIONS ONLINE!



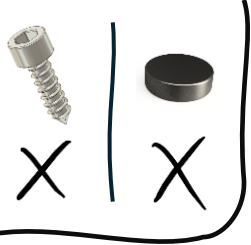

SPOOL SUPPORT ASSEMBLY

BAMBU H2D/H2S RAISER

PUT A SCREW IN EACH OF
THE HOLES MARKED IN RED

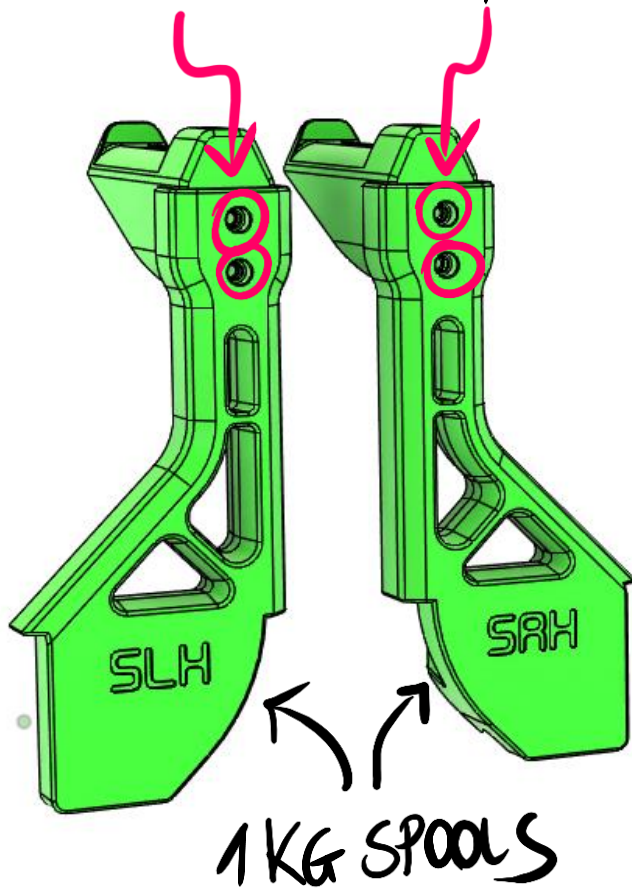

1KG SPOOLS

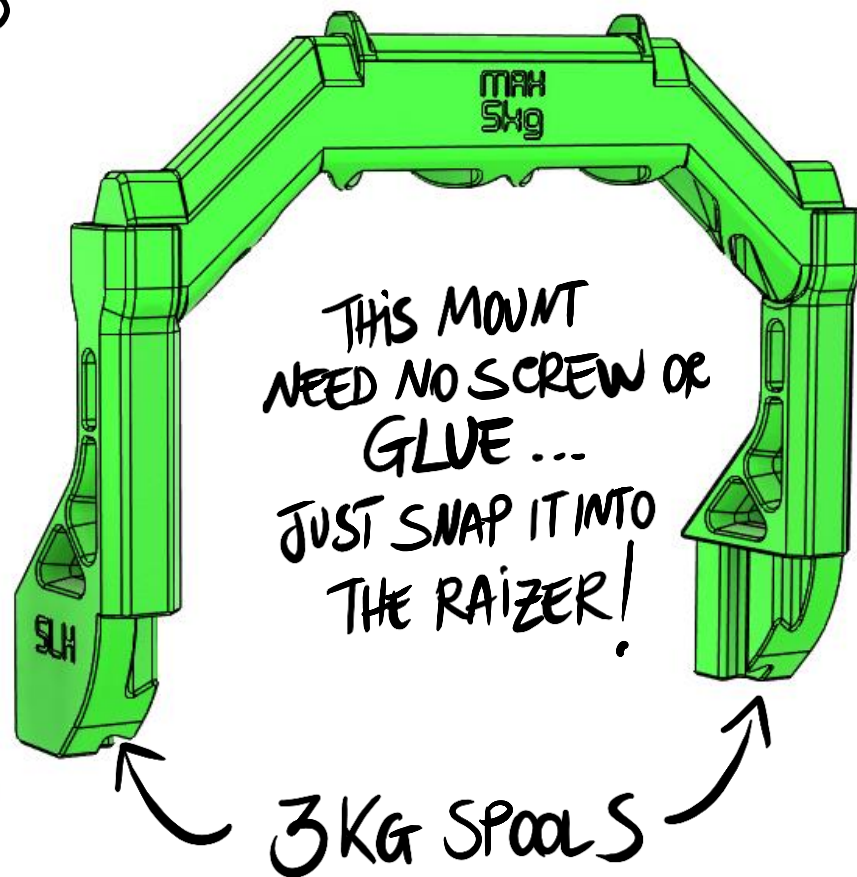

THIS MOUNT
NEED NO SCREW OR
GLUE ...
JUST SNAP IT INTO
THE RAISER!

3KG SPOOLS



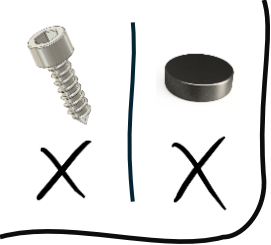

TIME 4 GADGET BOX

BAMBU H2D/H2S RAISER



NOW INSERT THE RAISER PART INTO THE BOX FOLLOWING THIS LAYOUT

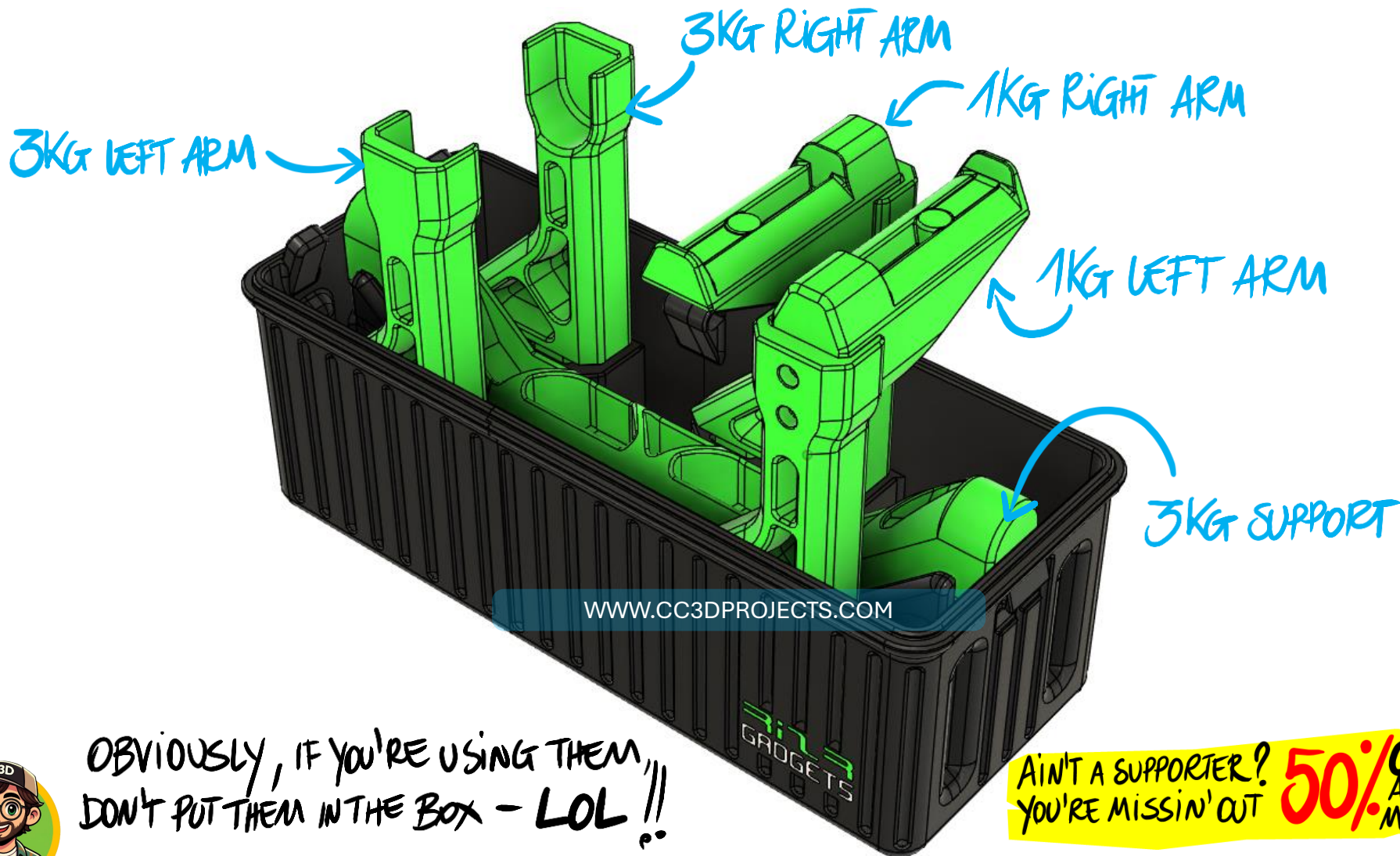

WWW.CC3DPROJECTS.COM

OBTVIOUSLY, IF YOU'RE USING THEM,
DON'T PUT THEM IN THE BOX - LOL!!

AIN'T A SUPPORTER?
YOU'RE MISSIN' OUT **50% OFF**
ALL MY MODELS



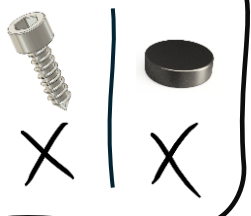

TIME 4 GADGET BOX

TIME TO CLOSE THE BOX

BAMBU H2D/H2S RAISER

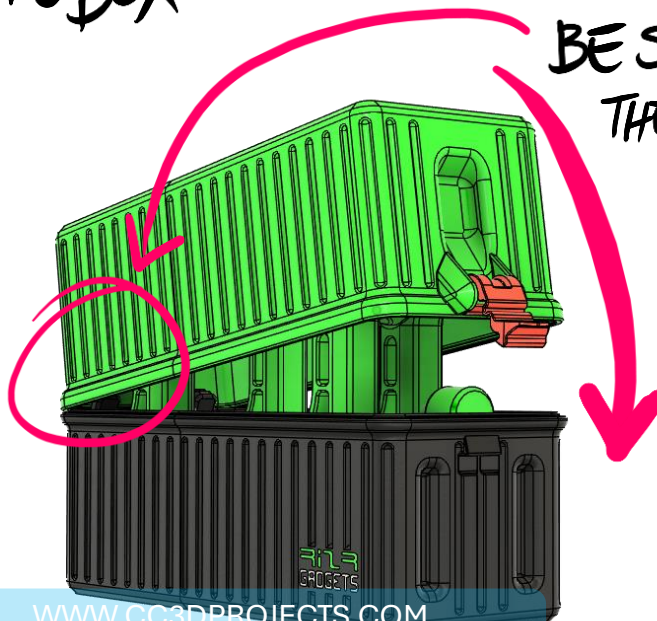
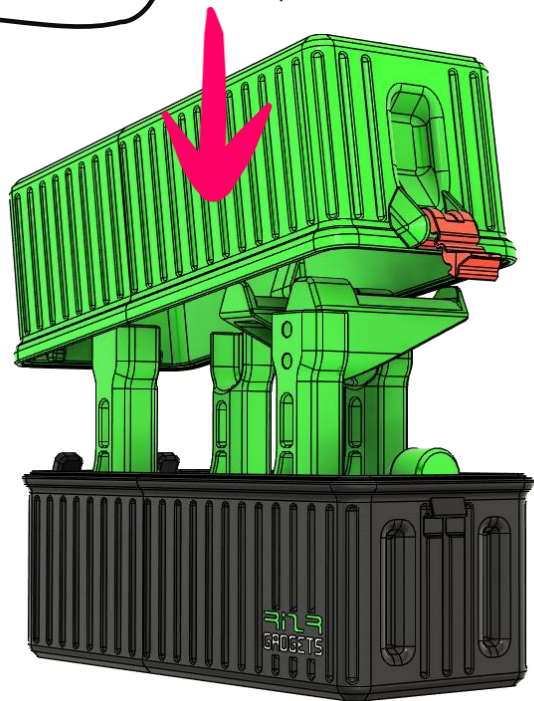

BE SURE TO ALIGN AND SNAP IN THE REAR PINS OF THE LID.

WWW.CC3DPROJECTS.COM

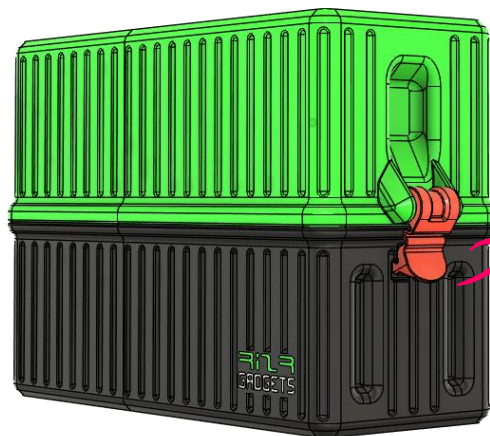
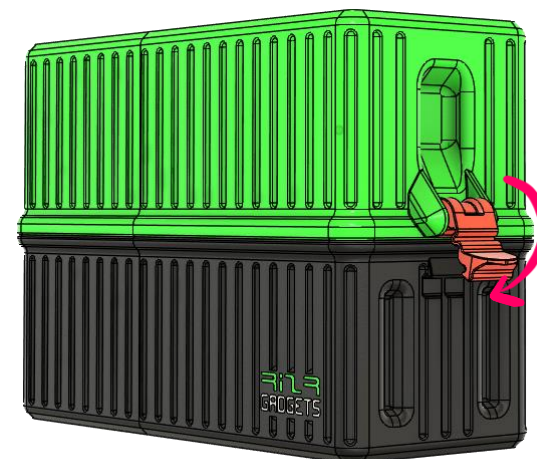

PRESS ON THE LATCH UNTIL YOU HEAR A "TACK"

TACK



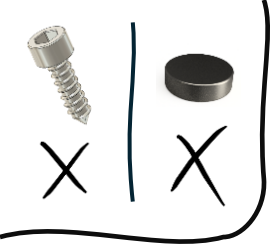

TIME 4 GADGET BOX

BAMBU H2D/H2S RAISER



YOU ARE DONE!
HAS TERMINADO!
TU AS FINI!
DU BIST FERTIG!
終わったよ
你完成了



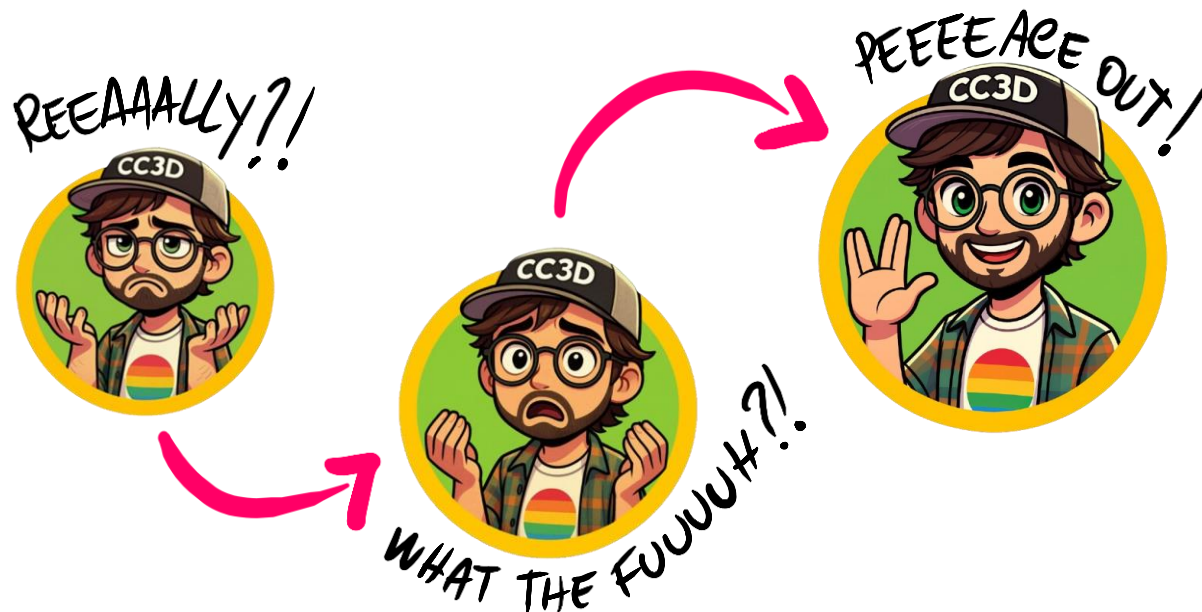

THANKS FOR STICKING WITH ME THROUGH THIS ASSEMBLY GUIDE
 IT TOOK ME HOURS TO PUT THIS GUIDE TOGETHER, I TRULY HOPE YOU LIKE IT!
 IF THERE'S ANYTHING I CAN DO BETTER, PLEASE LET ME KNOW!
 I'M ALWAYS HERE TO HELP AND IMPROVE MY WORK AND MY MODELS!

CIAO
 Enrico





WWW.CC3DPROJECTS.COM

© 2025 CC3DPROJECTS. ALL RIGHTS RESERVED.

THIS MANUAL IS PROTECTED BY COPYRIGHT LAW AND MAY NOT BE REPRODUCED, DISTRIBUTED, OR USED IN WHOLE OR IN PART WITHOUT THE WRITTEN PERMISSION OF THE AUTHOR OR PUBLISHER. ANY VIOLATION WILL BE PROSECUTED TO THE FULLEST EXTENT OF THE LAW.

THE RAIZER BAMBU LAB H2D – H2S AND ALL ITS COMPONENTS, INCLUDING BUT NOT LIMITED TO DESIGNS, SCHEMATICS, ASSEMBLY INSTRUCTIONS, AND PHOTOGRAPHS, ARE THE EXCLUSIVE PROPERTY OF ENRICO MAZZAROL AND ARE PROTECTED BY COPYRIGHT LAW AND OTHER INTELLECTUAL PROPERTY LAWS.

COPYING, DISTRIBUTING, MODIFYING, REPRODUCING, TRANSMITTING, OR USING THE HDRI SYSTEM IN ANY FORM WITHOUT THE WRITTEN PERMISSION OF CC3DPROJECTS IS PROHIBITED.

FOR USAGE REQUESTS, PERMISSIONS, OR OTHER INQUIRIES, PLEASE CONTACT CC3DPROJECT@GMAIL.COM.

