



SNAPMAKER U1 SPOOL BOX

SPOOL BOX FOR SNAPMAKER U1 IS A COMPACT, MODULAR SOLUTION DESIGNED TO KEEP YOUR FILAMENT ORGANIZED, PROTECTED, AND EASY TO MANAGE.

ITS SMART LAYOUT FEATURES SMOOTH SPOOL HOLDERS, AN INTEGRATED FILAMENT GUIDE, AND HANDY STORAGE COMPARTMENTS TO KEEP YOUR WORKSPACE CLEAN AND EFFICIENT.

EASY TO PRINT AND ASSEMBLE, IT FITS SEAMLESSLY INTO DIFFERENT SETUPS—ON YOUR DESK OR MOUNTED ON A STAND—HELPING YOU CREATE A MORE STREAMLINED AND PROFESSIONAL WORKFLOW.



KEY CHARACTERISTICS

SNAPMAKER U1 SPOOL BOX



AIR INTAKE IS FINE!

SUPPORT FOR 2 BUILD PLATES

TOOL BOX

CLOSING LATCH

POLYDRYER HOOK

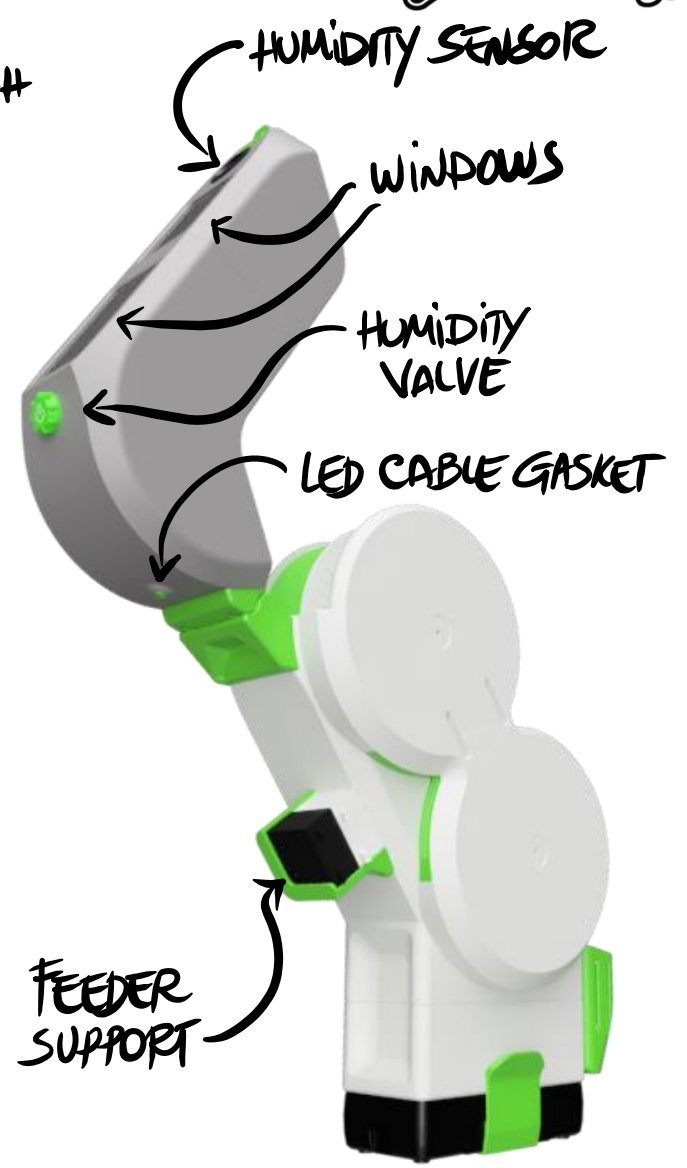

HUMIDITY SENSOR

WINDOWS

HUMIDITY VALVE

LED CABLE GASKET

FEEDER SUPPORT



THIS IS THE SETUP I HAD IN MIND
FROM THE START OF THE PROJECT:

2 DRY BOXES + A DRAWER
SITTING ON THE SAME BASE.

BUT AS I KEEP WORKING ON IT,
I REALIZED IT'S WAY MORE
FLEXIBLE THAN I THOUGHT!

YOU'LL SEE SOME DIFFERENT
CONFIGURATION NEXT



KEY CARATERISTICS

SNAPMAKER U1 SPOOL BOX



SNAPMAKER U1
FULL DRYBOXES
SETUP

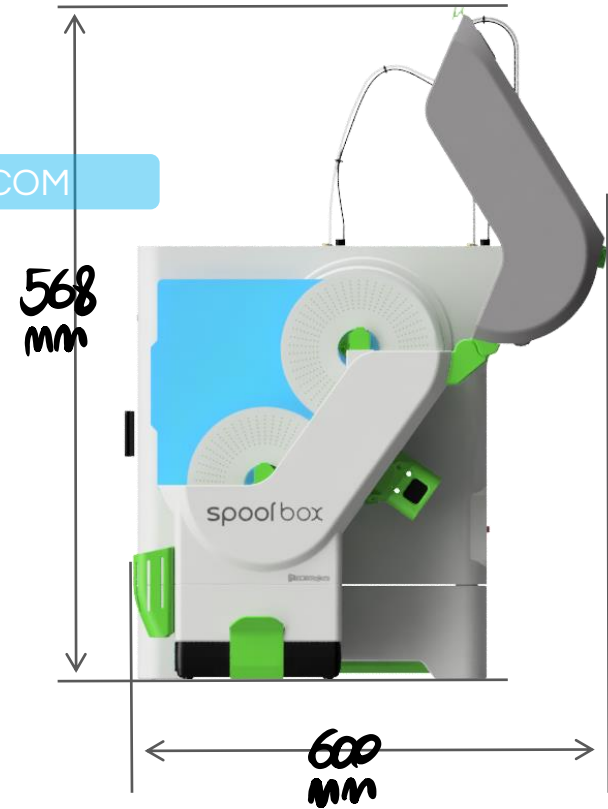
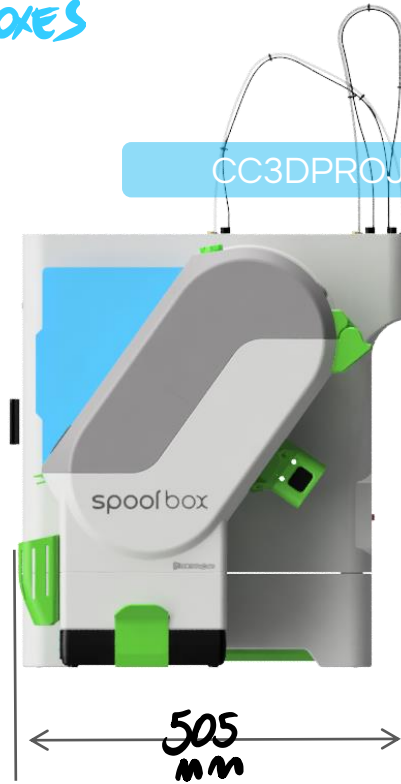
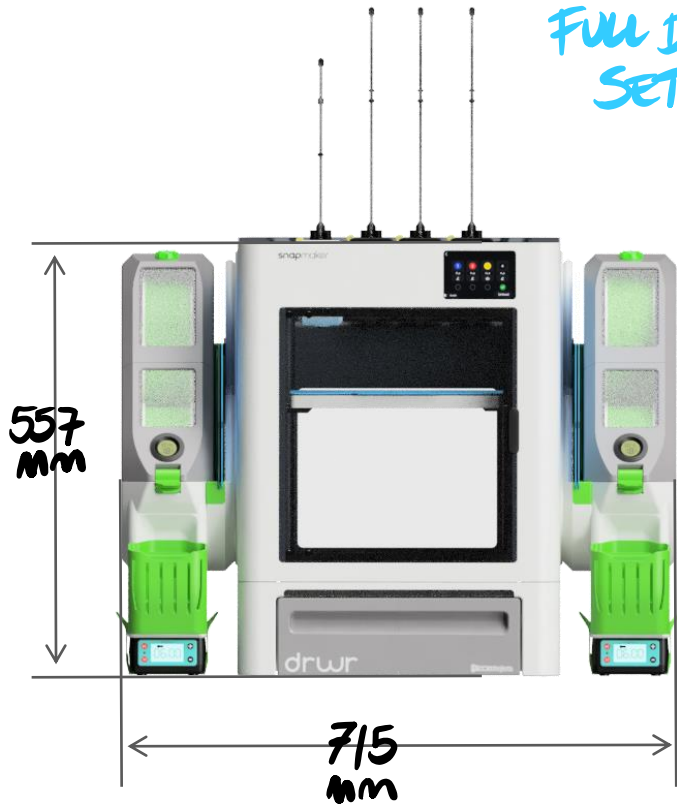

KEY CHARACTERISTICS

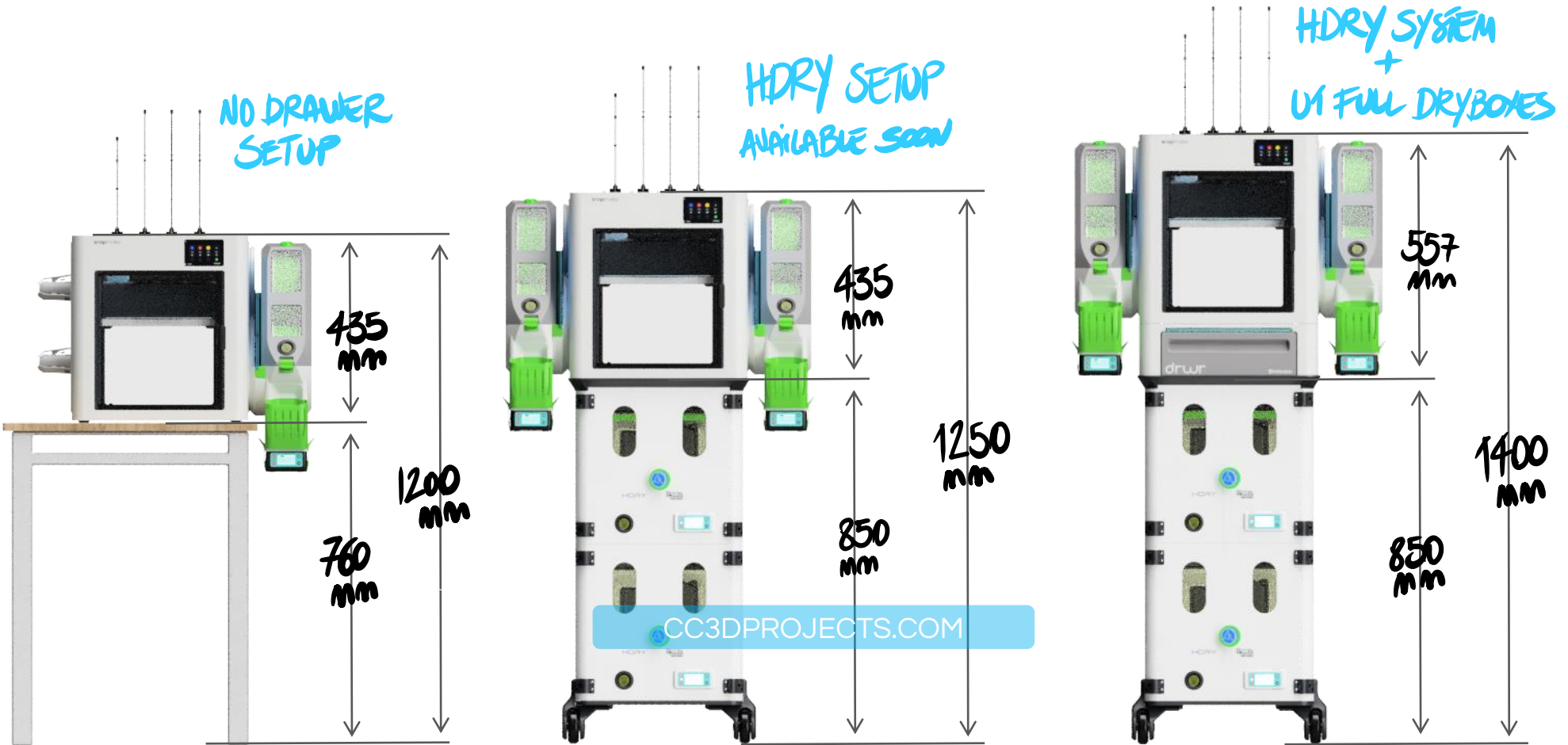

SNAPMAKER U1 SPOOL BOX



AS YOU'LL SEE, THIS MANUAL IS FOR ASSEMBLING THE RIGHT-SIDE DRYER.
THE PROCESS IS PRETTY STRAIGHTFORWARD AND IT'S EXACTLY THE SAME FOR THE
LEFT SIDE - NO REAL DIFFERENCES, ASIDE FROM THE OBVIOUS PARTS YOU'LL BE USING.
THAT SAID, I WON'T BE MAKING A SEPARATE FOR THE LEFT SIDE!

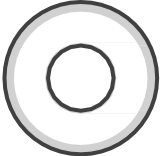

B.O.M.

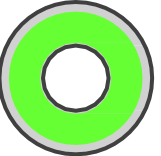
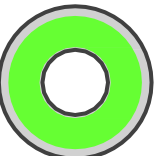
PETG	PETG	PETG	TPU95A
			
1,4KG	30G	550G	3G

PRINT TIME:
2D 17H 36M

REQUIRED HARDWARE:



SCREW M4 x 14mm 27 UNITS



MAGNET 8x2 mm 4 UNITS



GASKET
6 x 3
mm mm

1 METER

ACRYLIC OR POLYCARBONATE
SHEET

1 UNIT

LED STRIP

1 UNITS



BUILD PLATES

SNAPMAKER U1 SPOOL BOX



THIS IS HOW THE PLATES LOOKS

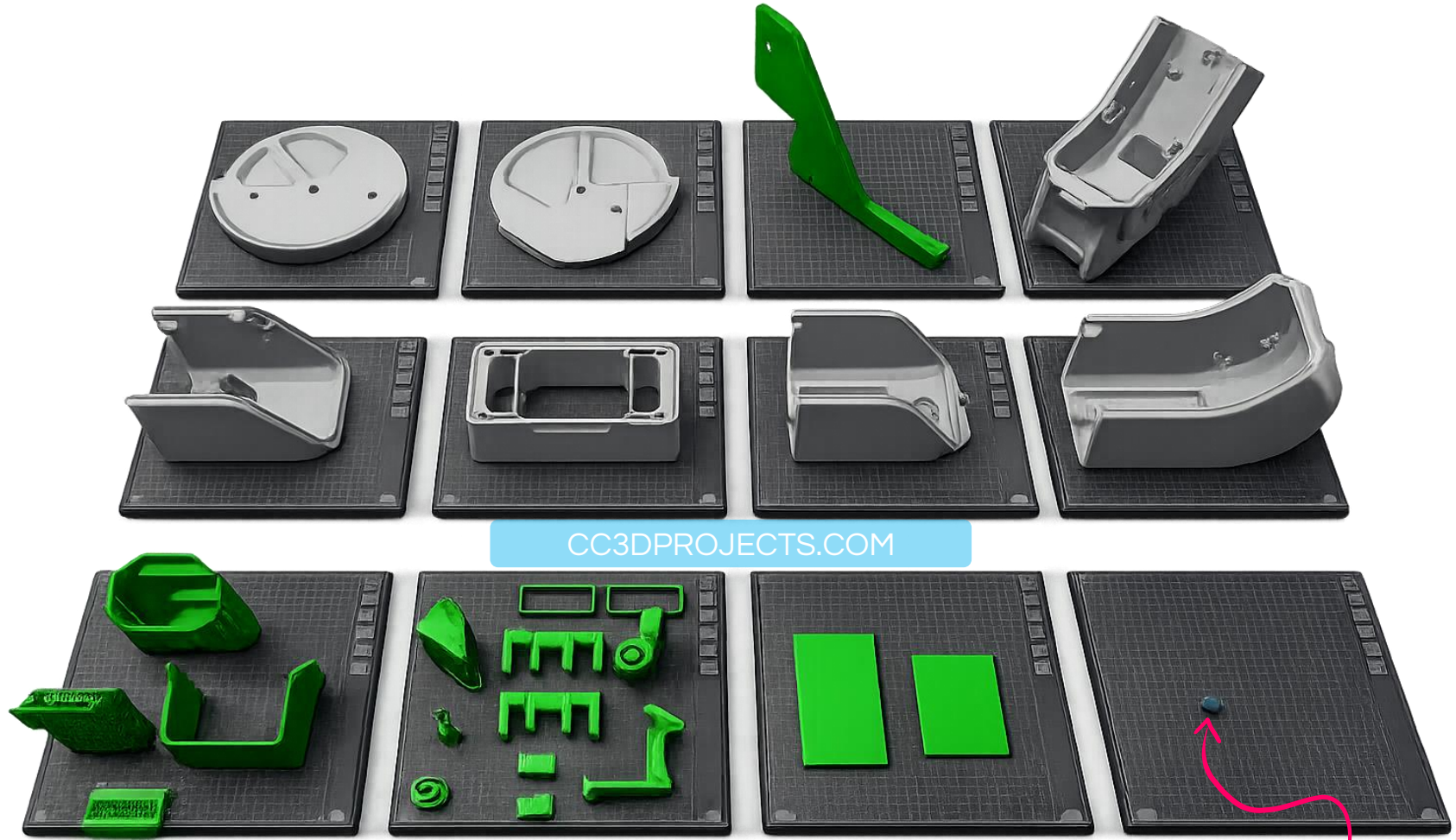

THIS SHOULD BE PRINTED IN TPU



ALL MATERIAL PRODUCED AND PROVIDED HAS BEEN CONCEIVED, AUTHORED AND PRODUCED BY ENRICO MAZZAROL - ALL RIGHTS RESERVED.

FOLLOW THESE SIMPLE TIPS AND YOU'RE GOLDEN:

1. STICK WITH REGULAR PETG

USE STANDARD PETG AND SKIP THE HIGH FLOW (HF) STUFF. HF MIGHT SOUND COOL, BUT IT CAN'T HANDLE HEAT AS WELL, AND THAT CAN MESS WITH YOUR PRINT'S DURABILITY. YEAH, REGULAR PETG IS SHINIER — I GET IT — BUT HERE'S A TRICK: SPRAY IT WITH A MATTE CLEAR COAT LIKE I DID. BOOM! PROBLEM SOLVED.

2. DON'T USE PLA FOR SUPPORTS

IF YOU ARE USING A SINGLE NOZZLE PRINTER WITH A COLOR CHANGE SYSTEM, AVOID USING PLA AS SUPPORT MATERIAL. SERIOUSLY. EVEN IF YOU SWITCH FILAMENTS, LEFTOVER PLA IN THE NOZZLE CAN MESS WITH LAYER ADHESION, AND THAT'S NO FUN. AND DON'T STRESS — THE SUPPORTS COME OFF EASY, I PROMISE. YOU GOT THIS.

3. KEEP IT SLOW AND STEADY

RESIST THE URGE TO CRANK UP THE PRINT SPEED. GOING TOO FAST CAN LEAD TO WEIRD-LOOKING CORNERS AND WARPED PARTS. STICK TO STANDARD SPEED — YOUR PRINT WILL THANK YOU.

4. USE A GRIPPY PRINT BED

THESE PARTS ARE ON THE BIGGER SIDE, SO BED ADHESION IS EVERYTHING. MAKE SURE YOUR BUILD PLATE'S GOT A GOOD GRIP TO AVOID WARPING OR LIFTING. TRUST ME, A SOLID FIRST LAYER MAKES ALL THE DIFFERENCE.

SLICER PRINT SETTINGS:

- 2 WALLS & 2 BOTTOMS & 2 TOPS
- INFILL: WALLS 9% - HINGES 20%
- SUPPORTS: NORMAL (MANUAL) SNUG



GLASS PREP

QUESTION OR ANYTHING ELSE

YOU'LL FIND DXF FILES FOR LASER CUTTING AND/OR PRINTABLE TEMPLATES FOR MANUAL CUTTING (DREMEL OR CUTTER).

IF CUTTING MANUALLY.. SAFETY FIRST... THEN SKIP PLEXIGLASS - INSTEAD USE THE CLEAR MDF PICTURE FRAMES. EASY TO FIND, SUPER CHEAP!



DRYER BOX BODY

SNAPMAKER V1 SPOOL BOX

QUICK TIP: INSTALL THE GLASS BEFORE ASSEMBLING THE TOP DOOR.

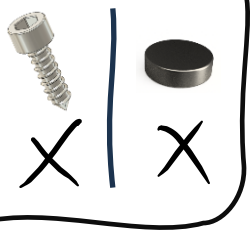

AS GIVE I USE THE ONE MADE FOR PHONES. IT'S FLEXIBLE, NON FAST-SETTING, AND END UP ACTING LIKE A GASKET.



APPLY ENOUGH SO IT SLIGHTLY SQUEEZES OUT OF THE CHANNEL IN THE PART.

GENTLY PLACE THE GLASS WITHOUT MOVING IT TOO MUCH, PUT SOME WEIGHT ON TOP, AND LEAVE IT ALONE FOR AT LEAST AN HOUR.



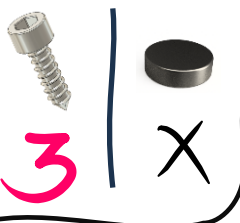

DRYER BOX BODY

SNAPMAKER V1 SPOOL BOX



QUICK NOTE: THE LAST 2 DIGITS OF THE PART CODES INDICATE WHETHER THE PIECE IS RIGHT OR LEFT-HANDED

DTRH OR DTLH

DTRH
OR
DTLH

INSERT THE SCREWS INTO THE HIGHLIGHTED HOLES AND SECURELY JOIN THE PARTS.

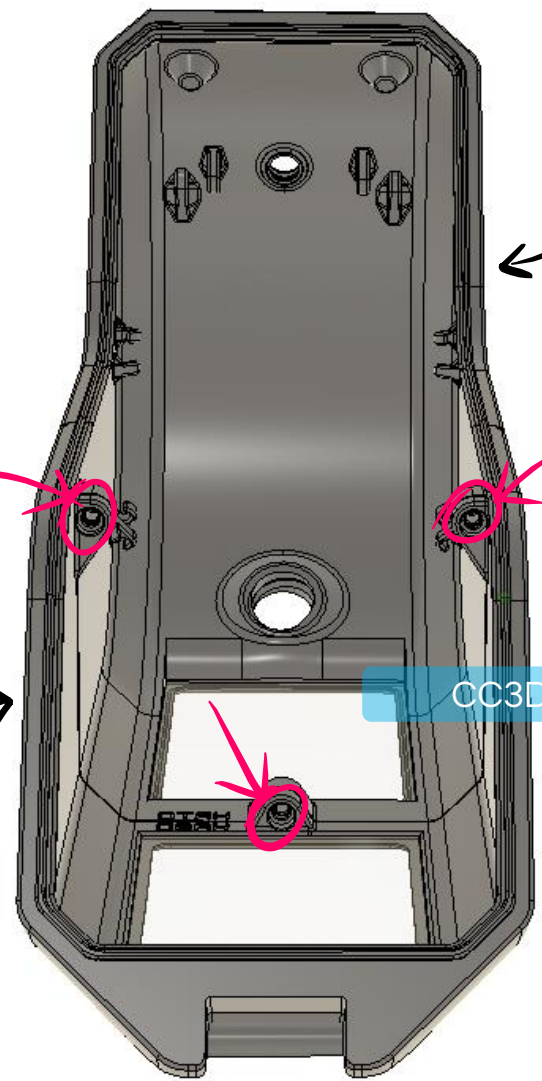

DBRH
OR
DTLH

CC3DPROJECTS.COM



ALL MATERIAL PRODUCED AND PROVIDED HAS BEEN CONCEIVED, AUTHORED AND PRODUCED BY ENRICO MAZZAROL - ALL RIGHTS RESERVED.

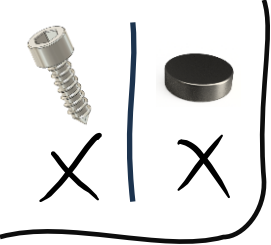

DRYER BOX BODY

SNAPMAKER V1 SPOOL BOX



NOW ATTACH THE FRONT HOOK - JUST SNAP INTO PLACE AND YOU'RE DONE!

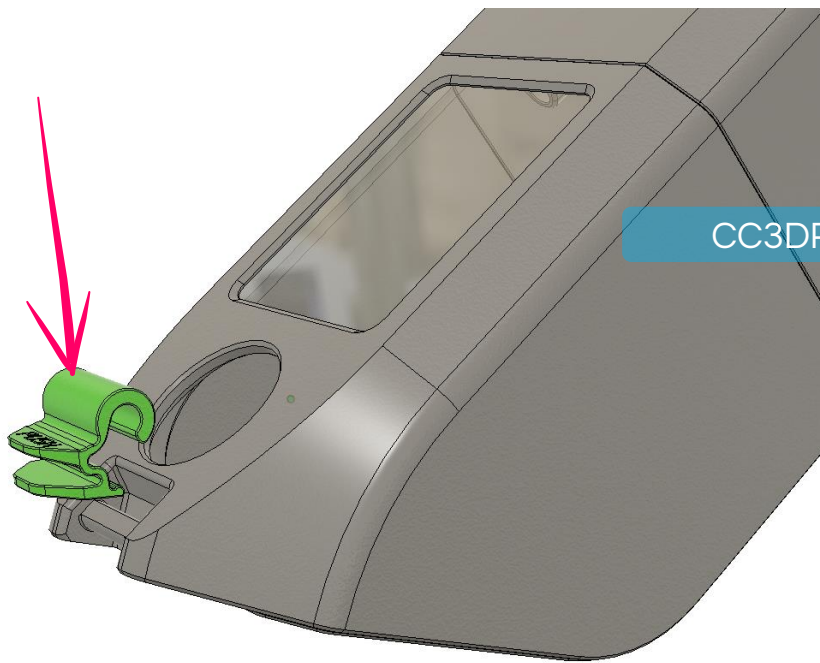

CC3DPROJECTS.COM



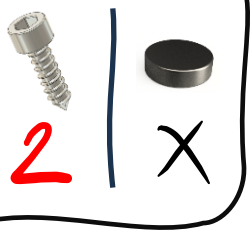

DRYER BOX BODY

SNAPMAKER V1 SPOOL BOX



INSERT THE SCREWS INTO THE HIGHLIGHTED HOLES AND SECURELY JOIN THE PARTS.

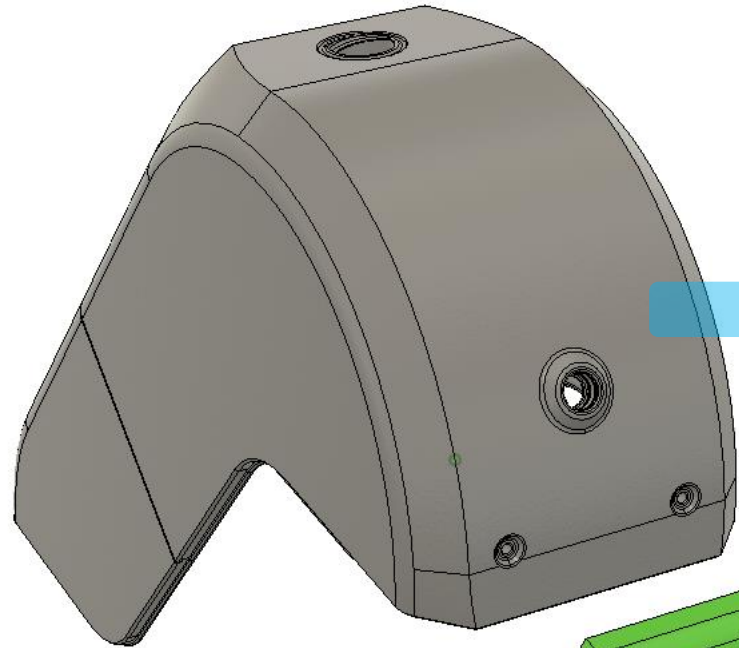

CC3DPROJECTS.COM

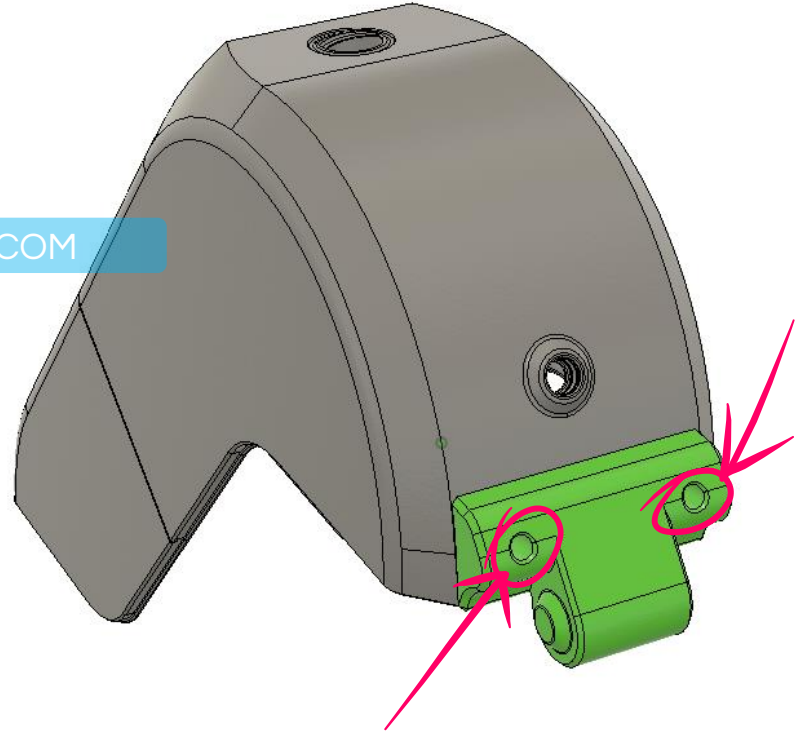

HTRH
OR
HTLH

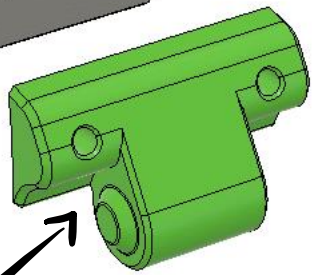

DRYER BOX BODY

SNAPMAKER U1 SPOOL BOX

PUT THE STEAM CAP TO THE DOOR, IT SCREWS ON COUNTERCLOCKWISE ON THE RIGHT SIDE AND CLOCKWISE ON THE LEFT.

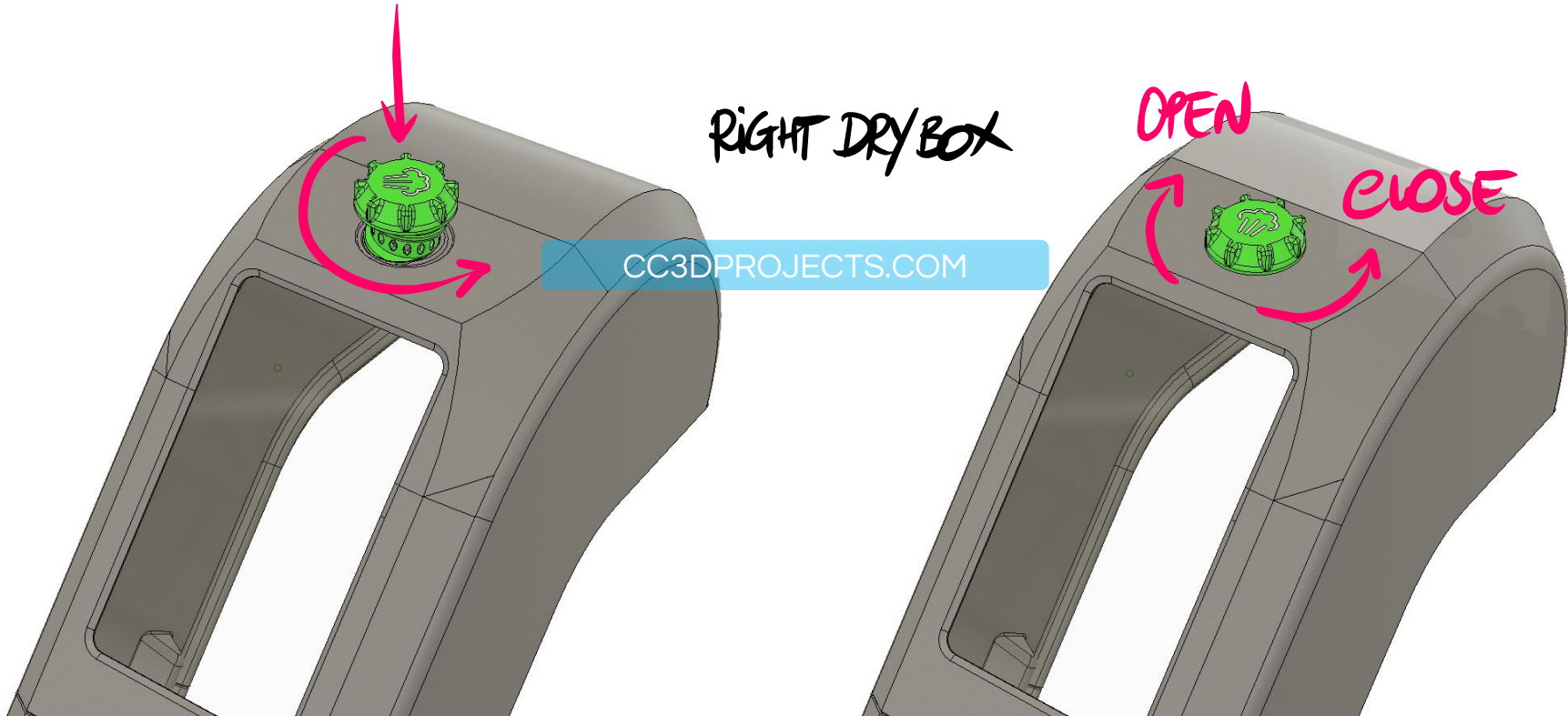

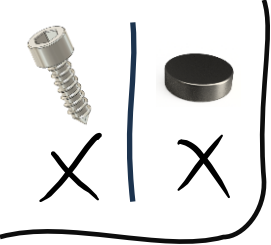

DRYER BOX BODY

SNAPMAKER U1 SPOOL BOX



INSTALL THE TEMPERATURE AND HUMIDITY SENSOR

DEPENDING ON THE PRODUCER,
IT MIGHT NOT SIT PERFECTLY IN PLACE...

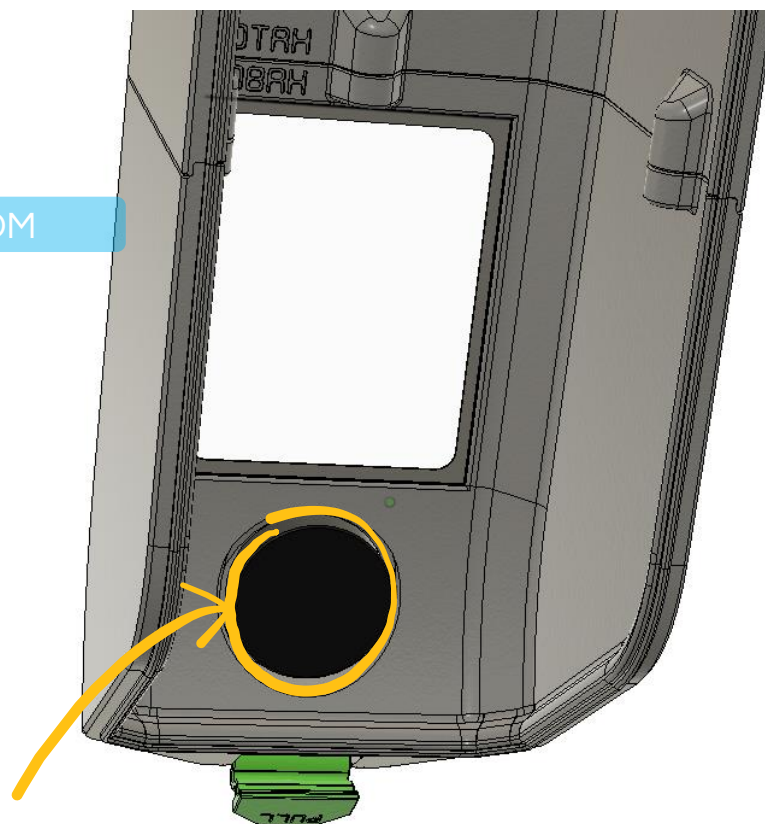
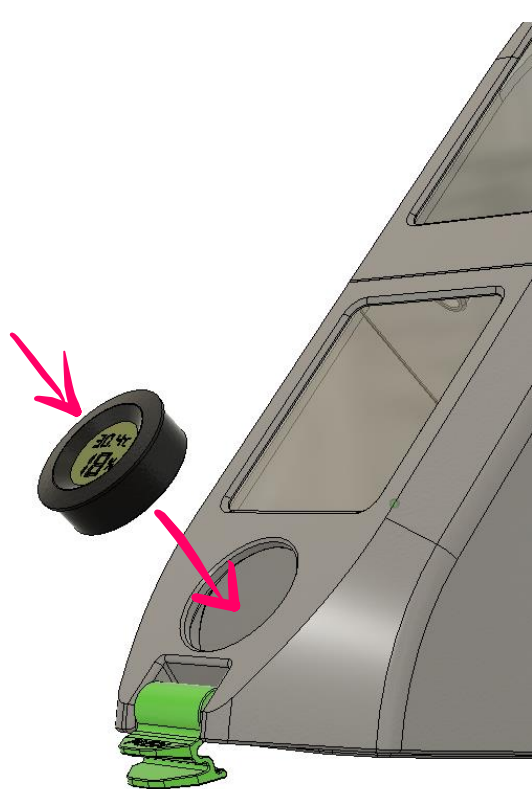

I RECOMMEND SECURE IT WITH GLUE SO IT ENDUP NICE
AND ALSO WATERTIGHT.

DRYER BOX BODY

SNAPMAKER V1 SPOOL BOX

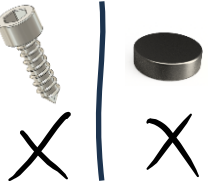

YOU MIGHT BE WONDERING WHICH LED STRIP I USE AND HOW I CONTROL THEM. BELOW ARE FEW EXAMPLE OF PRODUCTS - I PICKED THESE CAUSE THEY ALREADY HAVE BUILD-IN WIFI CONTROL WITH THE MAIN ASSISTANT, SO I CAN INTEGRATE THEM INTO MY SMART HOME SETUP. I'M LAZY I KNOW! LOL BUT I'M SURE YOU CAN DO IT BETTER!!



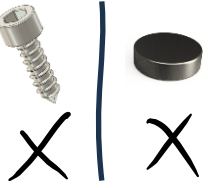

DRYER BOX BODY

SNAPMAKER U1 SPOOL BOX

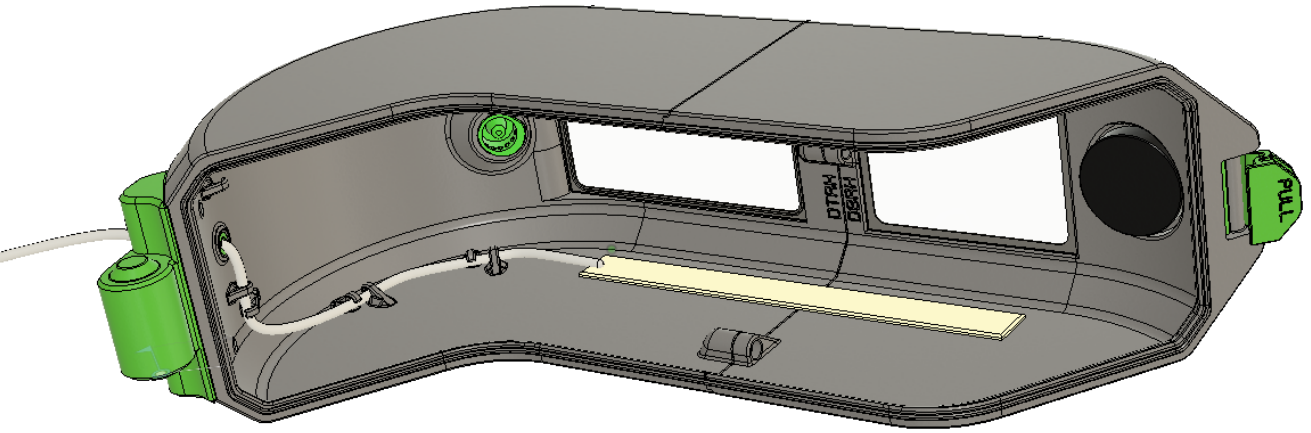

CC3DPROJECTS.COM

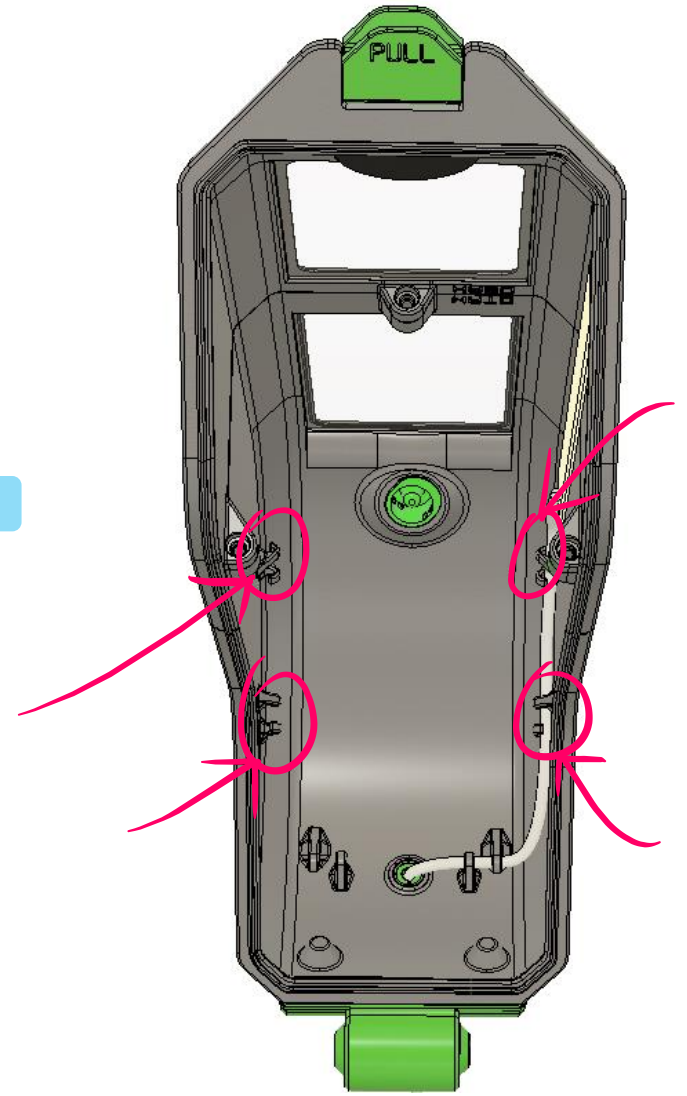

ALL MATERIAL PRODUCED AND PROVIDED HAS BEEN CONCEIVED, AUTHORED AND PRODUCED BY ENRICO MAZZAROL - ALL RIGHTS RESERVED.

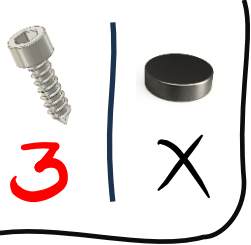

DRYER BOX BODY

SNAPMAKER U1 SPOOL BOX



INSERT THE SCREWS INTO THE HIGHLIGHTED HOLES AND SECURELY JOIN THE PARTS.

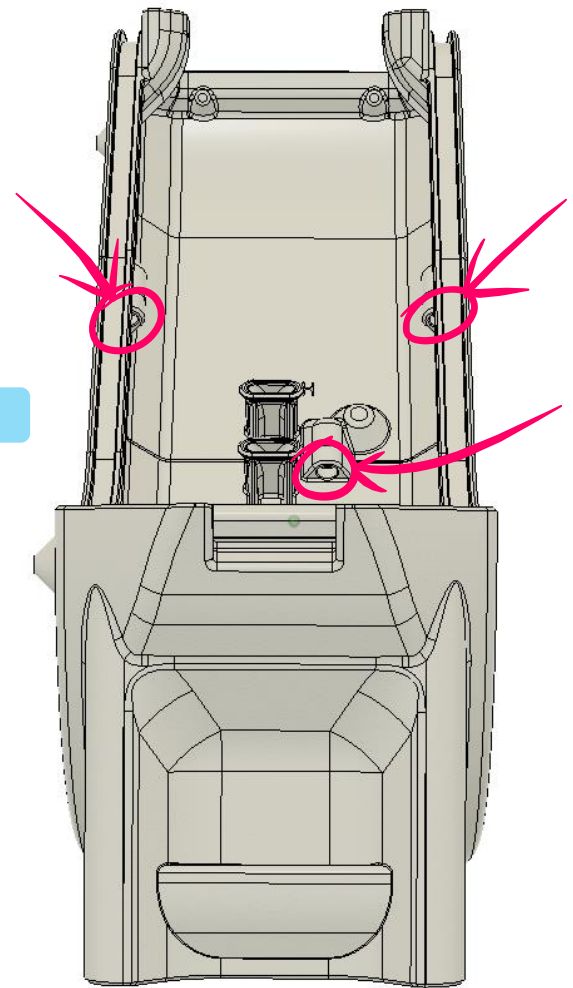
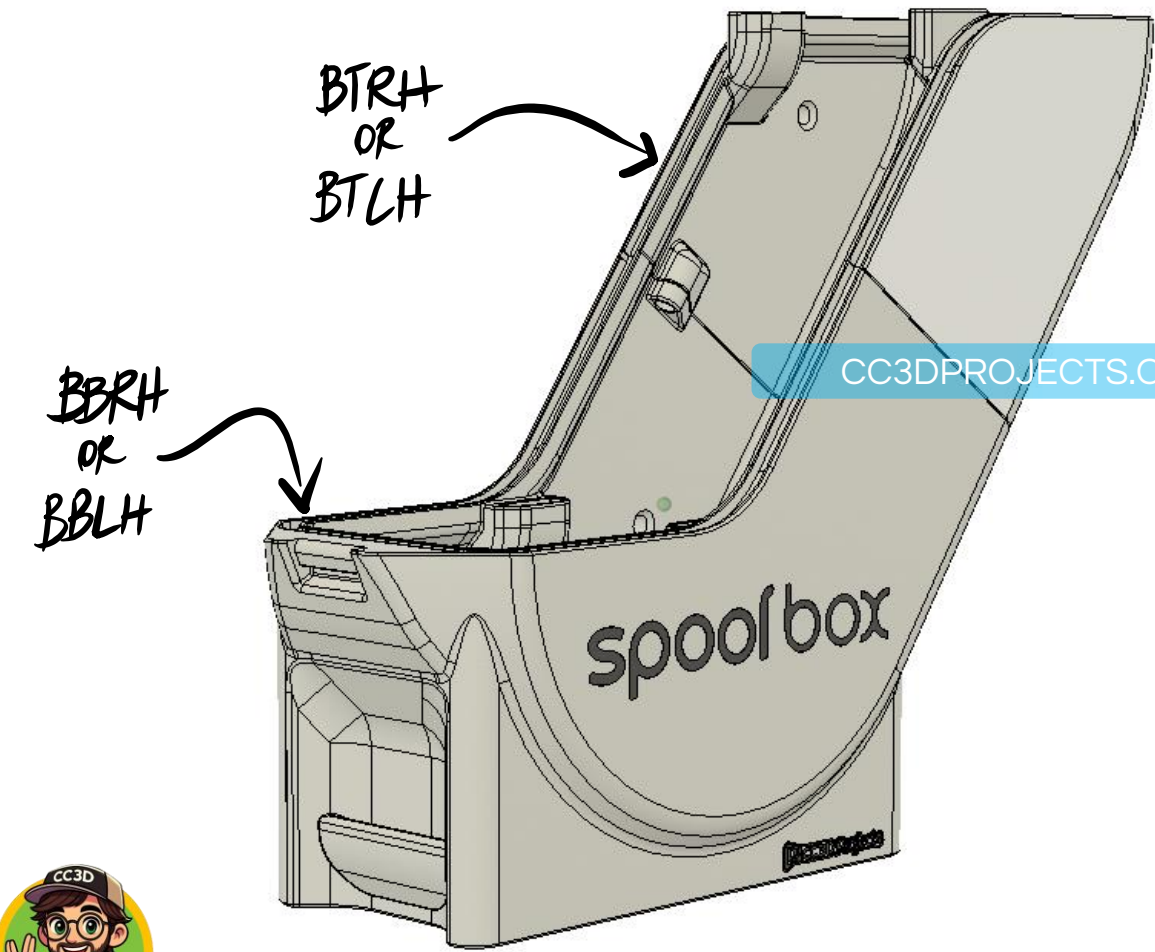

CC3DPROJECTS.COM



ALL MATERIAL PRODUCED AND PROVIDED HAS BEEN CONCEIVED, AUTHORED AND PRODUCED BY ENRICO MAZZAROLI - ALL RIGHTS RESERVED.

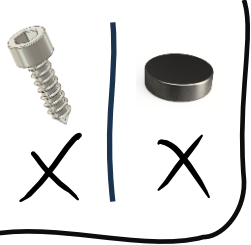

DRYER BOX BODY

SNAPMAKER U1 SPOOL BOX

INSERT THE BELOW GASKETS, NO GLUE IS NEEDED.

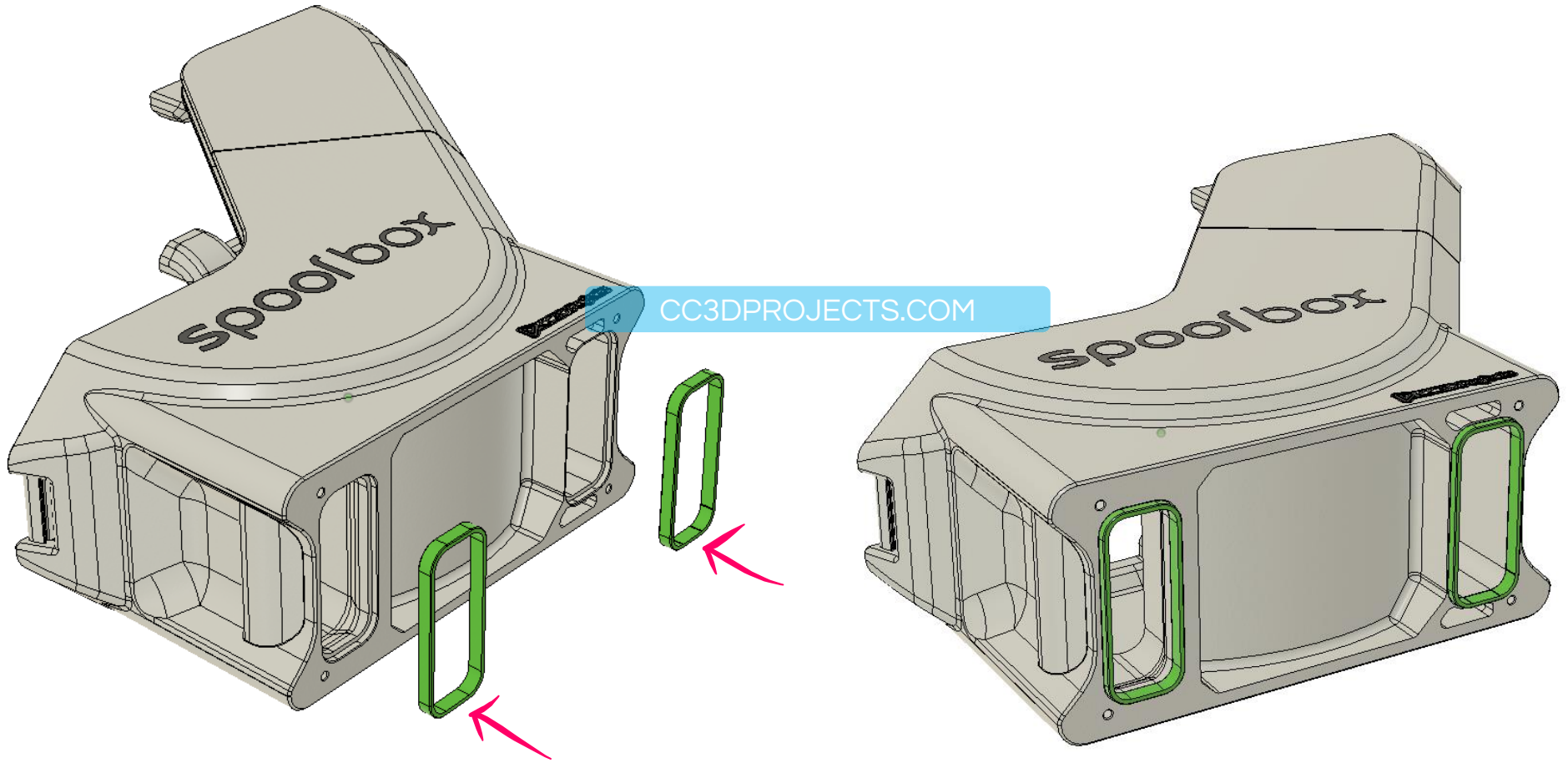

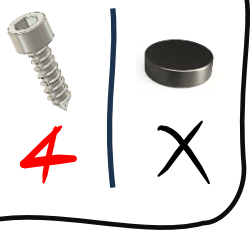

DRYER BOX BODY

SNAPMAKER U1 SPOOL BOX



INSERT THE SCREWS INTO THE HIGHLIGHTED HOLES AND SECURELY JOIN THE PARTS.

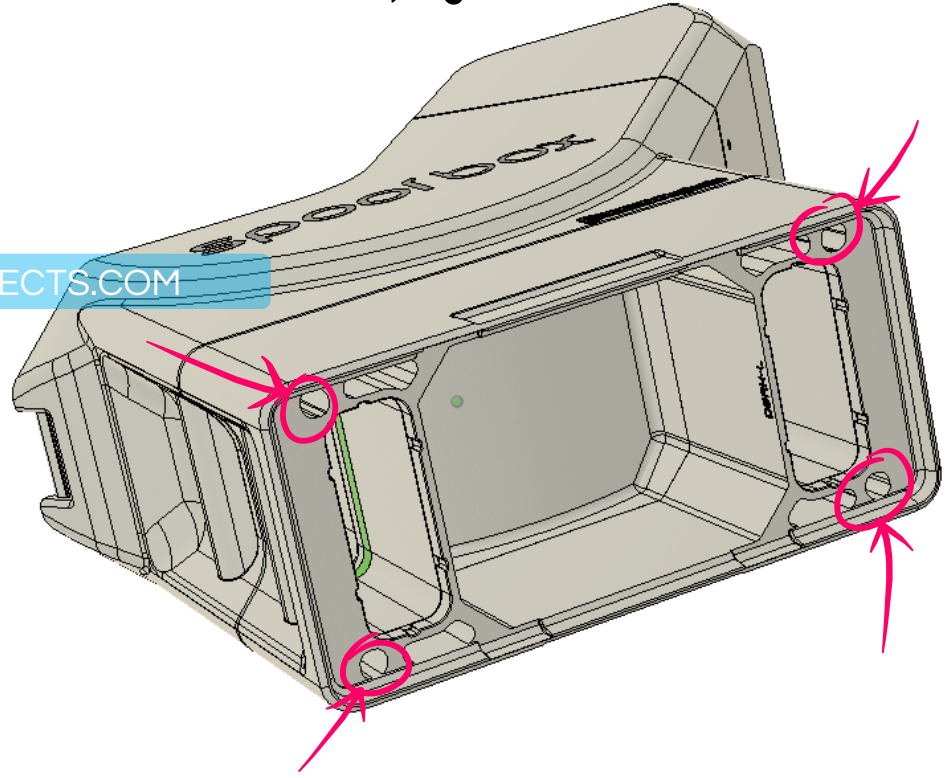
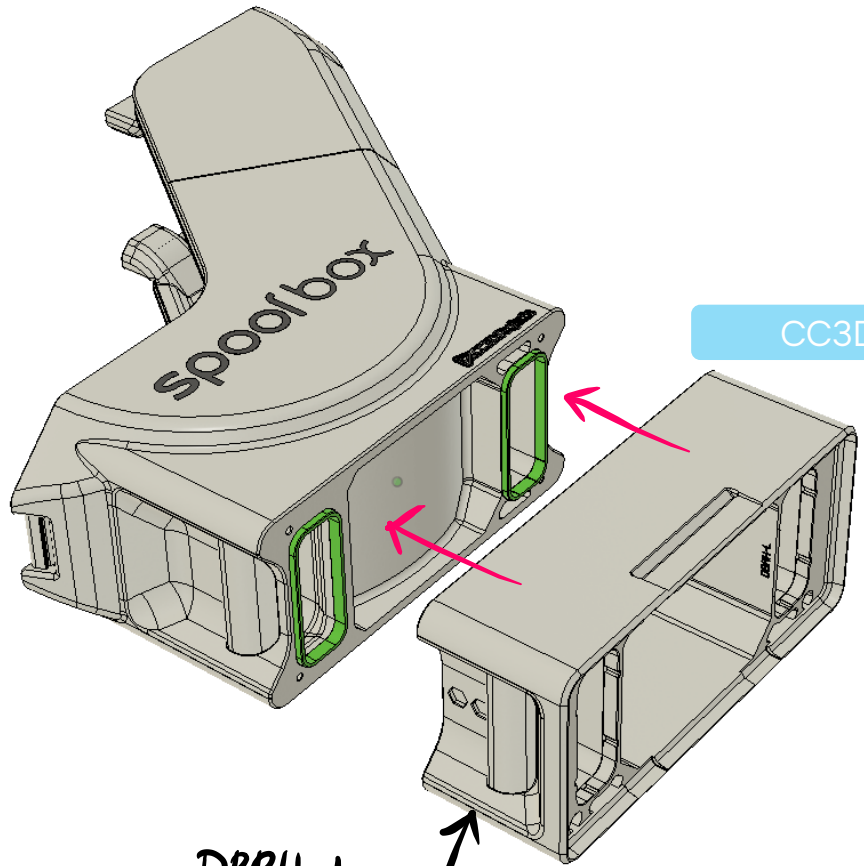

DBRH-L
OR
DBLH-L





DRYER BOX BODY

SNAPMAKER U1 SPOOL BOX



INSERT THE SCREWS INTO THE HIGHLIGHTED HOLES AND SECURELY JOIN THE PARTS.

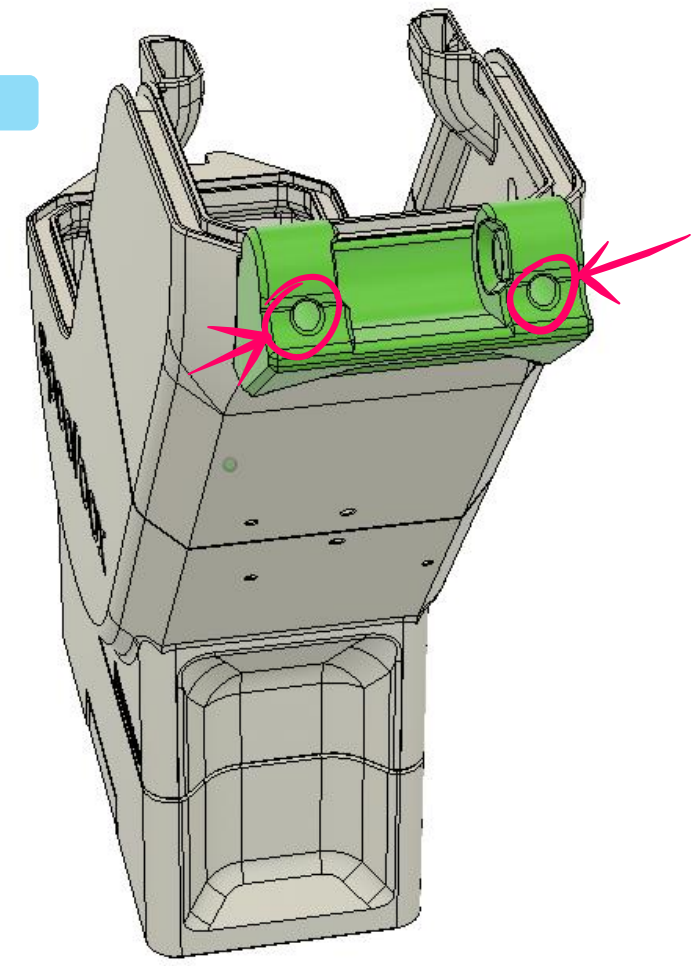
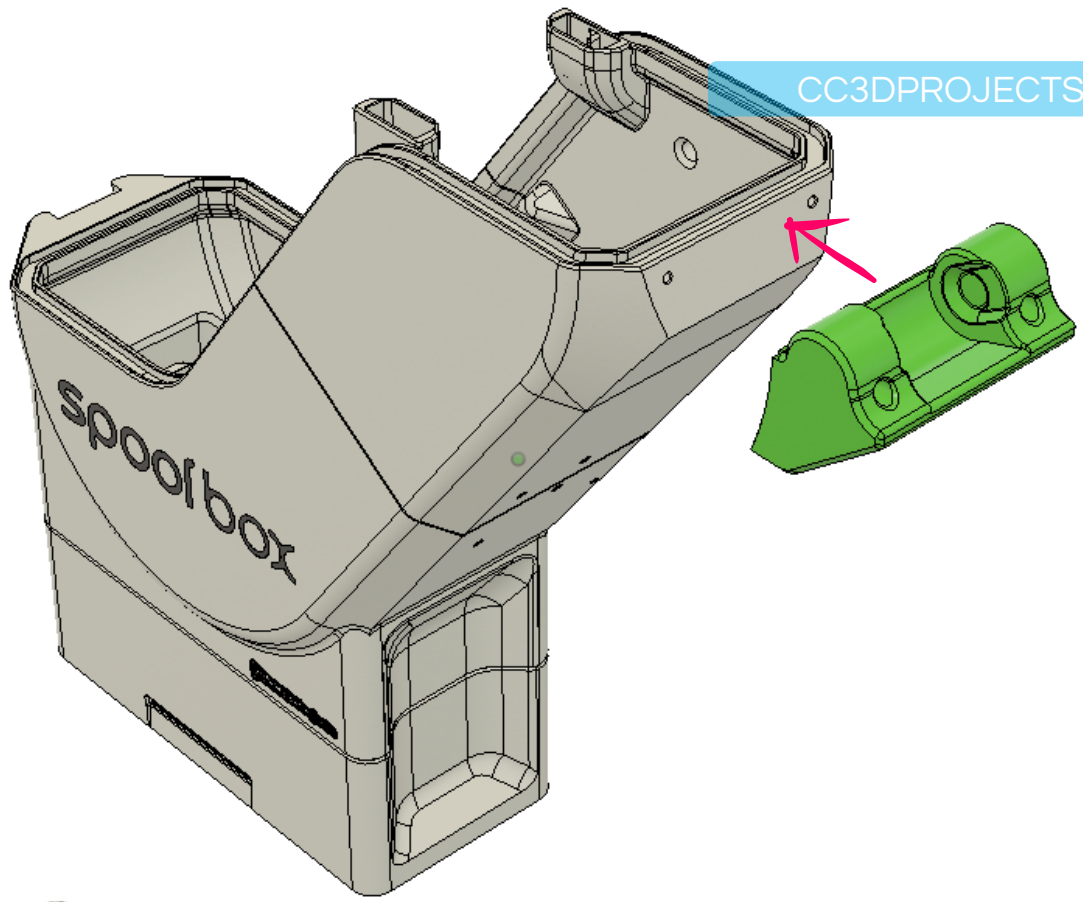

ALL MATERIAL PRODUCED AND PROVIDED HAS BEEN CONCEIVED, AUTHORED AND PRODUCED BY ENRICO MAZZAROL - ALL RIGHTS RESERVED.

DRYER BOX BODY

SNAPMAKER U1 SPOOL BOX

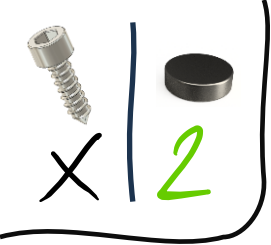

LET'S INSTALL THE MAGNET FOR THE BOX INTO THE FRONT BODY.

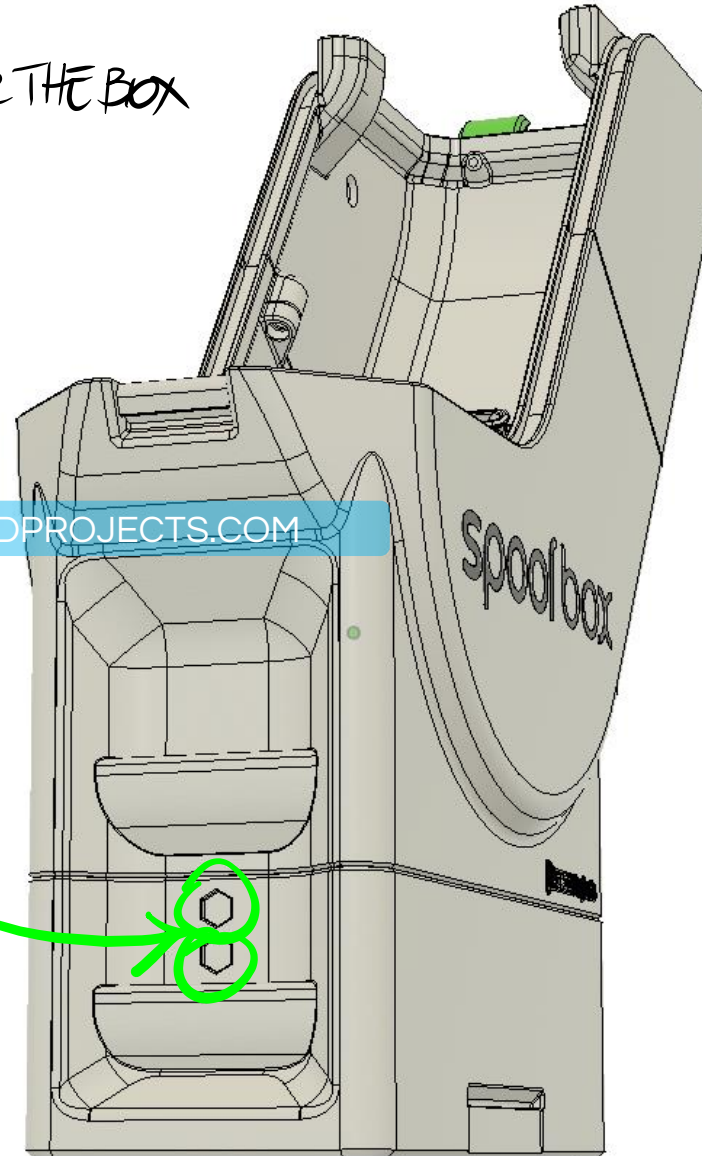

TO INSTALL THOSE MAGNETS USE THE MAGNET INSTALLER "A".
YOU'LL FIND THE INSTALLERS FOR FREE ON MY SHOP



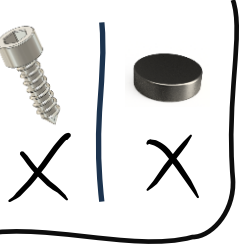

DRYER BOX BODY

SNAPMAKER U1 SPOOL BOX

TIME TO INSTALL THE GASKET ON THE DRYER BASE.

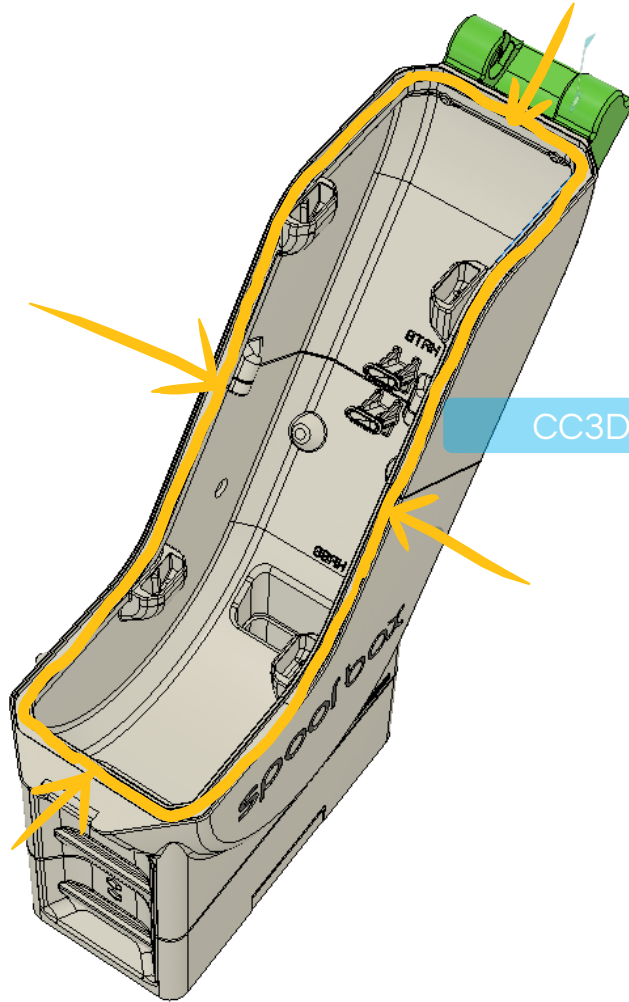

GASKET

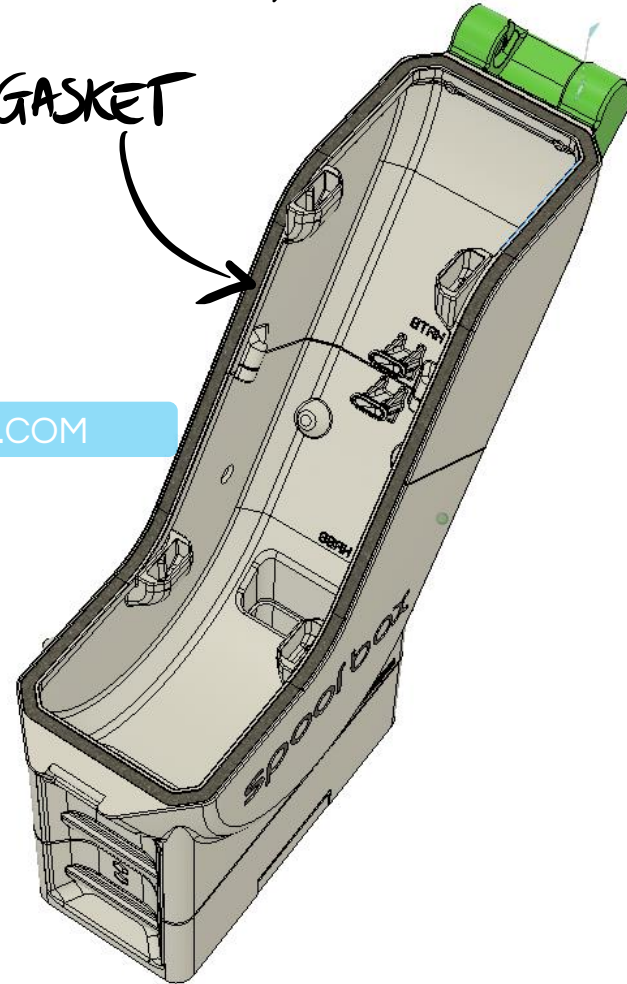

CC3DPROJECTS.COM



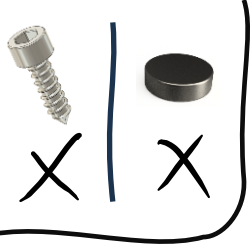

DRYER BOX BODY

SNAPMAKER V1 SPOOL BOX

ATTACH THE LID TO THE BASE

I'D RECOMMEND
ADDING A FEW DROPS OF
LUBRICANT ON THE MALE
PART TO HELP IT SNAP IN
EASIER.

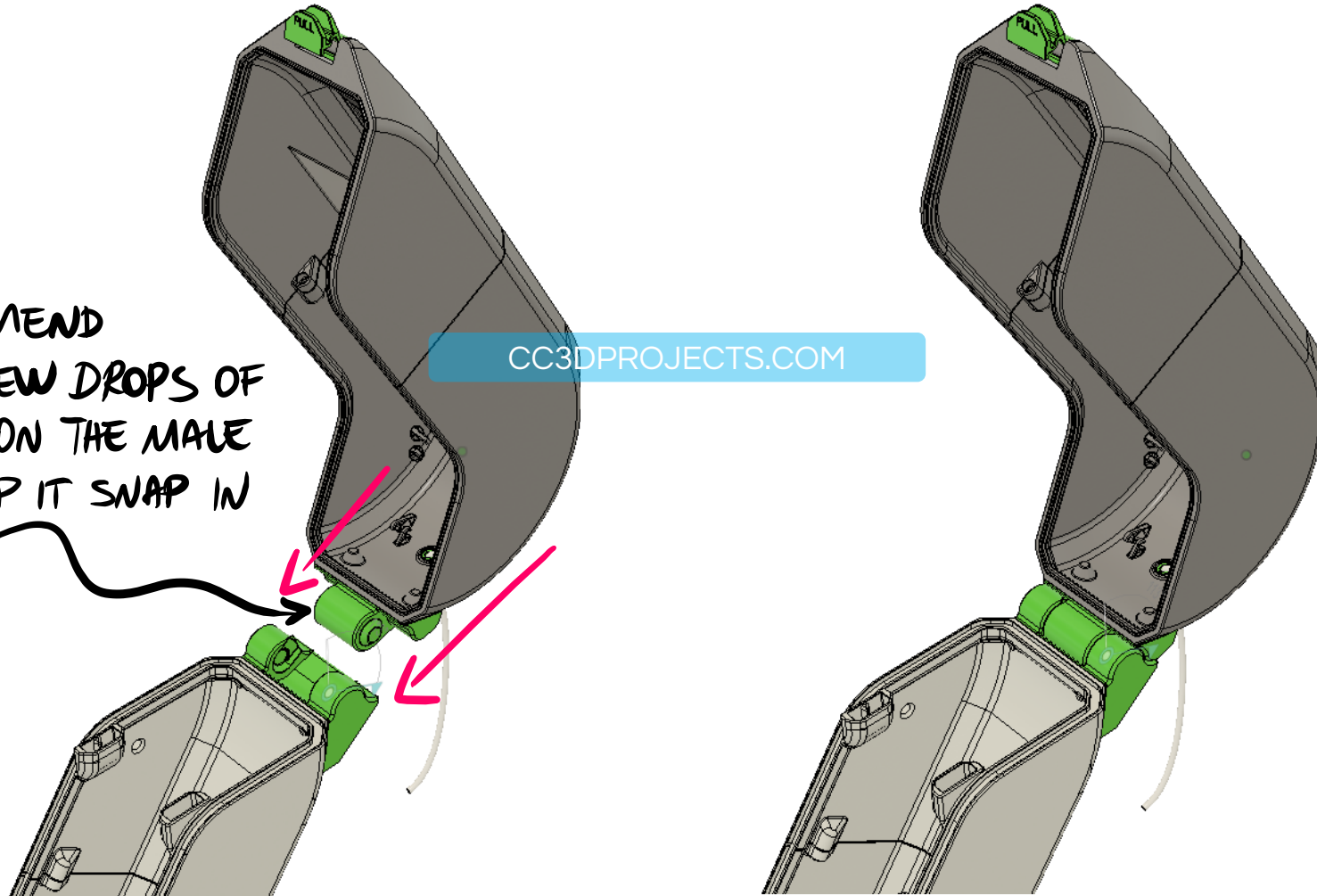

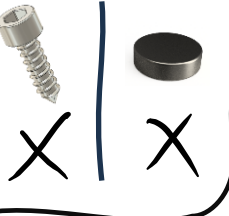

DRYER BOX BODY

SNAPMAKER U1 SPOOL BOX



STICK THE POLYDRYER UNDERNEATH.

PLACE IT IN POSITION AND LOCK IT WITH THE GREEN BAND UNTIL IT SNAPS FIRMLY INTO PLACE.

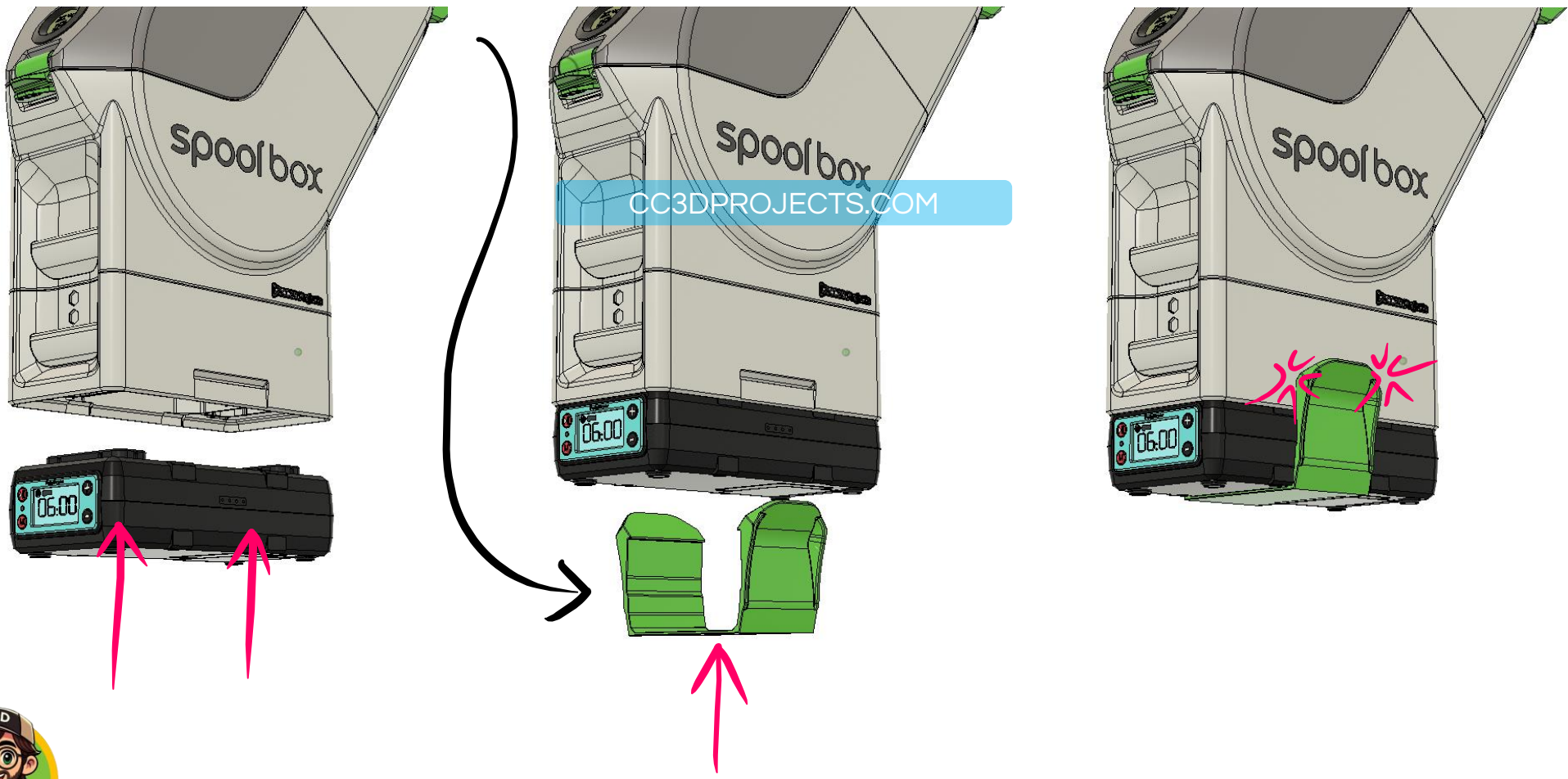

ALL MATERIAL PRODUCED AND PROVIDED HAS BEEN CONCEIVED, AUTHORED AND PRODUCED BY ENRICO MAZZAROL - ALL RIGHTS RESERVED.

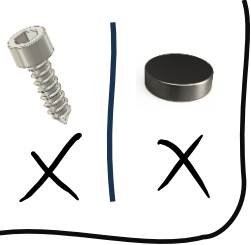

DRY BOX INSTALLATION

SNAPMAKER U1 SPOOL BOX



NOW THINGS GET INTERESTING... HAVE YOU ALREADY DECIDED WHETHER YOU'RE USING THE DRAWER OR NOT?

ONCE YOU'VE MADE YOUR CHOICE, YOU CAN GO AHEAD AND START INSTALLING THE BOX ONTO THE PRINTER!

WITHOUT DRAWER

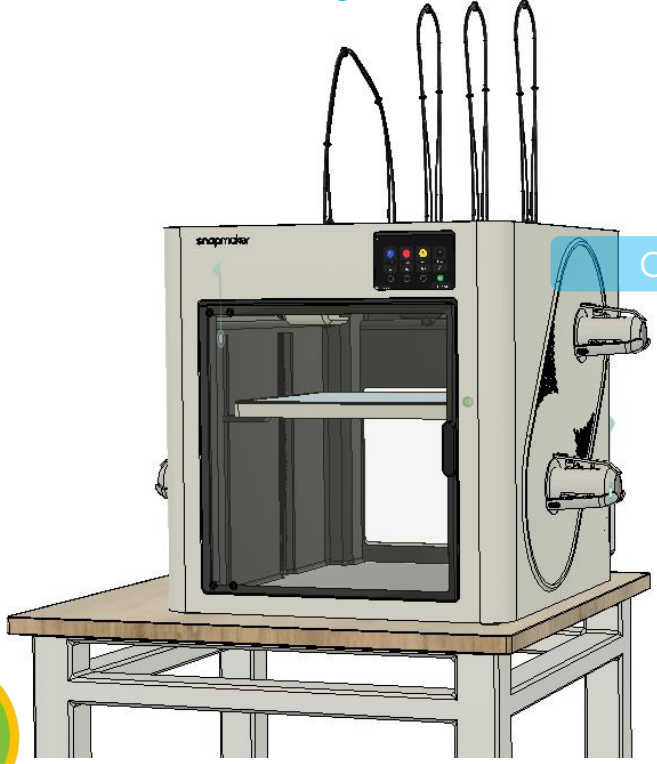

WITH DRAWER

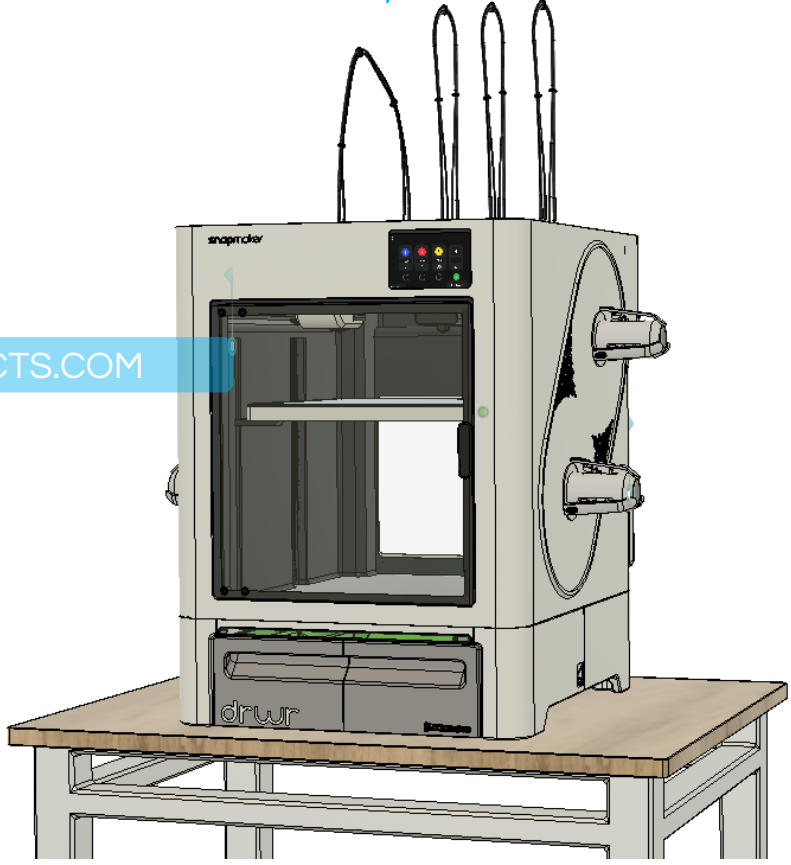

CC3DPROJECTS.COM



DRY BOX INSTALLATION

SNAPMAKER U1 SPOOL BOX

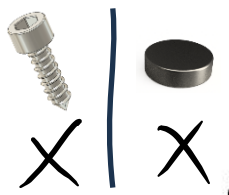

CAREFULLY REMOVE THE STANDARD SPOOL HOLDER AND REPLACE THEM WITH THE ONES INCLUDED IN THE PROJECT - SNAP THEM IN!

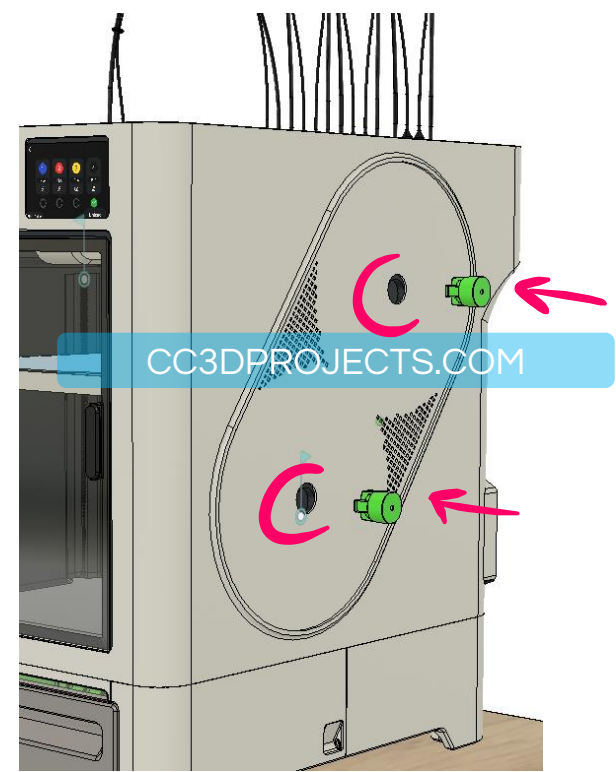
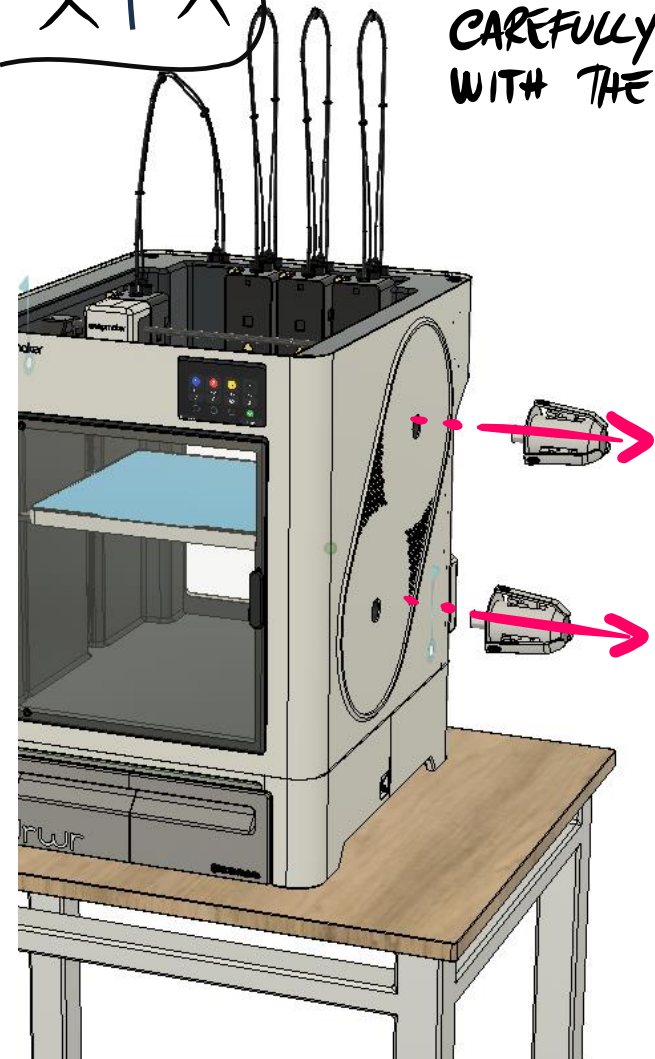

ALL MATERIAL PRODUCED AND PROVIDED HAS BEEN CONCEIVED, AUTHORED AND PRODUCED BY ENRICO MAZZAROL - ALL RIGHTS RESERVED.



DRYER BOX SUPPORT

SNAPMAKER U1 SPOOL BOX



LET'S ASSEMBLE THE DRY BOX SUPPORT.

INSERT THE SCREWS INTO THE HIGHLIGHTED HOLES AND SECURELY JOIN THE PARTS.

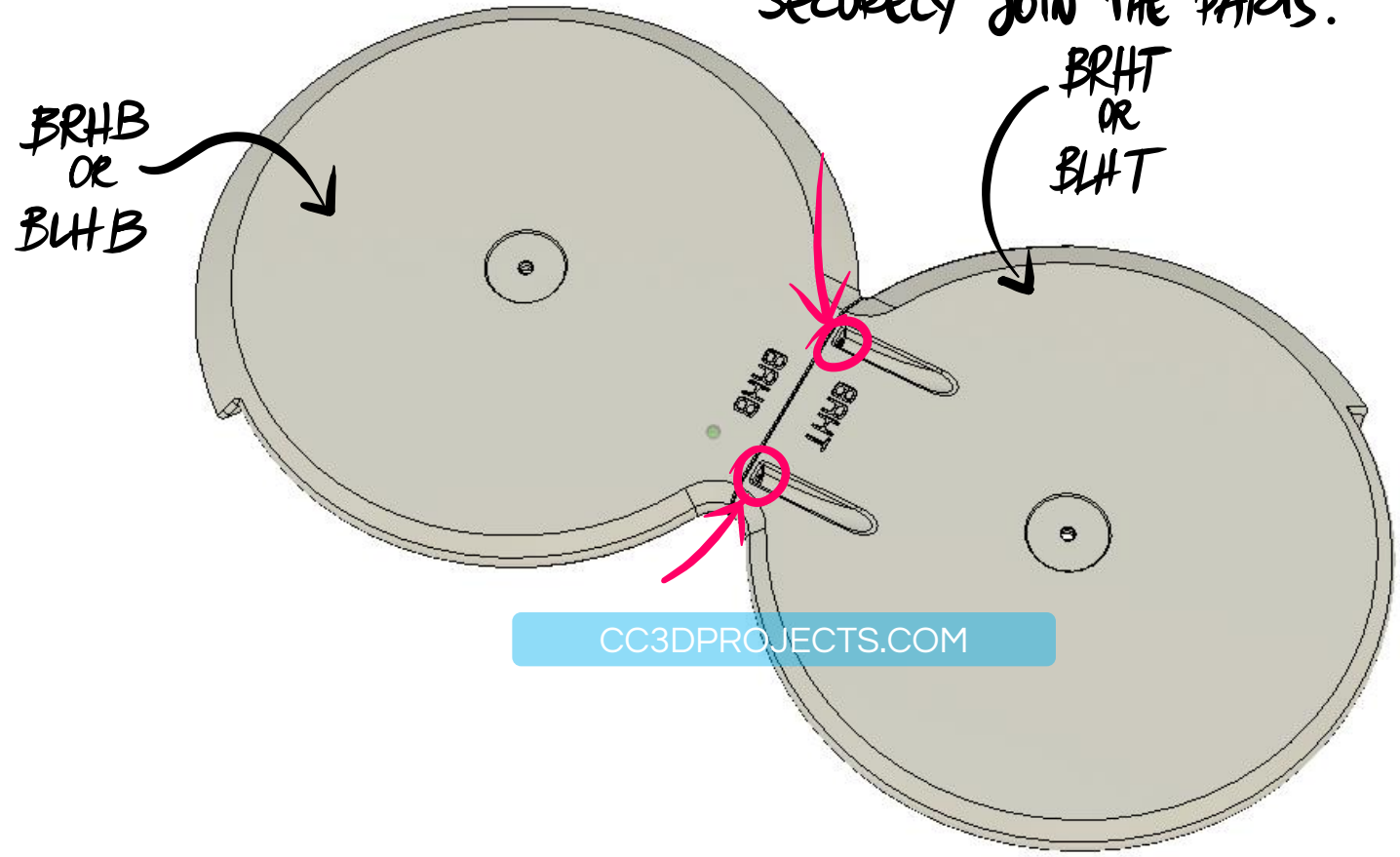

ALL MATERIAL PRODUCED AND PROVIDED HAS BEEN CONCEIVED, AUTHORED AND PRODUCED BY ENRICO MAZZAROL - ALL RIGHTS RESERVED.



DRY BOX INSTALLATION

SNAPMAKER U1 SPOOL BOX



LINE UP THE SUPPORT WITH THE HOLES AND GET READY TO DRIVE THE SCREWS INTO THE HOLES HIGHLIGHTED IN RED.

CC3DPROJECTS.COM

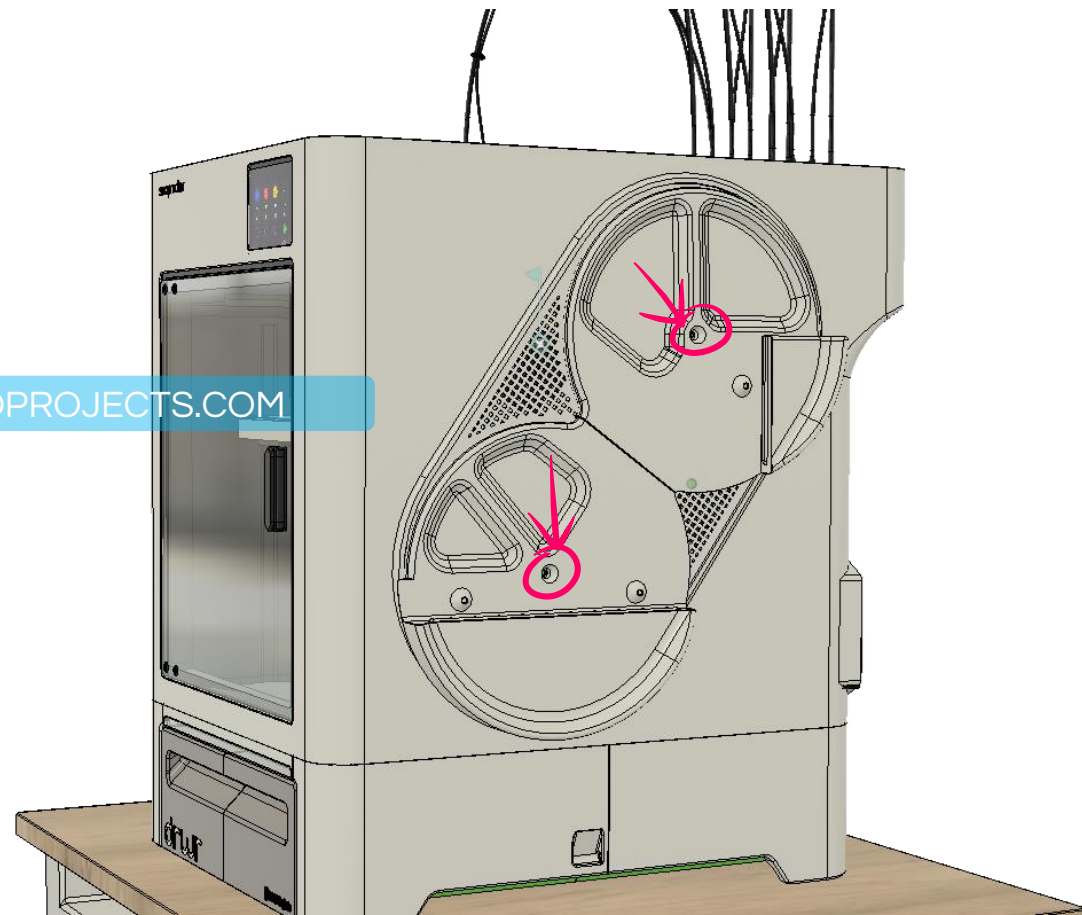
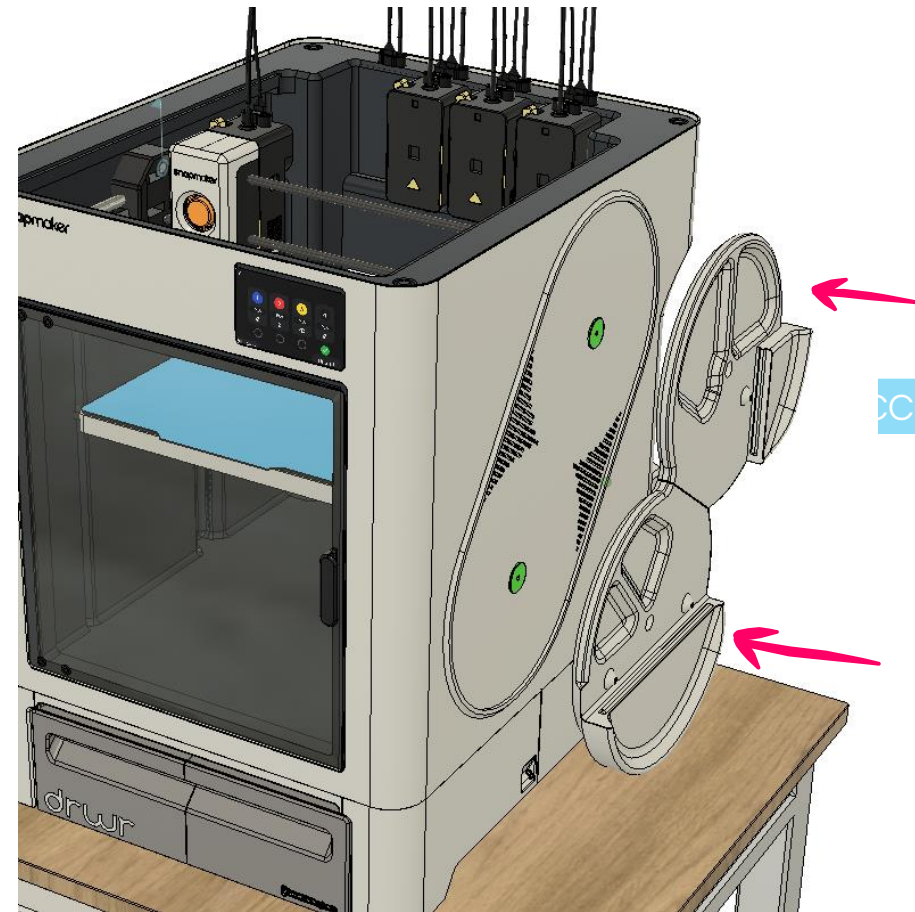

ALL MATERIAL PRODUCED AND PROVIDED HAS BEEN CONCEIVED, AUTHORED AND PRODUCED BY ENRICO MAZZAROL - ALL RIGHTS RESERVED.

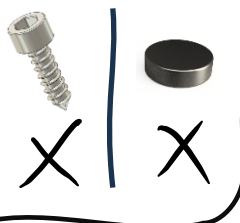

DRY BOX INSTALLATION

SNAPMAKER U1 SPOOL BOX



NOW SNAP IN THE BUILD PLATE HOLDER - JUST PRESS IT INTO PLACE.

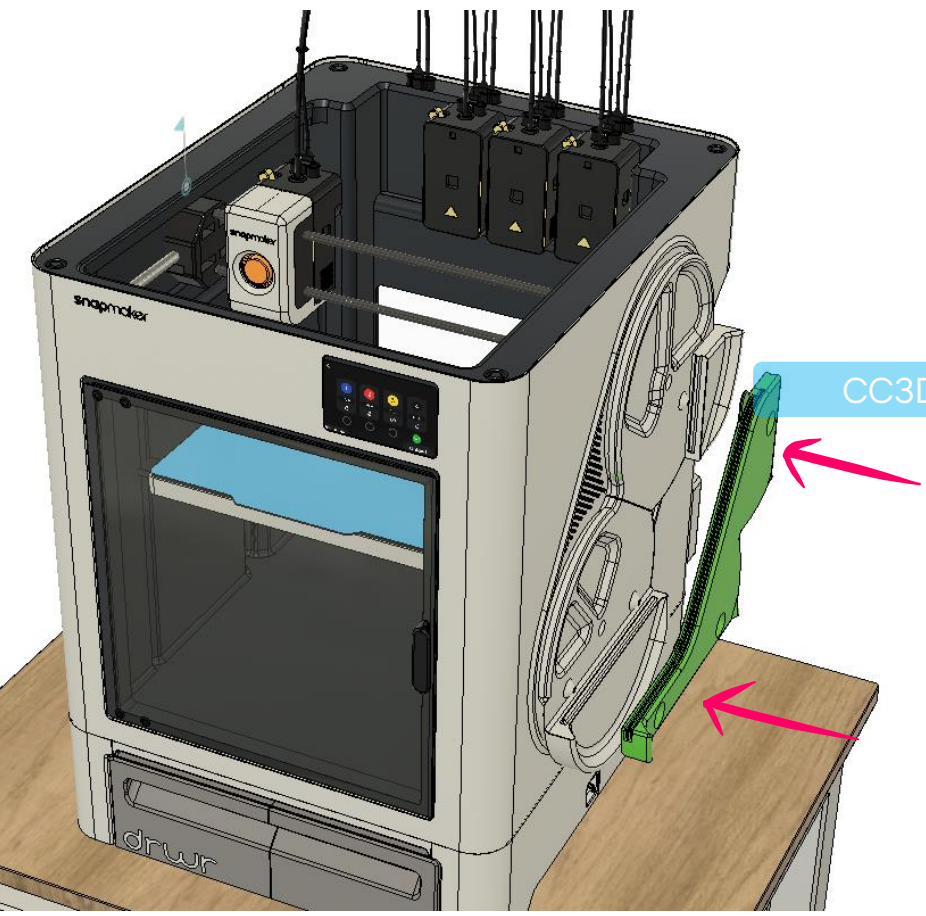

CC3DPROJECTS.COM



ALL MATERIAL PRODUCED AND PROVIDED HAS BEEN CONCEIVED, AUTHORED AND PRODUCED BY ENRICO MAZZAROL - ALL RIGHTS RESERVED.

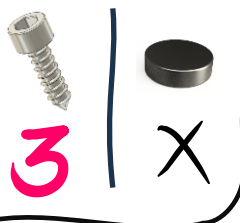

DRY BOX INSTALLATION

SNAPMAKER U1 SPOOL BOX



OPEN THE TOP LID AND BRING THE BOX UP TO ITS MOUNT.
THE CONICAL HOLES SHOULD HELP YOU LINE EVERYTHING UP - THEN INSERT THE TREE
SCREW INTO THE HIGHLIGHTED HOLES AND LOCK IT ALL IN PLACE!

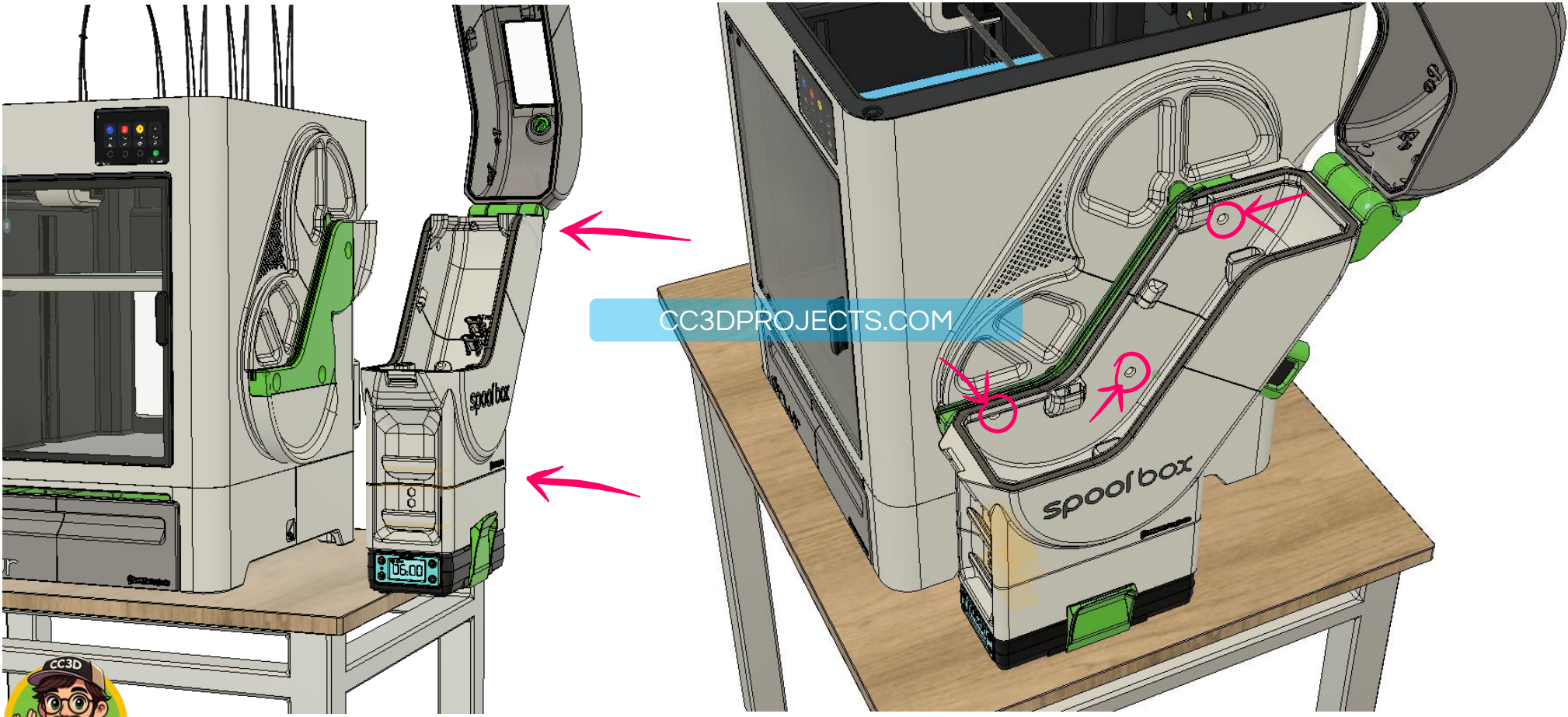

ALL MATERIAL PRODUCED AND PROVIDED HAS BEEN CONCEIVED, AUTHORED AND PRODUCED BY ENRICO MAZZAROLI - ALL RIGHTS RESERVED.



DRY BOX INSTALLATION

SNAPMAKER U1 SPOOL BOX



LET'S GET THE FILAMENT FEEDER ON THE BOX.
SNAP THE FEEDER INTO THE MOUNT LIKE YOU SEE IN THE PICTURE,
THEN BRING THE WHOLE THING UP TO THE BOX AND SECURE IT WITH SCREWS
IN THE MARKED HOLES.

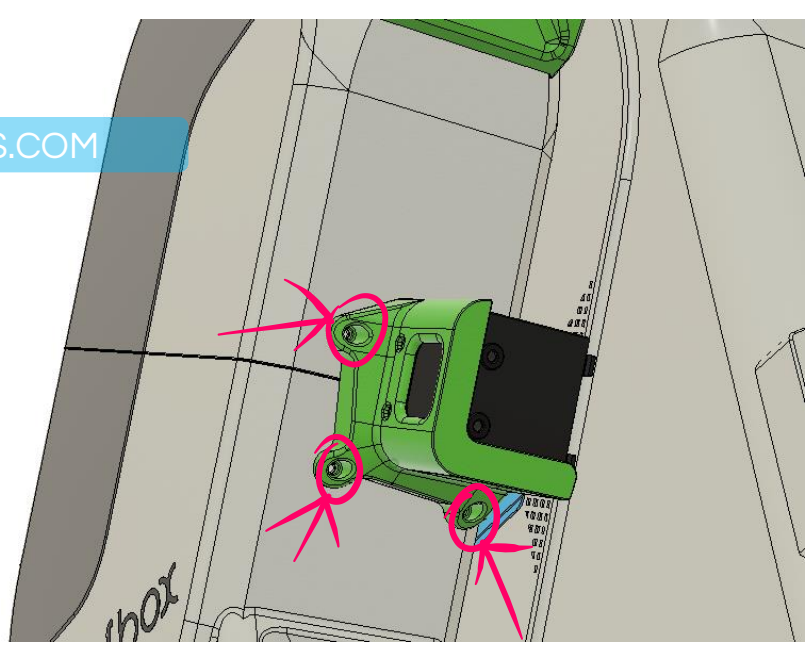
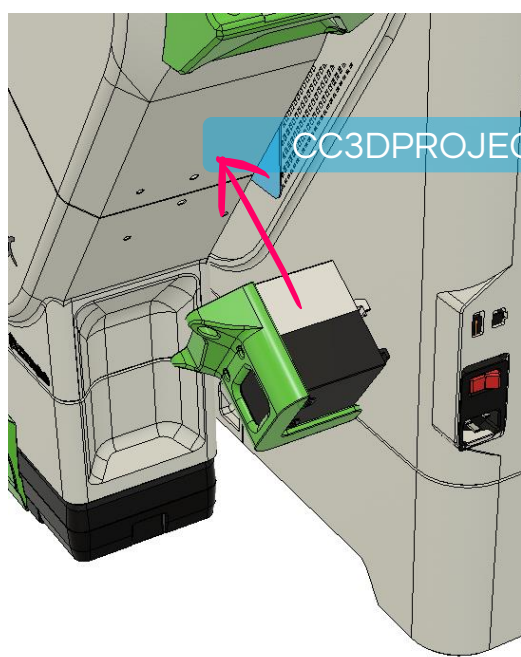
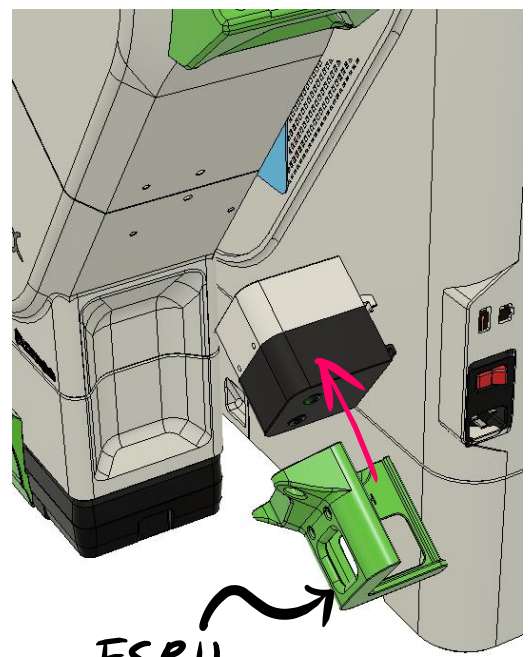

FSRH
OR
FSLH



THE FEEDER CABLE LENGTH IS JUST RIGHT -
NO NEED TO EXTEND IT!!

ALL MATERIAL PRODUCED AND PROVIDED HAS BEEN CONCEIVED, AUTHORED AND PRODUCED BY ENRICO MAZZAROL - ALL RIGHTS RESERVED.

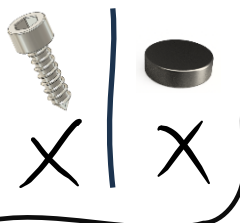

DRY BOX INSTALLATION

FILL THE SILICA GEL BOX TO THE RECOMMENDED LEVEL, THEN INSERT IT INTO ITS SLOT IN THE BASE.

SNAPMAKER U1 SPOOL BOX

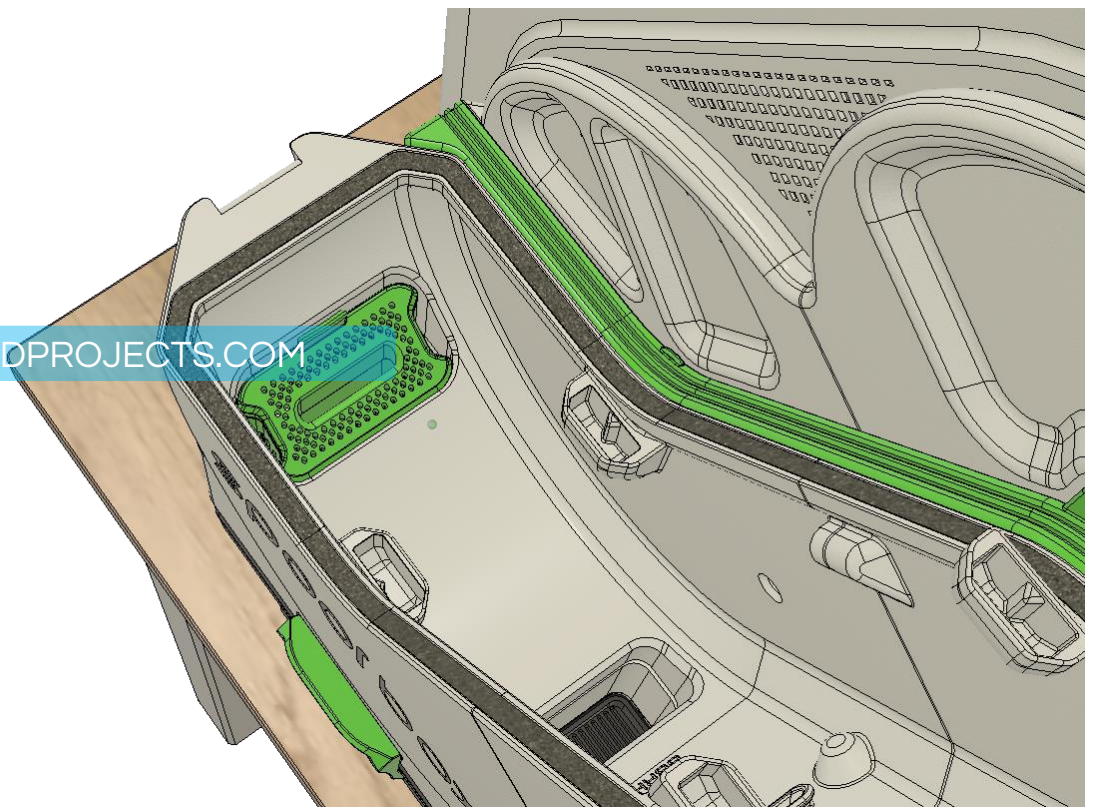
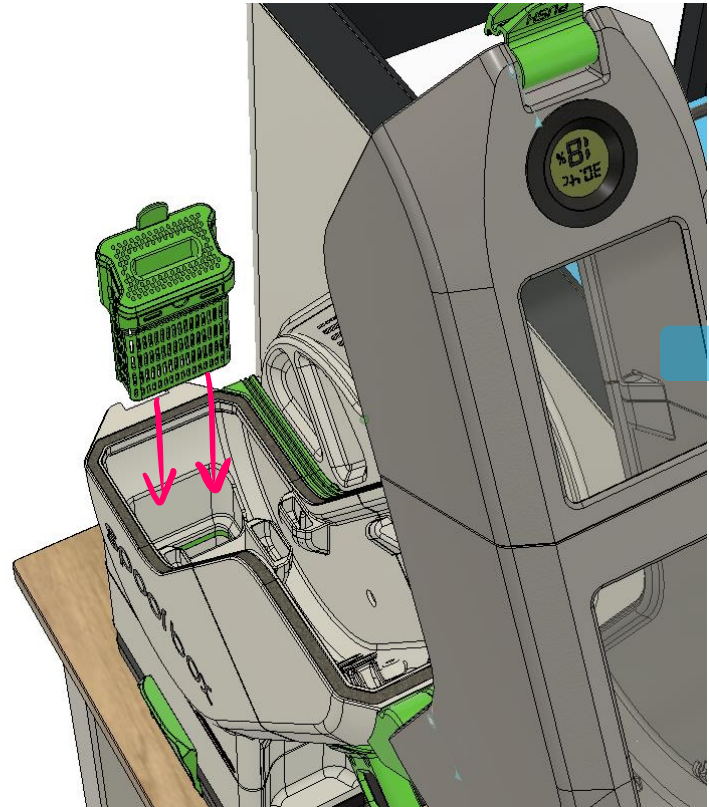

CC3DPROJECTS.COM



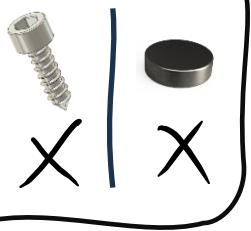

DRY BOX INSTALLATION

SNAPMAKER U1 SPOOL BOX



THE SPOOL SUPPORTS GO IN LIKE THIS: FIRST INSERT THE SUPPORT INTO THE SPOOL HOLE, THEN SNAP THE WHOLE THING INTO THE BOX.

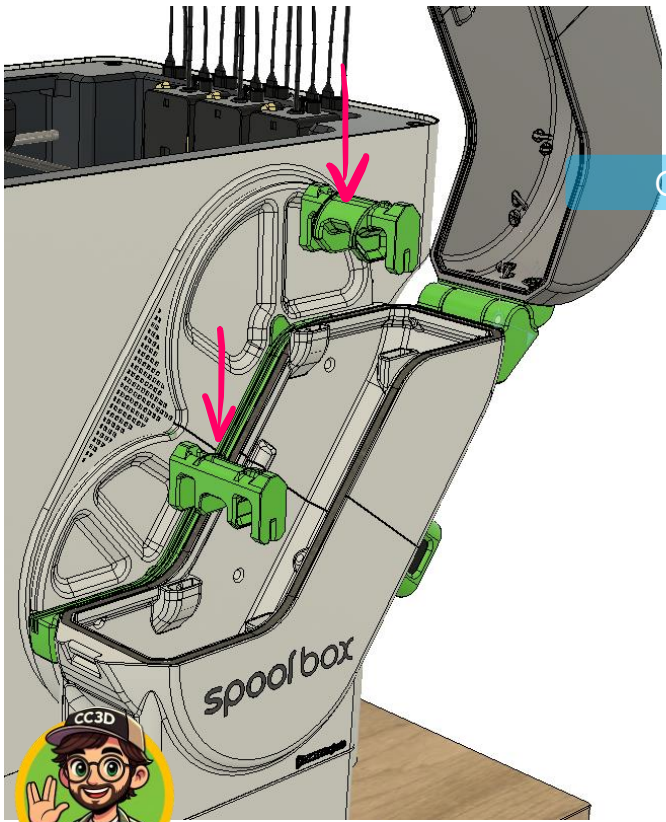

CC3DPROJECTS.COM

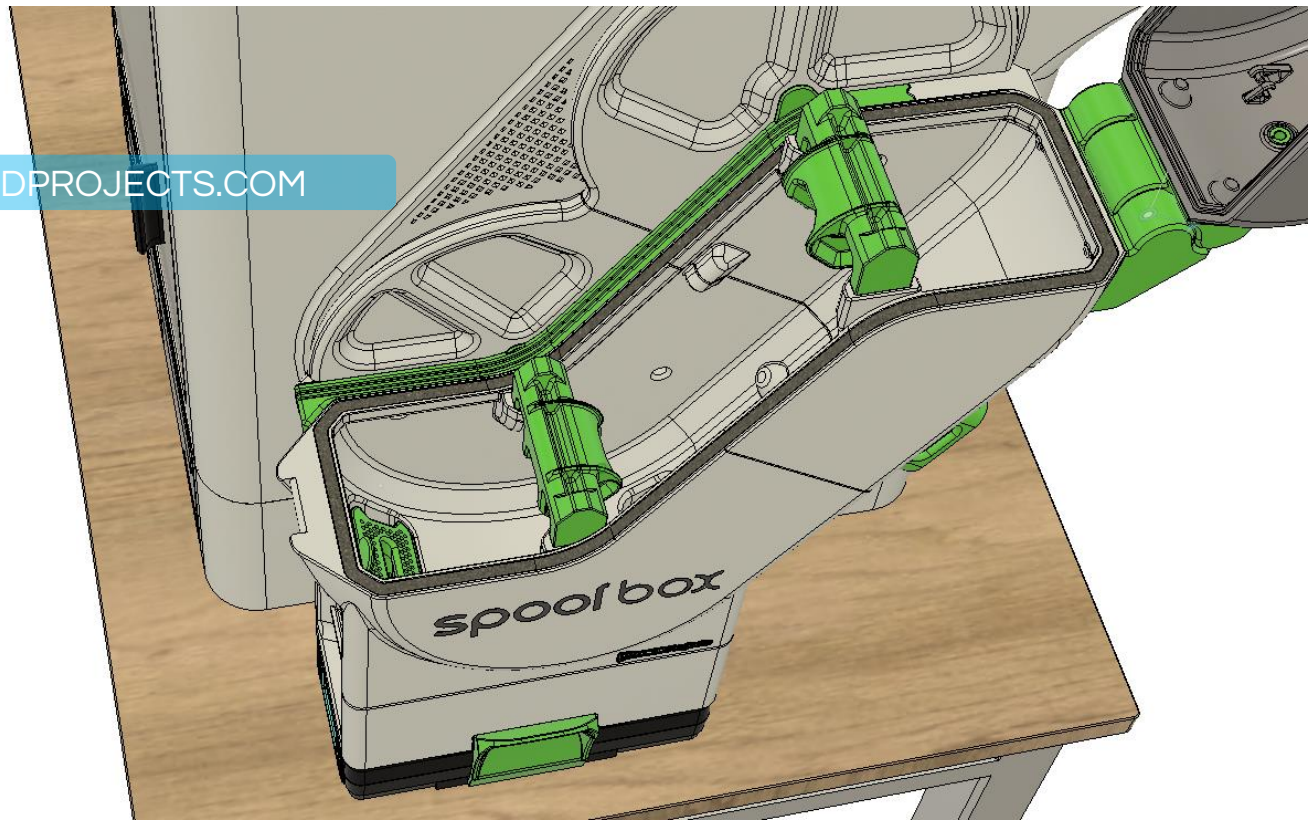

ALL MATERIAL PRODUCED AND PROVIDED HAS BEEN CONCEIVED, AUTHORED AND PRODUCED BY ENRICO MAZZAROL - ALL RIGHTS RESERVED.

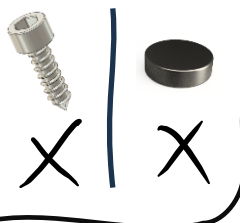

DRY BOX INSTALLATION

SNAPMAKER U1 SPOOL BOX



FEED THE FILAMENT IN LIKE THIS, AND TO IDENTIFY THE HEAD NUMBER, CHECK THE NUMBER INSIDE THE BOX.

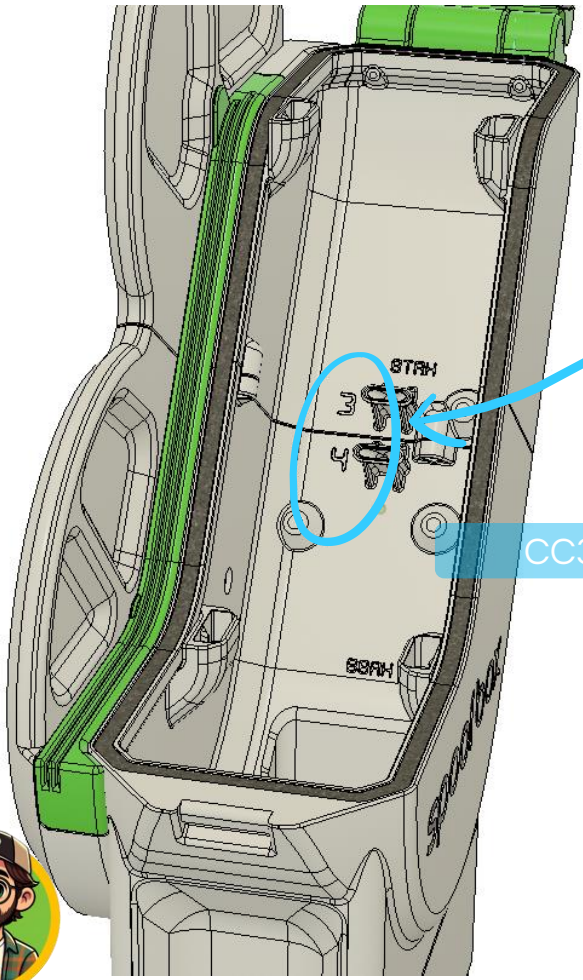

CC3DPROJECTS.COM

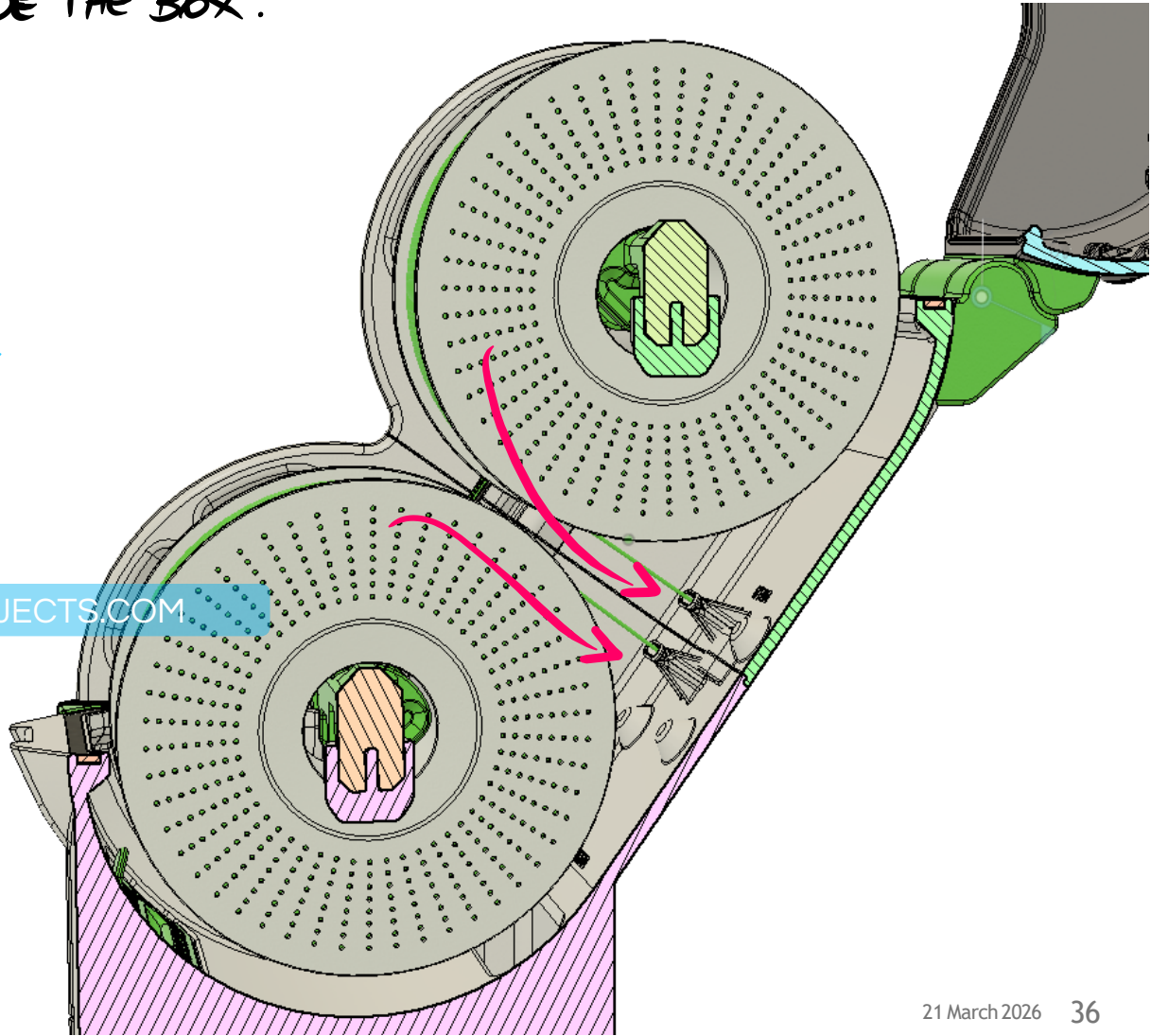

ALL MATERIAL PRODUCED AND PROVIDED HAS BEEN CONCEIVED, AUTHORED AND PRODUCED BY ENRICO MAZZAROL - ALL RIGHTS RESERVED.

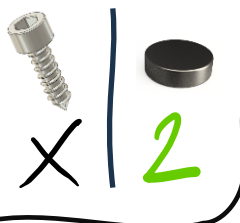

DRY BOX INSTALLATION

SNAPMAKER V1 SPOOL BOX



LET'S INSTALL THE MAGNET ON THE BOX



TO INSTALL THOSE MAGNETS USE THE MAGNET INSTALLER "B".

YOU'LL FIND THE INSTALLERS FOR FREE ON MY SHOP

CC3DPROJECTS.COM



ALL MATERIAL PRODUCED AND PROVIDED HAS BEEN CONCEIVED, AUTHORED AND PRODUCED BY ENRICO MAZZAROL - ALL RIGHTS RESERVED.

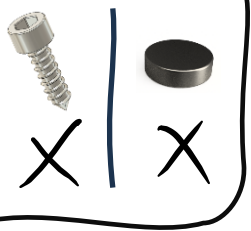

DRY BOX INSTALLATION

SNAPMAKER U1 SPOOL BOX



SET THE BOX IN PLACE
AND LET IT SLIDE DOWN

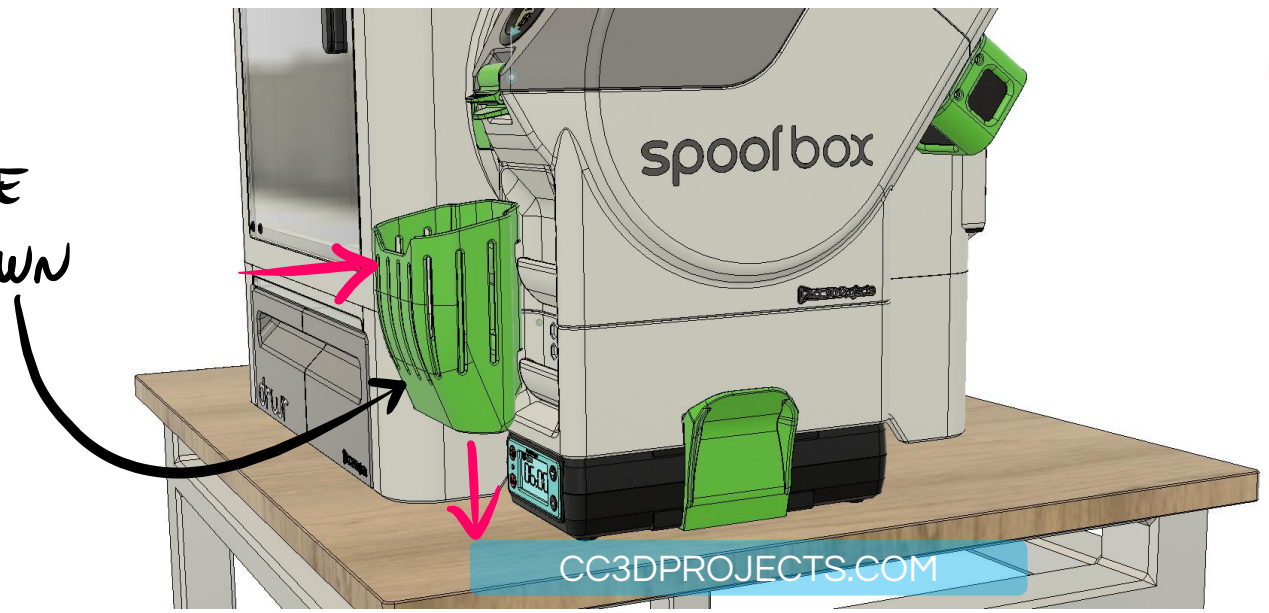

THE MAGNETS WILL HOLD
IT IN PLACE!

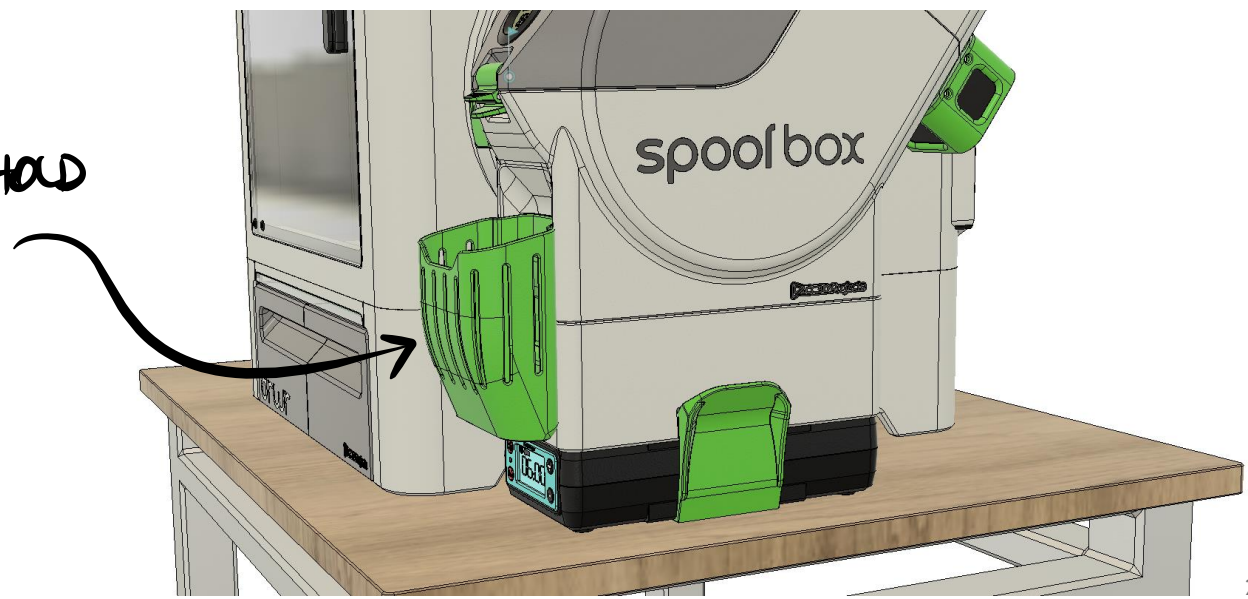

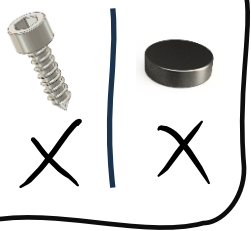

DRY BOX INSTALLATION

SNAPMAKER U1 SPOOL BOX



DONE!

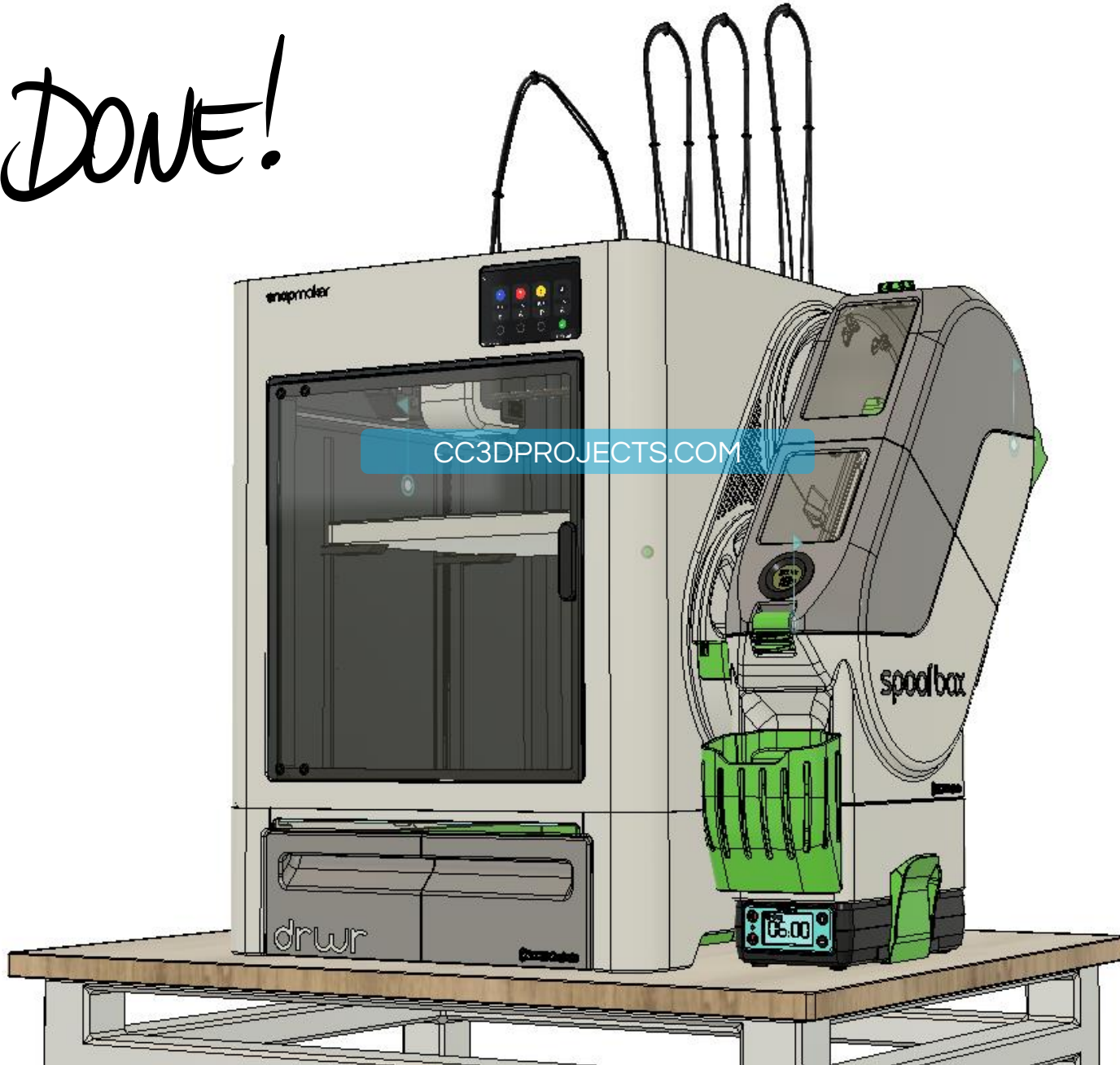

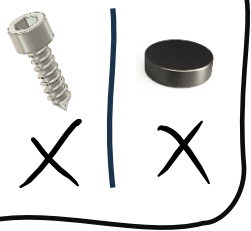

DRY BOX INSTALLATION

SNAPMAKER U1 SPOOL BOX



ALL THAT'S LEFT NOW IS TO SLIDE THE BUILD PLATES. YOU'LL SEE SOME CHANNELS IN THE GREEN AREA BETWEEN THE BOX AND ITS SUPPORT - USE THOSE.

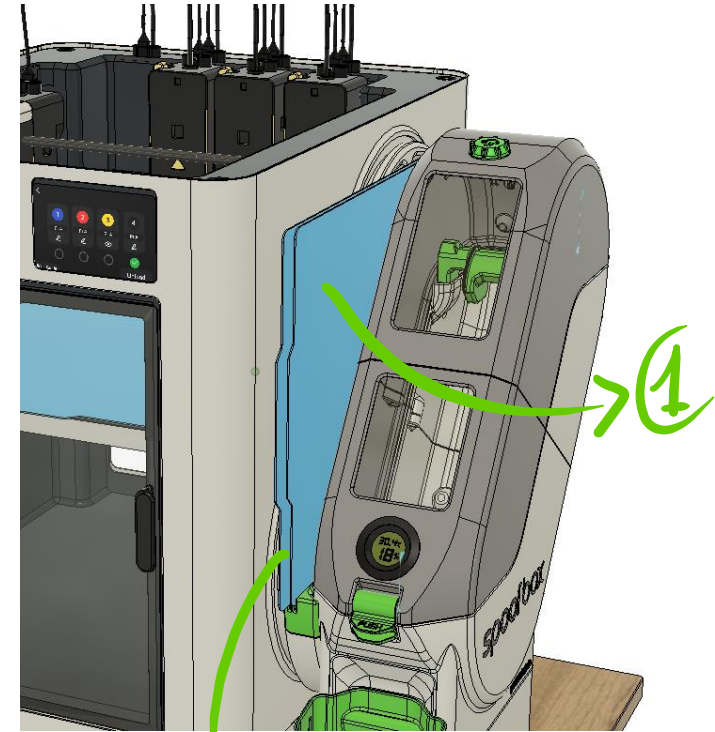
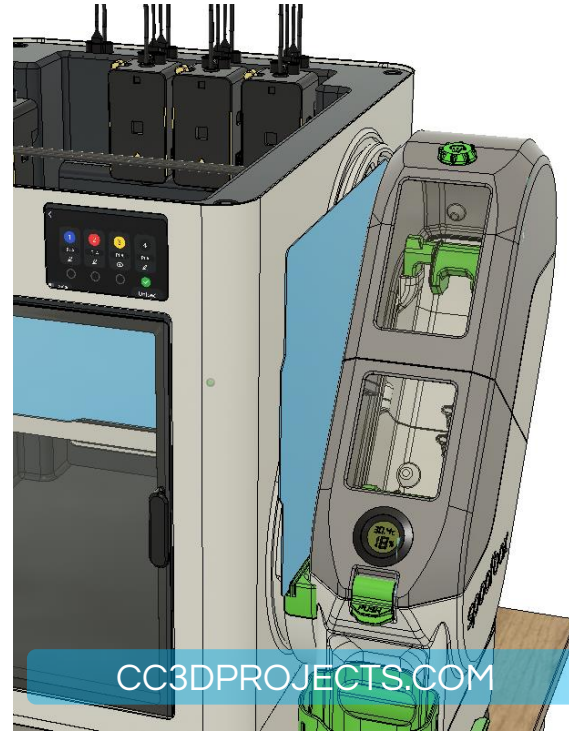
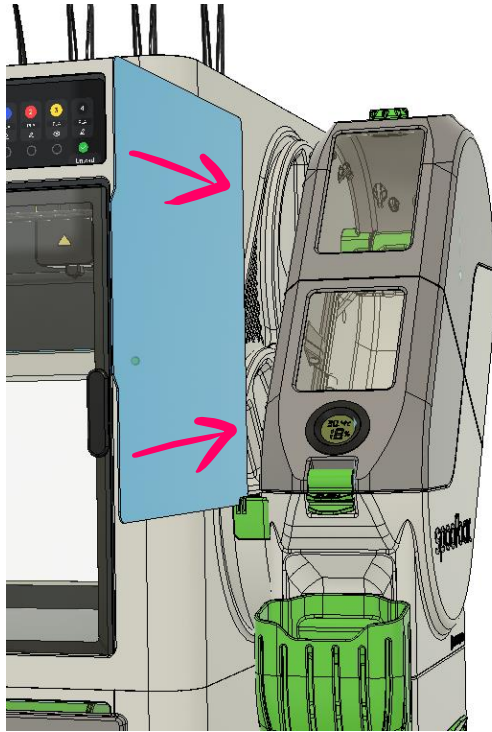

ALL MATERIAL PRODUCED AND PROVIDED HAS BEEN CONCEIVED, AUTHORED AND PRODUCED BY ENRICO MAZZAROLI - ALL RIGHTS RESERVED.

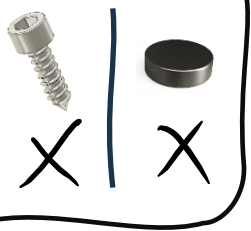

DRY BOX INSTALLATION

SNAPMAKER U1 SPOOL BOX



ALRIGHT, YOU SHOULD END UP WITH SOMETHING LIKE THIS - MAYBE YOU ALREADY REPEATED THE SAME PROCESS FOR THE LEFT BOX TOO.



ONE DRY BOX
LEFT OR RIGHT



TWO DRY BOXES
+
DRAWER



TWO DRY BOXES
+
DRAWER
+
HDRY SYSTEM



ALRIGHT, LOOK LIKE YOU MADE IT TO THE END!
BUUUUT, IF YOUR RESULT DOESN'T LOOKS KINDA LIKE THIS...
... MY FRIEND ...

WHAT ARE YOU DOING WITH YOUR LIFE? 😊
SERIOUSLY THOUGH...

JUST HIT ME UP, WE'LL FIGURE OUT
WHAT WENT WRONG!!

BUT

IF YOU ARE PROUD OF WHAT YOU BUILD
(AND YOU SHOULD BE) ...

... WELL ...

... HOW ABOUT SNAPPING A COUPLE
OF PICS AND TOSSING THEM ONLINE?

MAYBE TAGGING ME?

#CC3DPROJECTS

THANKS
Ewido

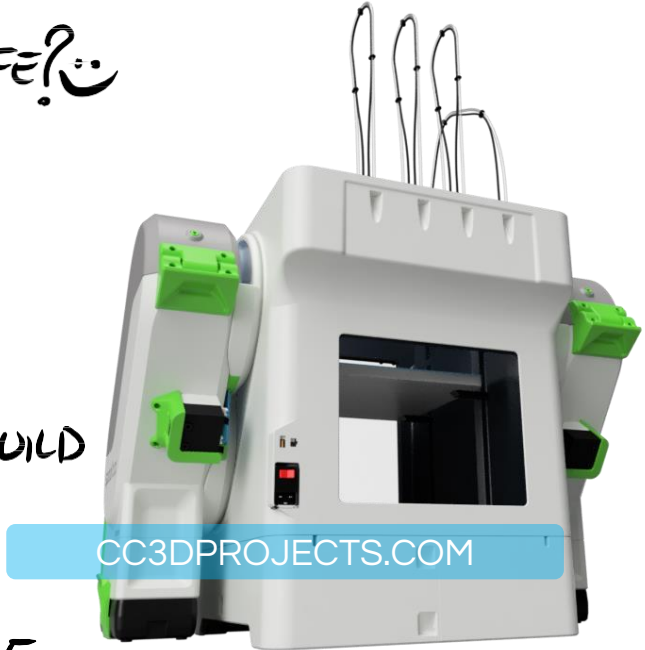

CC3DPROJECTS.COM

CC3DPROJECTS.COM



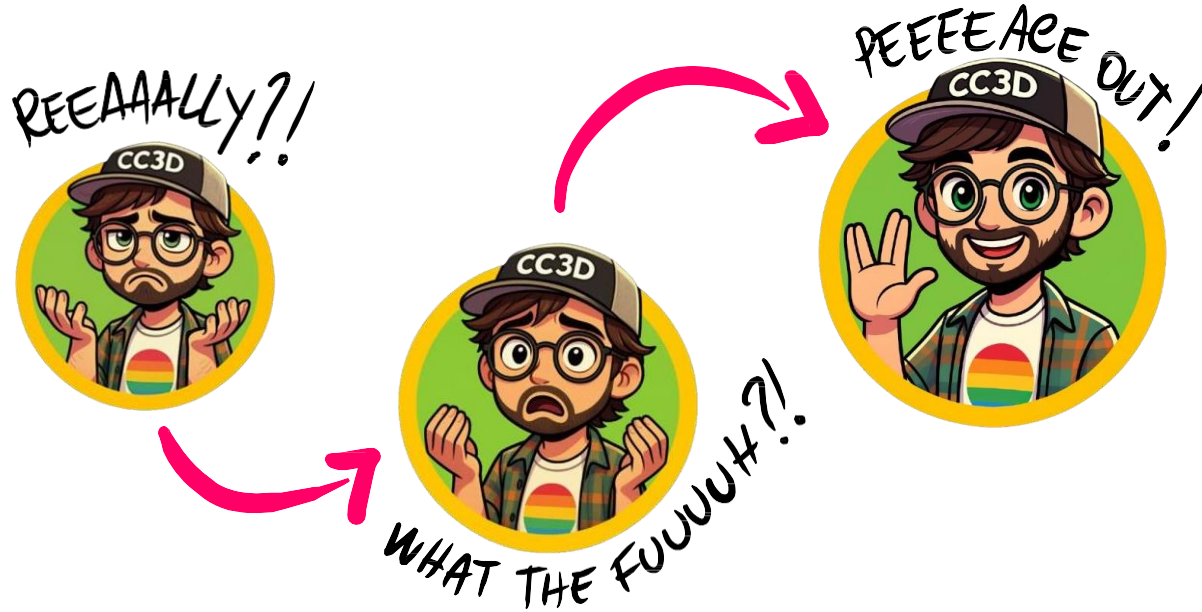

THANKS FOR STICKING WITH ME THROUGH THIS ASSEMBLY GUIDE
IT TOOK ME HOURS TO PUT THIS GUIDE TOGETHER, I TRULY HOPE YOU LIKE IT!
IF THERE'S ANYTHING I CAN DO BETTER, PLEASE LET ME KNOW!
I'M ALWAYS HERE TO HELP AND IMPROVE MY WORK AND MY MODELS!

CIAO
Enrico





CC3DPROJECTS.COM



© 2026 CC3DPROJECTS. ALL RIGHTS RESERVED.

THIS PRODUCT, INCLUDING ALL ASSOCIATED FILES AND MATERIALS (SUCH AS BUT NOT LIMITED TO DESIGNS, 3D MODELS, SCHEMATICS, INSTRUCTIONS, AND IMAGES), IS PROTECTED BY COPYRIGHT AND INTELLECTUAL PROPERTY LAWS.

ALL CONTENT IS THE EXCLUSIVE PROPERTY OF CC3DPROJECTS / ENRICO MAZZAROL AND MAY NOT BE COPIED, REPRODUCED, DISTRIBUTED, MODIFIED, SHARED, RESOLD, OR USED FOR COMMERCIAL PURPOSES, IN WHOLE OR IN PART, WITHOUT PRIOR WRITTEN PERMISSION.

UNAUTHORIZED USE, DISTRIBUTION, OR REPRODUCTION OF THIS MATERIAL WILL BE PURSUED TO THE FULLEST EXTENT PERMITTED BY LAW.

BY ACCESSING OR USING THESE FILES, YOU AGREE TO RESPECT THESE TERMS AND ACKNOWLEDGE THE CREATOR'S RIGHTS.

